

Job Name: 26-1941 ADS Williams Mill  
 Job Location: Antiock, TN  
 Contractor: ADS Advanced Drainage Systems, Inc.

Plant: Beaver Dam  
 4/20/2026 9:49:56 AM

Tech: S. Felletter  
 PC: C. Goff



**Structure ID: K1B**

**P5 MH096LD17-CON**

**MH FLAT TOP w/ 24" Conc. Hole F/G**

- P6) 24" - CASTING HEIGHT - 7"
- P5) 96" - MH FLAT TOP w/ 24" Conc. Hole F/G - 17"
- P4) 96" - MH RISER NO STEPS T/G - 36"
- P3) 96" - MH RISER NO STEPS T/G - 96"
- P2) 96" - MH RISER NO STEPS T/G - 84"
- P1) 96" - MH BASE T/n - 24"
- 1) JOINT WRAP - 0.065"x6"x50' CONSEAL CS212
- 1) JOINT WRAP PRIMER - CONSEAL CS-75 (1 gal.)
- 1) ASSEMBLY REQUIRED - BRACKETS ONLY
- 1) CASTING - HOE MC-375 F/C Storm
- 4) 96" - Conseal CS-102 1.00"
- 2) Hole - 26

0 lb  
 10473 lb  
 8968 lb  
 23002 lb  
 20926 lb  
 12831 lb  
 0 lb  
 0 lb  
 0 lb  
 271 lb  
 0 lb  
 0 lb  
 -----  
 Structure Total: 76471 lb

- Structure Notes:**
1. PER ASTM C478 SPECIFICATIONS.
  2. CONCRETE = 4,000 PSI AT 28 DAYS.
  3. CASTING BY ICAST (HOE MC-375 F/C "STORM").
- REINFORCING PER ASTM A615 (GRADE 60).**
- TOP SLAB (As .62) #5 BARS AT 6" C.C.E.W.
  - RISER/WALLS (As .24)
  - FLOOR (As .47) #5 BARS AT 8" C.C.E.W.

GENERAL NOTES:

1. MANUFACTURED TO ASTM C-478 (LATEST REVISION).
2. CONCRETE 5,000 PSI AT 28 DAYS.
3. WEIGHT: 10,473 LBS.
4. REINFORCING: TOP MAT: #4 BAR @ 18" C/C E.W.  
 BOTTOM MAT: #5 BAR @ 12" C/C E.W.  
 PER ASTM A615 (GRADE 60)

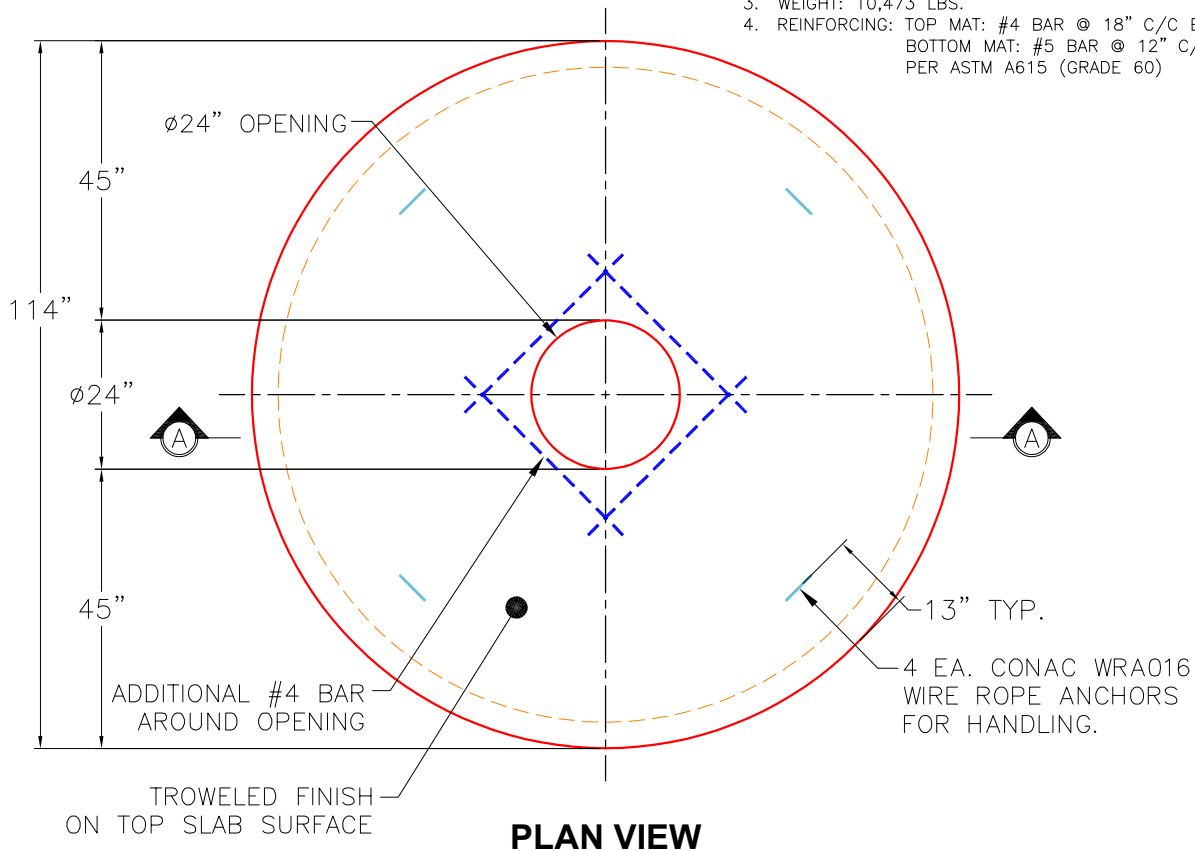

**PLAN VIEW**

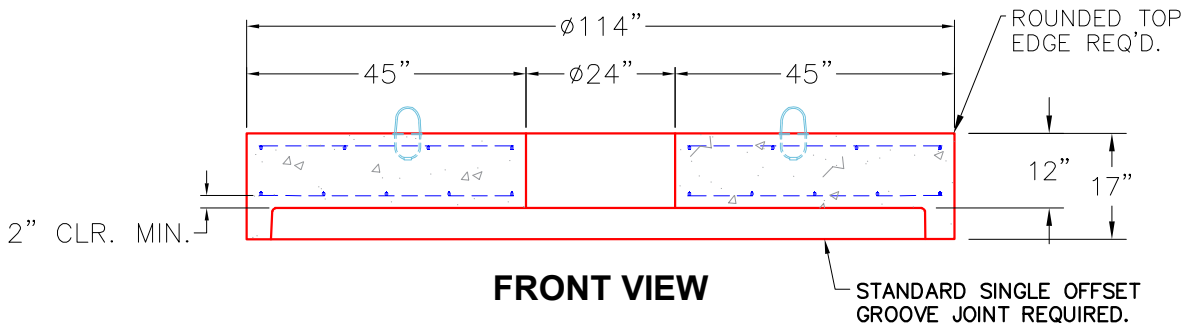

**FRONT VIEW**

Coating (Int):  
 Coating (Ext):

Seam Up: Flat  
 Seam Dn: Groove

Wall Thickness: 9"

Height (Ext): 17"

Weight (Net): 10473 lb  
 Volume (Net): 2.68cu.yd