

NOTES:

1. BOX CULVERT IS DESIGNED PER SECTION 605 OF THE KYTC STANDARD SPECIFICATIONS FOR ROAD & BRIDGE CONSTRUCTION.
2. LOAD REQUIREMENTS = KY-HL93 (KY TABLE 1).
3. COVER DEPTH = 0' TO 2'.
4. CONCRETE: 5,000 PSI AT 28 DAYS.
5. JOINT SEALANT = 1" BUTYL MASTIC (CS 102).
6. EXTERIOR JOINT WRAP = 12" WIDE CS212.
7. REINFORCING PER ASTM C1577 (GRADE 60).
8. WEIGHT = 8'x6' RCBC = 3,128 LBS/L.FT
 5.75' LONG SECTION = 17,984 LBS (TYPICAL)
 6.92' LONG SECTION = 21,646 LBS (PC. 01)

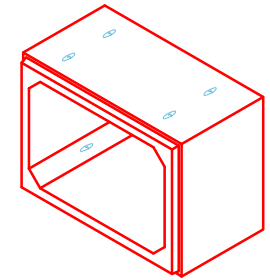

COMPONENT ISOMETRIC VIEW

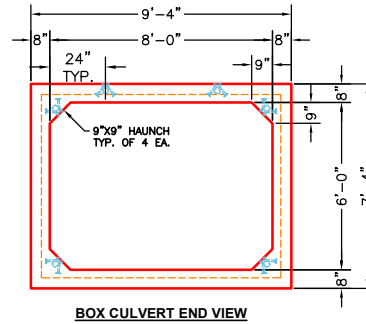
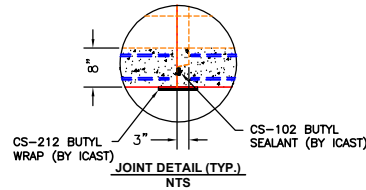
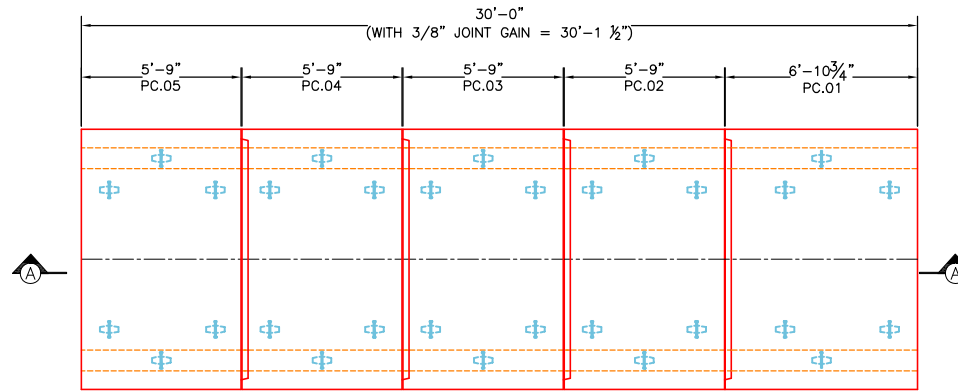

PLAN VIEW

FLOW →

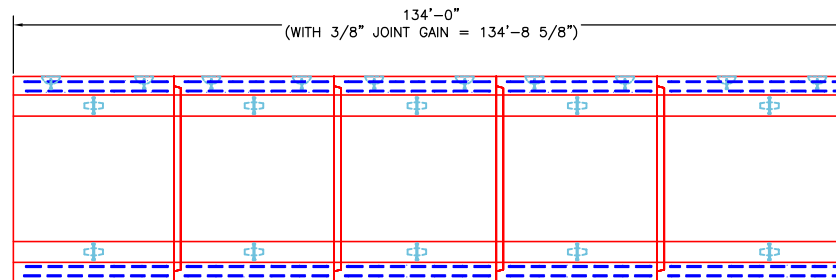

SECTION A-A

REVISION INFORMATION

REV. Δ DATE: NO REVISIONS TO DATE



SUBMITTAL DRAWING: 8' SPAN X 6' RISE BOX CULVERT

CUSTOMER: WINWATER HARTFORD KY CO

PROJECT: WINWATER CULVERT

STRUCTURE: BC 8X6

QUOTE/SALES ORDER NO: 26-1919

PC: CELINA GOFF

DRAWN BY: J. HORSLEY

DATE: 04/8/26

SCALE: NTS

PG. 1 of 1