

Job Name: 26-1882 - Fork River Commons  
 Job Location: Millington, TN  
 Contractor: Woods Constructions Services, Inc.

Plant: 100  
 4/30/2026 12:37:39 PM

Tech: Jared - A  
 PC: T. Lewis



**Structure ID: MH-1 ST-MH**

**P4 GR4**

**GRADE RING F/F**

- P5) 24" - CASTING HEIGHT - 7"
- P4) 24" - GRADE RING F/F - 4"
- P3) 48" - ECC CONE w/ 24" HOLE F/G - 30"
- P2) 48" - MH RISER T/G - 60"
- P1) 48" - MH BASE (08"F) T/n - 36"
- 1) CASTING - JBS 1020 F/C DRAIN
- 2) 48" - Conseal CS-102 1.00"
- 2) Hole - 30
- 11) MH Step ML-10-TDS-NCR - 10"

0 lb  
 270 lb  
 2050 lb  
 4192 lb  
 3656 lb  
 250 lb  
 0 lb  
 0 lb  
 0 lb  
 -----  
 Structure Total: 10418 lb

- Structure Notes:
1. PER ASTM C-478 SPECIFICATIONS
  2. CONCRETE: 4,000 PSI AT 28 DAYS
  3. REINFORCEMENT: (1) #3 HOOP CENTERED (GRADE 60)

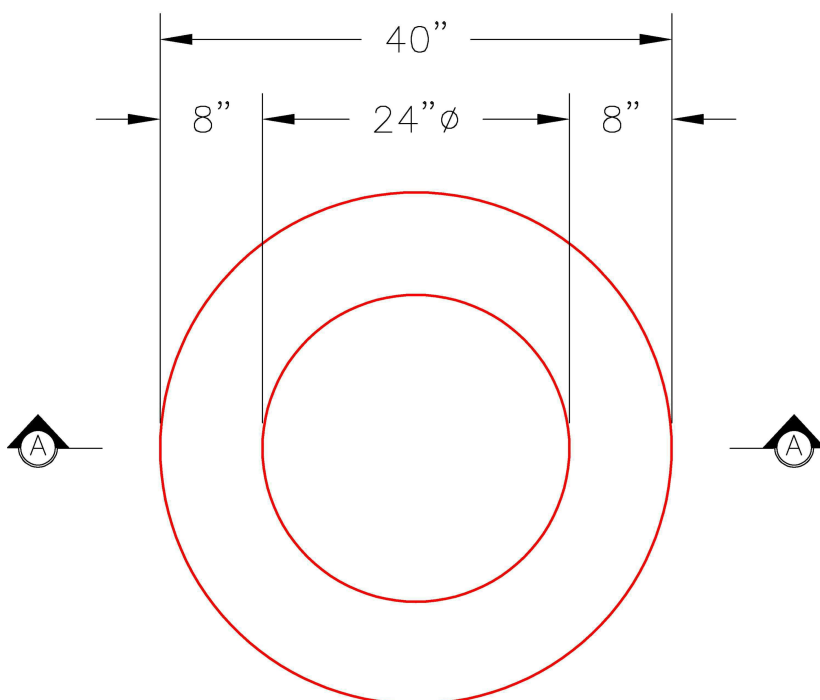

**PLAN VIEW**

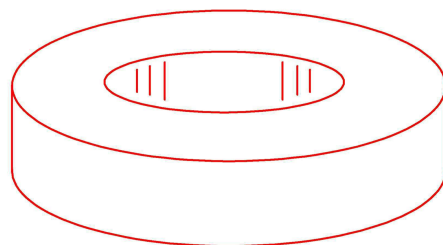

**ISOMETRIC VIEW**

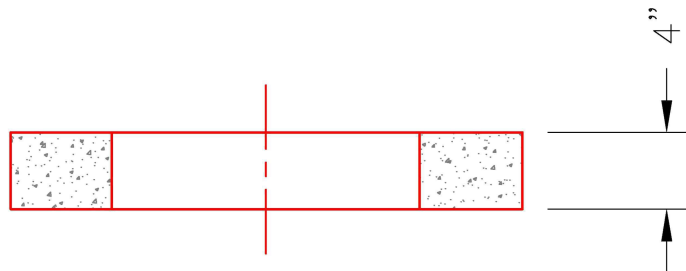

**SECTION A-A**

Coating (Int):  
 Coating (Ext):

Seam Up: Flat  
 Seam Dn: Flat

Wall Thickness: 8"

Height (Ext): 4"

Weight (Net): 270 lb  
 Volume (Net): 0.07cu.yd