

Job Name: 26-1789 - Tractor Supply Drainage Repairs
 Job Location: Woodbury, TN
 Contractor: Hayes Pipe Supply

Plant: 100
 4/10/2026 8:02:09 PM

Tech: Jared - F
 PC: E. Bradley



Structure ID: JB1 ST-JB

P1 BX036096-08W08F-BAVF

BOX BASE 8inW, 8inF, Variable Ht F/n

- P3) 24" - CASTING HEIGHT - 7"
- P2) 36" x 96" - BX FLAT LID 8inW w/24" HOLE F/F - 8"
- P1) 36" x 96" - BOX BASE 8inW, 8inF, Variable Ht F/n - 80"
- 1) 36" x 96" - Conseal CS-102 1.00"
- 2) Hole - 40 x 28
- 1) Hole - 46
- 6) MH Step ML-10-TDS-NCR - 10"

0 lb
 3606 lb
 17509 lb
 0 lb
 0 lb
 0 lb
 0 lb
 Structure Total: 21115 lb

Structure Notes:

1. PER ASTM C913 SPECIFICATIONS.
2. CONCRETE = 4,000 PSI AT 28 DAYS.
3. NO INVERT CHANNEL.
4. CASTING SUPPLIED BY OTHERS (JBS 1150 F/C STORM).

REINFORCING PER ASTM A615 (GRADE 60).
 - TOP SLAB (As .62) #5 BARS AT 6" C.C.E.W.
 - WALLS (As .12) #5 BARS AT 12" C.C.E.W.
 - FLOOR (As .12) #5 BARS AT 12" C.C.E.W.

Rim: 690.2' Rim to Invert: 7.95' Slack: 0.4" Sump: 0" Step Position: 180

Position	Elev	Angle	Ext. (cw)	Pipe	Pipe OD	Connector	Hole	Horz Size	Up ()	Offset
Invert 1	682.25'	90°	80"	30" x 19" ELL RCP	37.25" x 26.25"	Hole 40 x 28	40" x 28"	40"	-4.5"	24"
Invert 2	682.25'	90°	32"	30" x 19" ELL RCP	37.25" x 26.25"	Hole 40 x 28	40" x 28"	40"	-4.5"	-24"
Invert 3	683.75'	270°	56"	36" RCP B WALL	44"	Hole 46	46"	46"	13"	0"
Invert 4										
Invert 5										
Invert 6										
Invert 7										
Invert 8										

RIGHT-SIDE UP VIEW (int. dimensions)

UPSIDE-DOWN VIEW (int. dimensions)

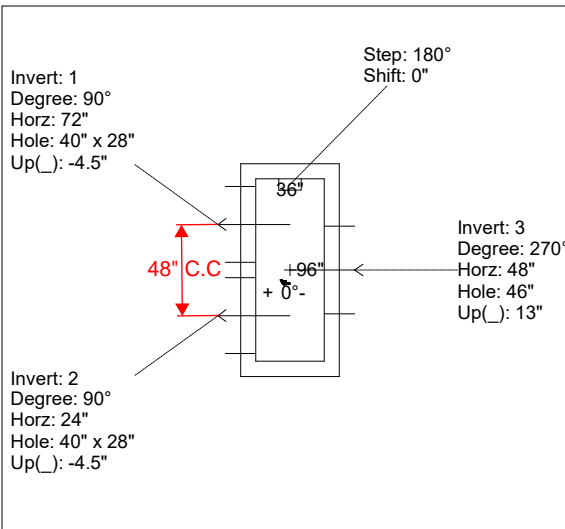

**1ST POUR (FLOOR) = 3,909 LBS
 2ND POUR (WALLS) = 13,600 LBS**

INSIDE WALL DIMENSIONS

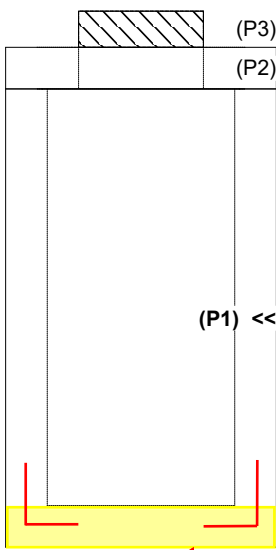
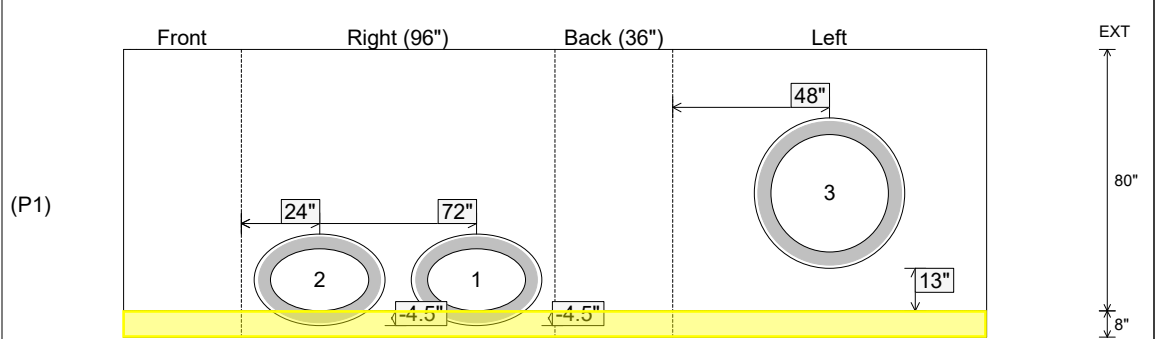

**1ST POUR (FLOOR)
 STUB #5 L BARS OUT TOP
 FLOOR, SPA AT
 12" C/C FOR
 CONNECTING WALLS**

Coating (Int):
 Coating (Ext):

Seam Up: Flat
 Seam Dn: n/a

Wall Thickness: 8"
 Floor Height: 8"

Height (Int): 80"
 Height (Ext): 88"

Weight (Net): 17509 lb
 Volume (Net): 4.47cu.yd

Job Name: 26-1789 - Tractor Supply Drainage Repairs
 Job Location: Woodbury, TN
 Contractor: Hayes Pipe Supply

Plant: 100
 4/10/2026 8:02:09 PM

Tech: Jared - F
 PC: E. Bradley



Structure ID: JB1 ST-JB

P1 BX036096-08W08F-BAVF

BOX BASE 8inW, 8inF, Variable Ht F/n

- P3) 24" - CASTING HEIGHT - 7"
- P2) 36" x 96" - BX FLAT LID 8inW w/24" HOLE F/F - 8"
- P1) 36" x 96" - BOX BASE 8inW, 8inF, Variable Ht F/n - 80"
- 1) 36" x 96" - Conseal CS-102 1.00"
- 2) Hole - 40 x 28
- 1) Hole - 46
- 6) MH Step ML-10-TDS-NCR - 10"

0 lb
 3606 lb
 17509 lb
 0 lb
 0 lb
 0 lb
 0 lb
 Structure Total: 21115 lb

Structure Notes:

1. PER ASTM C913 SPECIFICATIONS.
2. CONCRETE = 4,000 PSI AT 28 DAYS.
3. NO INVERT CHANNEL.
4. CASTING SUPPLIED BY OTHERS (JBS 1150 F/C STORM).

REINFORCING PER ASTM A615 (GRADE 60).
 - TOP SLAB (As .62) #5 BARS AT 6" C.C.E.W.
 - WALLS (As .12) #5 BARS AT 12" C.C.E.W.
 - FLOOR (As .12) #5 BARS AT 12" C.C.E.W.

Rim: 690.2' Rim to Invert: 7.95' Slack: 0.4" Sump: 0" Step Position: 180

Position	Elev	Angle	Ext. (cw)	Pipe	Pipe OD	Connector	Hole	Horz Size	Up (↓)	Offset
Invert 1	682.25'	90°	80"	30" x 19" ELL RCP	37.25" x 26.25"	Hole 40 x 28	40" x 28"	40"	-4.5"	24"
Invert 2	682.25'	90°	32"	30" x 19" ELL RCP	37.25" x 26.25"	Hole 40 x 28	40" x 28"	40"	-4.5"	-24"
Invert 3	683.75'	270°	56"	36" RCP B WALL	44"	Hole 46	46"	46"	13"	0"
Invert 4										
Invert 5										
Invert 6										
Invert 7										
Invert 8										

RIGHT-SIDE UP VIEW (int. dimensions)

UPSIDE-DOWN VIEW (int. dimensions)

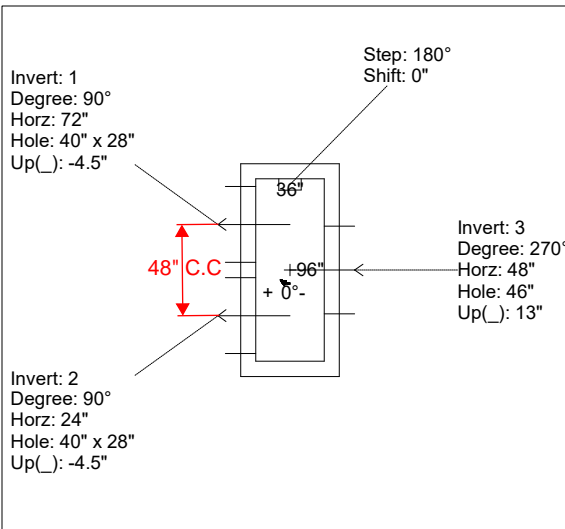

**1ST POUR (FLOOR) = 3,909 LBS
 2ND POUR (WALLS) = 13,600 LBS**

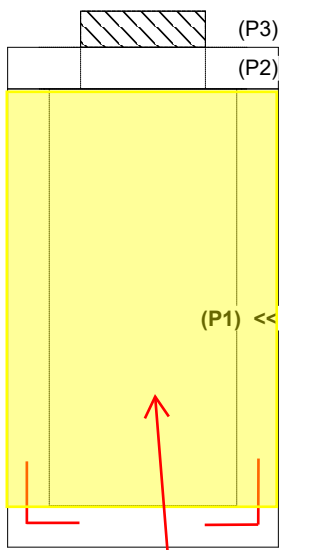

2ND POUR (WALLS)

INSIDE WALL DIMENSIONS

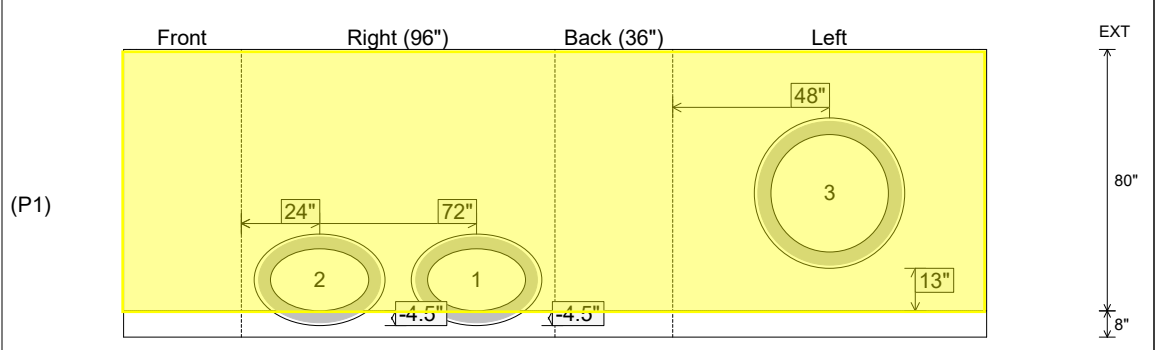

Coating (Int): Coating (Ext):	Seam Up: Flat Seam Dn: n/a	Wall Thickness: 8" Floor Height: 8"	Height (Int): 80" Height (Ext): 88"	Weight (Net): 17509 lb Volume (Net): 4.47cu.yd
----------------------------------	-------------------------------	--	--	---