

Job Name: 26-1648 837557 71 Trade Center  
 Job Location: La Grange, KY  
 Contractor: Contech Engineering Solutions

Plant: Beaver Dam  
 3/19/2026 2:02:36 PM

Tech: S. Felletter  
 PC: T. Sekula



**Structure ID: 20-CS-8**

**P5 MH096LD17SP**

**MH FLAT TOP SPEC. (2 - 24"Ø HOLES) F/G**

- P6) 24" - CASTING HEIGHT - 4"
- P5) 96" - MH FLAT TOP SPEC. (2 - 24"Ø HOLES) F/G - 17"
- P4) 96" - MH RISER T/G - 36"
- P3) 96" - MH RISER T/G - 84"
- P2) 96" - MH RISER T/G - 96"
- P1) 96" - MH MONOBASE 13F, Custom Ht T/n - 24"
- 1) CVSTENCILING
- 1) ASSEMBLY REQUIRED
- 4) 96" - Conseal CS-102 1.00"
- 2) Hole - 24

	0 lb
	10015 lb
	8968 lb
	20926 lb
	23226 lb
	17113 lb
	0 lb
	0 lb
	0 lb
	0 lb
Structure Total:	80248 lb

Structure Notes:  
 4" CASTING BY OTHERS  
  
 LIFTING ANCHORS TO BE INSTALLED ON THE OUTSIDE OF THE STRUCTURE  
  
 ICAST TO INSTALL THE INTERNALS  
  
 CONTECH'S LOGO AS WELL AS THE INLET AND OUTLET MUST BE STENCILED ONTO THE STRUCTURE

GENERAL NOTES:

1. MANUFACTURED TO ASTM C-478 (LATEST REVISION).
2. CONCRETE 5,000 PSI AT 28 DAYS.
3. WEIGHT: 10,015 LBS.
4. REINFORCING: TOP MAT: #4 BAR @ 18" C/C E.W.  
 BOTTOM MAT: #5 BAR @ 12" C/C E.W.  
 PER ASTM A615 (GRADE 60)

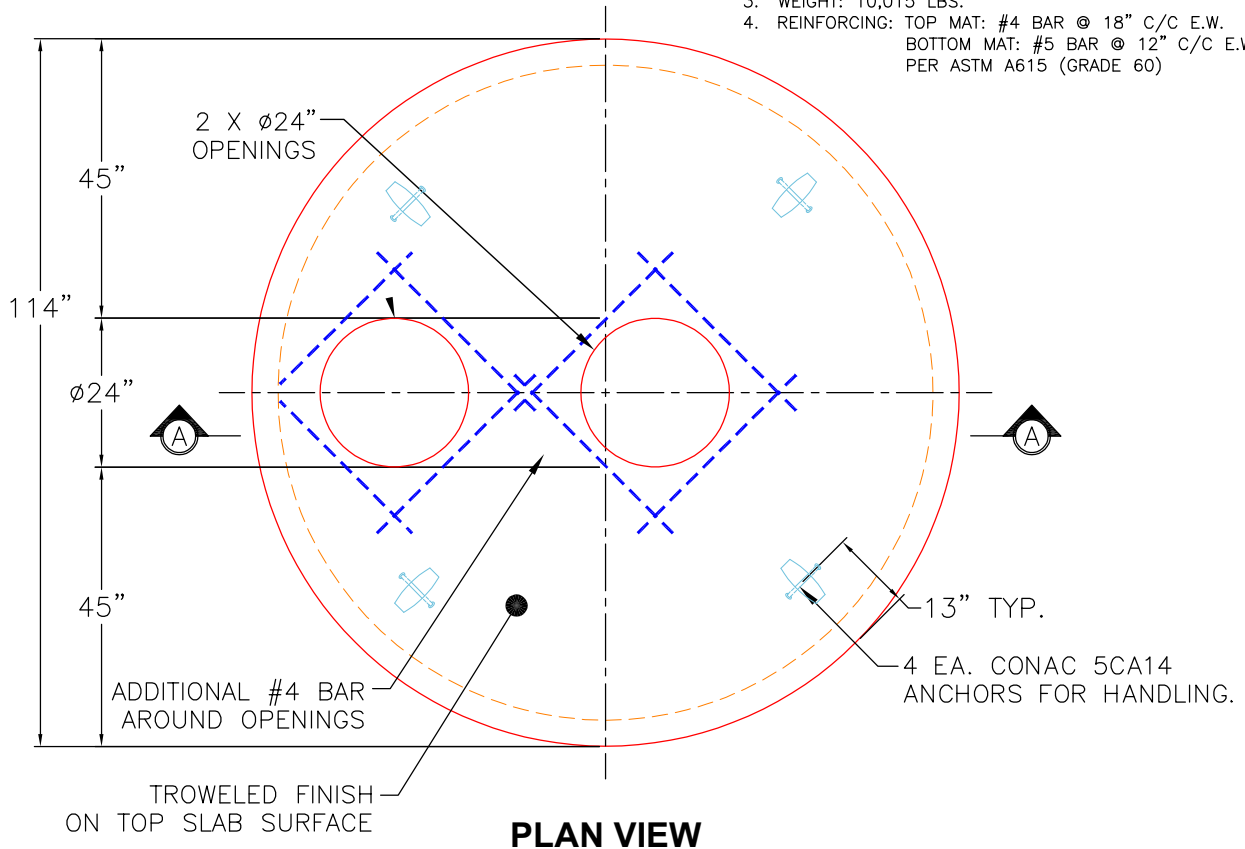

**PLAN VIEW**

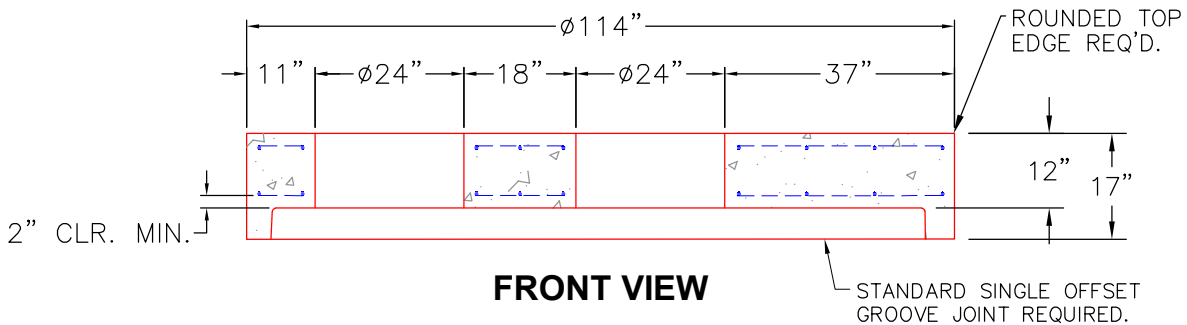

**FRONT VIEW**

Coating (Int): Coating (Ext):	Seam Up: Flat Seam Dn: Groove	Wall Thickness: 9"	Height (Ext): 17"	Weight (Net): 10015 lb Volume (Net): 2.56cu.yd
----------------------------------	----------------------------------	--------------------	-------------------	---