

Job Name: 26-1322B - KYTC Warren Co Call 104 (261503)  
 Job Location: Bowling Green, KY  
 Contractor: Cumberland Pipeline LLC

Plant: 100

4/21/2026 2:25:16 PM

Tech: Jared - A

PC: Celina Goff

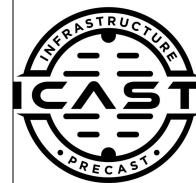

**Structure ID: 153-90 SS-MH**

**P1 MH048BAVF**

**MH BASE (08"F) T/n**

P4) 24" - CASTING HEIGHT - 7"	0 lb
P3) 48" - ECC CONE w/ 24" HOLE F/G - 36"	3000 lb
P2) 48" - MH RISER T/G - 36"	2515 lb
P1) 48" - MH BASE (08"F) T/n - 40"	4396 lb
1) 48" - MH INVERT CHANNEL - FULL HEIGHT	1440 lb
1) JOINT WRAP - 0.065"x6"x50' CONSEAL CS212	0 lb
1) JOINT WRAP PRIMER - CONSEAL CS-75 (1 gal.)	0 lb
1) CASTING - HOE MC-375 F/C BGMU Sanitary	271 lb
2) 48" - Conseal CS-102 1.00" (Double)	0 lb
1) PSX - 16L NYLO	8 lb
1) PSX - 16M NYLO	8 lb
8) MH Step ML-10-TDS-NCR - 10"	0 lb
Structure Total:	11638 lb

**Structure Notes:**  
 1. PER KYTC & ASTM C-478 SPECIFICATIONS  
 2. CONCRETE: 4,000 PSI AT 28 DAYS  
 3. REINFORCEMENT: PER ASTM A615  
 4. INVERT CHANNEL REQUIRED  
 5. STEPS AT 0 DEGREES  
 6. HOE MC-375 FRAME & COVER "BGMU SANITARY" SUPPLIED BY ICAST

Rim: 534.8' Rim to Invert: 9.84' Slack: 1.08" Sump: 2" Step Position: 0

Position	Elev	Angle	Ext. (cw)	Pipe	Pipe OD	Connector	Hole	Horz Size	Up ( )	Offset
Invert 1	524.96'	0°	0"	12" PVC SDR35	12.5"	PSX 16L NYLO	16"	16.312"	0"	0"
Invert 2	526.31'	125°	63.25"	12" DI	13.2"	PSX 16M NYLO	16"	16.312"	16.5"	0"
Invert 3										
Invert 4										
Invert 5										
Invert 6										
Invert 7										
Invert 8										

RIGHT-SIDE UP VIEW (int. dimensions)

UPSIDE-DOWN VIEW (int. dimensions)

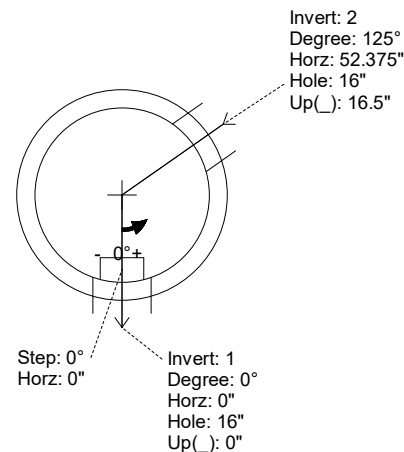
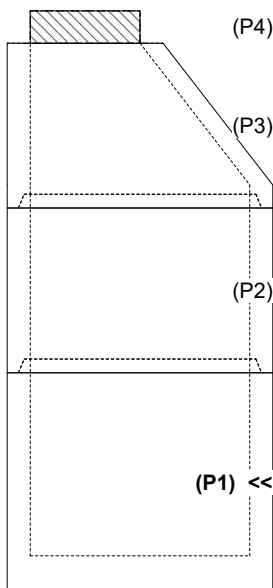

INSIDE WALL DIMENSIONS

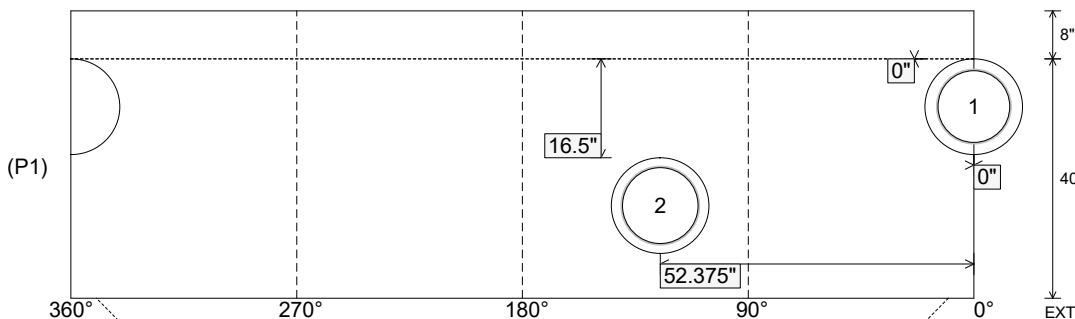

Coating (Int):  
 Coating (Ext):

Seam Up: Tongue  
 Seam Dn: n/a

Wall Thickness: 5"  
 Floor Height: 8"

Height (Int): 40"  
 Height (Ext): 48"

Weight (Net): 4396 lb  
 Volume (Net): 1.12cu.yd

**Structure ID: 153-90 SS-MH**

**P1 MH048BAVF**

**MH BASE (08"F) T/n**

P4) 24" - CASTING HEIGHT - 7" P3) 48" - ECC CONE w/ 24" HOLE F/G - 36" P2) 48" - MH RISER T/G - 36" P1) 48" - MH BASE (08"F) T/n - 40" 1) 48" - MH INVERT CHANNEL - FULL HEIGHT 1) JOINT WRAP - 0.065"x6"x50' CONSEAL CS212 1) JOINT WRAP PRIMER - CONSEAL CS-75 (1 gal.) 1) CASTING - HOE MC-375 F/C BGMU Sanitary 2) 48" - Conseal CS-102 1.00" (Double) 1) PSX - 16L NYLO 1) PSX - 16M NYLO 8) MH Step ML-10-TDS-NCR - 10"	0 lb 3000 lb 2515 lb 4396 lb 1440 lb 0 lb 0 lb 271 lb 0 lb 8 lb 8 lb 0 lb	<b>Structure Notes:</b> 1. PER KYTC & ASTM C-478 SPECIFICATIONS 2. CONCRETE: 4,000 PSI AT 28 DAYS 3. REINFORCEMENT: PER ASTM A615 4. INVERT CHANNEL REQUIRED 5. STEPS AT 0 DEGREES 6. HOE MC-375 FRAME & COVER "BGMU SANITARY" SUPPLIED BY ICAST
Structure Total:	11638 lb	

Rim: 534.8'    Rim to Invert: 9.84'    Slack: 1.08"    Sump: 2"    Step Position: 0

Position	Elev	Angle	Ext. (cw)	Pipe	Pipe OD	Connector	Hole	Horz Size	Up ( )	Offset
Invert 1	524.96'	0°	0"	12" PVC SDR35	12.5"	PSX 16L NYLO	16"	16.312"	0"	0"
Invert 2	526.31'	125°	63.25"	12" DI	13.2"	PSX 16M NYLO	16"	16.312"	16.5"	0"
Invert 3										
Invert 4										
Invert 5										
Invert 6										
Invert 7										
Invert 8										

RIGHT-SIDE UP VIEW (int. dimensions) UPSIDE-DOWN VIEW (int. dimenions)

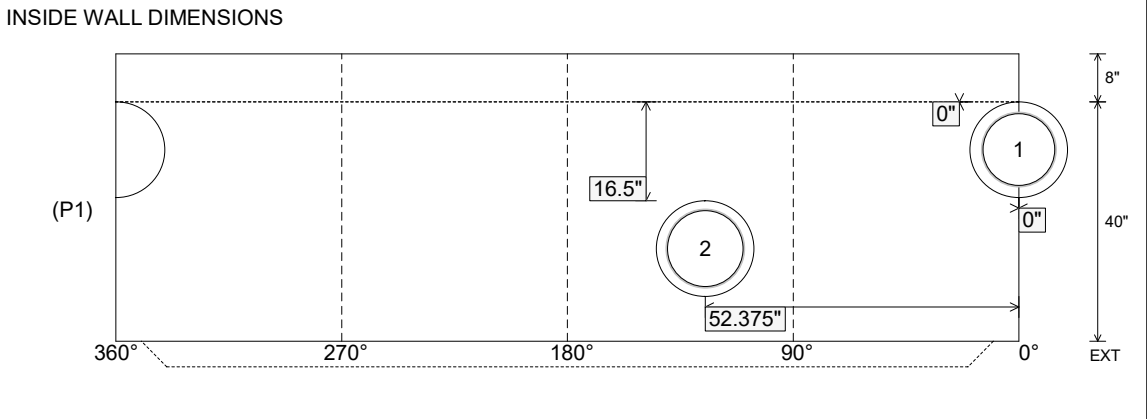
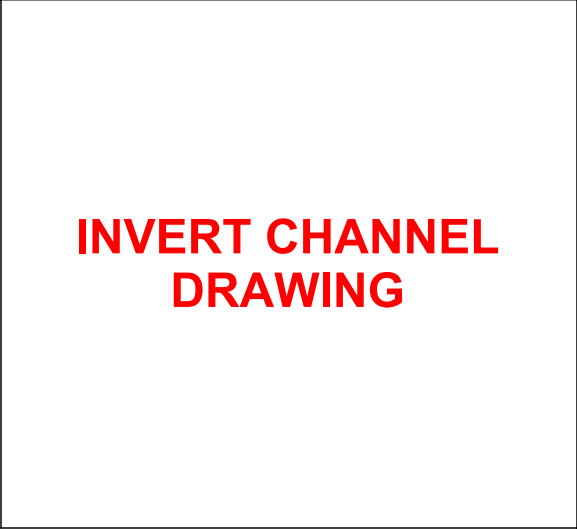
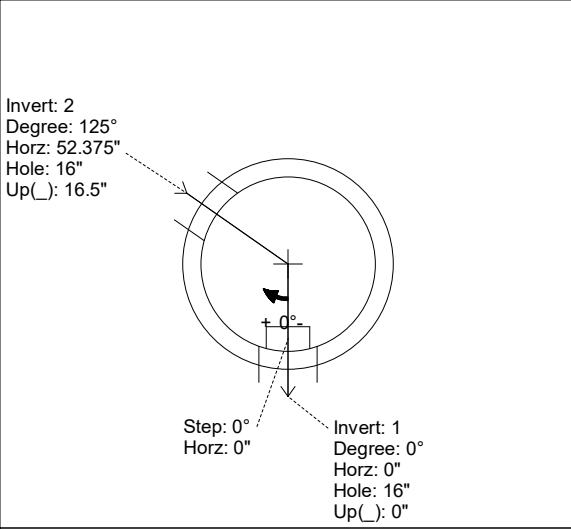
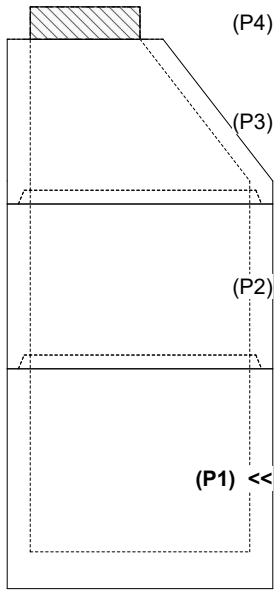

Coating (Int): Coating (Ext):	Seam Up: Tongue Seam Dn: n/a	Wall Thickness: 5" Floor Height: 8"	Height (Int): 40" Height (Ext): 48"	Weight (Net): 4396 lb Volume (Net): 1.12cu.yd
----------------------------------	---------------------------------	--	--	--