

Job Name: 26-1303 - Hale Ave & Woods Ferry Rd. Stormwater
 Job Location: Gallatin, TN 37066
 Contractor: Stewart Richey

Plant: 100
 4/13/2026 7:06:21 PM

Tech: Jared - F
 PC: T. Lewis

Structure ID: 125-13 ST-AD

P2 MH048LD12CC

MH FLAT TOP w/ 24" Center Hole F/G

- P3) 24" - CASTING HEIGHT - 4"
- P2) 48" - MH FLAT TOP w/ 24" Center Hole F/G - 12"
- P1) 48" - MH BASE Custom Ht T/n - 44"
- 1) CASTING - JBS 2272 F/G
- 1) 48" - Conseal CS-102 1.00"
- 1) Hole - 32
- 3) MH Step ML-10-TDS-NCR - 10"

0 lb
 1580 lb
 4041 lb
 250 lb
 0 lb
 0 lb
 0 lb

 Structure Total: 5871 lb

Structure Notes:
 1. PER ASTM C478 SPECIFICATIONS.
 2. CONCRETE = 4,000 PSI AT 28 DAYS.
 3. NO INVERT CHANNEL.
 4. CASTING BY ICAST (JBS 2272 F/G).

REINFORCING PER ASTM A615 (GRADE 60).
 - TOP SLAB (As .62) #5 BARS AT 6" C.C.E.W..
 - RISER/WALLS (As .12)
 - FLOOR (As .31) #5 BARS AT 12" C.C.E.W.

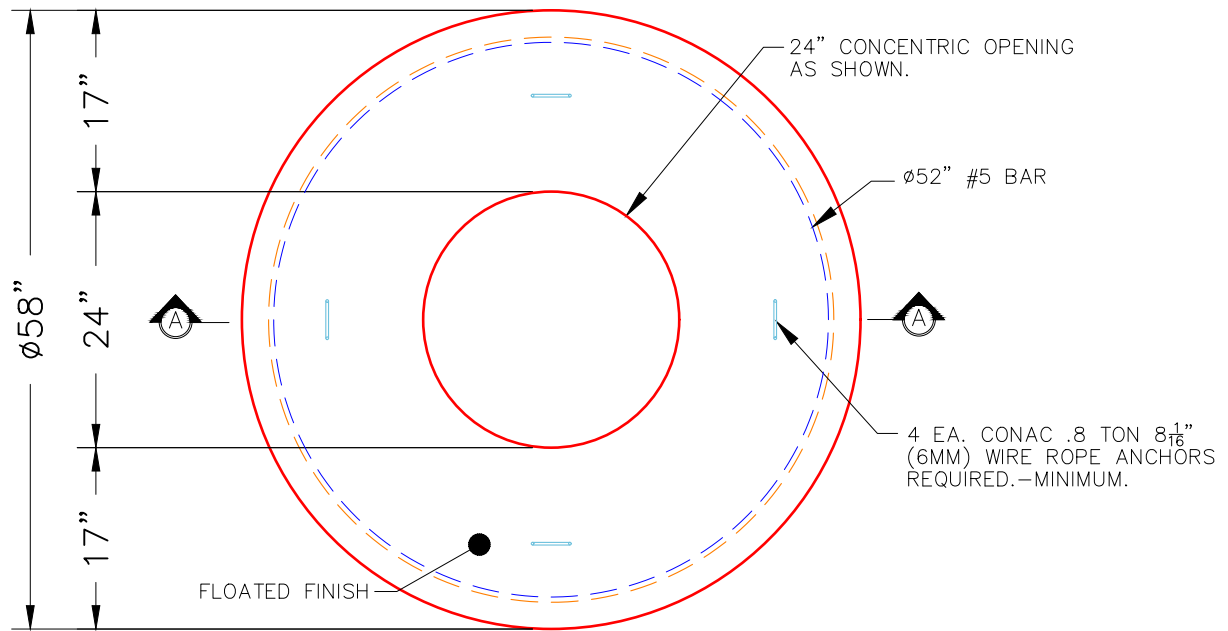

PLAN VIEW

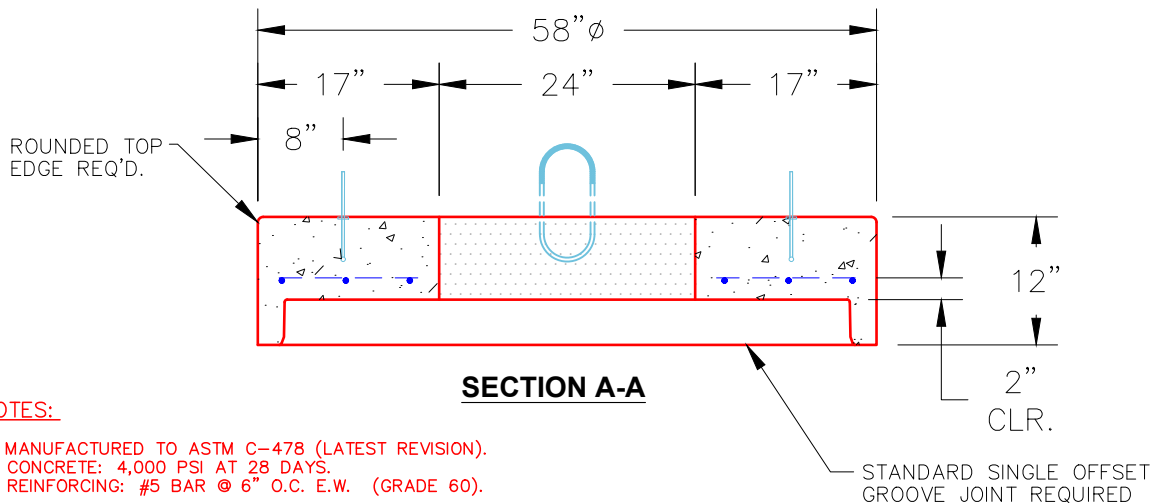

NOTES:

- 1. MANUFACTURED TO ASTM C-478 (LATEST REVISION).
- 2. CONCRETE: 4,000 PSI AT 28 DAYS.
- 3. REINFORCING: #5 BAR @ 6" O.C. E.W. (GRADE 60).

Coating (Int):
 Coating (Ext):

Seam Up: Flat
 Seam Dn: Groove

Wall Thickness: 5"

Height (Ext): 12"

Weight (Net): 1580 lb
 Volume (Net): 0.39cu.yd