

**Job Name: 26-1220 - Nix New Shop Building**  
**Job Location: Evansville, IN**  
**Contractor: K&K Excavating Inc.**

PC: T. Lewis  
 TECH: J. Horsley  
 Plant: 100



Structure ID: OCS-2  
 Spec: Storm  
 Type: BX 6inW, 8inF  
 Size: 30" x 30"

Rim: 386.88'  
 Invert: 385.27'  
 Rim to Invert: 1.61'

Sump: 0"  
 Floor (Top): 385.27'  
 Floor Height: 8"

Floor (Bot): 384.603'  
 Overall Height: 2.25'  
 Slack: 0.32"

**Structure Notes:**

1. PER ASTM C913 SPECIFICATIONS.
2. CONCRETE = 4,000 PSI AT 28 DAYS.
3. CASTING BY ICAST (EJ 6610 Grate).

REINFORCING PER ASTM A615 (GRADE 60).  
 - WALLS (As .12) #5 BARS AT 12" C.C.E.W.  
 - FLOOR (As .12) #5 BARS AT 12" C.C.E.W.

**STRUCTURE SUMMARY:**

- P2) 34" x 34" - RECESS/GRATE SEAT - 1"  
 P1) 30" x 30" - BOX BASE 6inW, 8inF, Variable Ht F/n - 19"
- 1) CASTING - EJ 6610 GRT
  - 1) Hole - 16
  - 1) Hole - 5.75"

0 lb  
 2447 lb  
 250 lb  
 0 lb  
 0 lb  
 -----  
 0 lb

Structure Total: 2697 lb

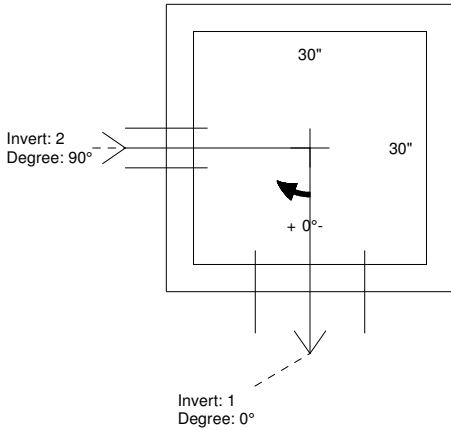

Position	Elev	Angle	Pipe	Pipe OD	Hole	Connector	Up ( )	Ref
Rim	386.88'							
Reducer								
Invert 1	385.27'	0°	12" HDPE	14.5"	16"	Hole 16	-1.25"	P1
Invert 2	385.27'	90°	5.75" Orifice	5.75"	5.75"	Hole 5.75"	0"	P1
Invert 3								
Invert 4								
Invert 5								
Invert 6								
Invert 7								
Invert 8								

**34.5"x34.5"x1" DEEP RECESS  
 IN TOP OF WALLS  
 FOR EJ-6610 GRATE**

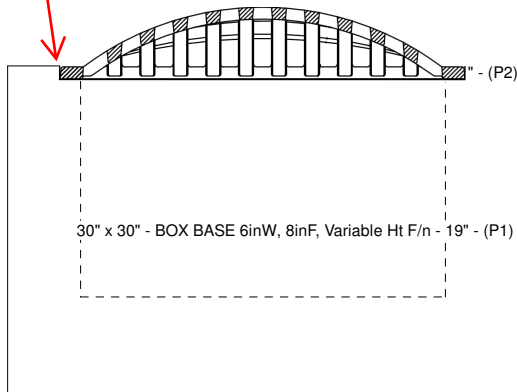

**Cast (Int. Dim.) - Interior Dimensions**

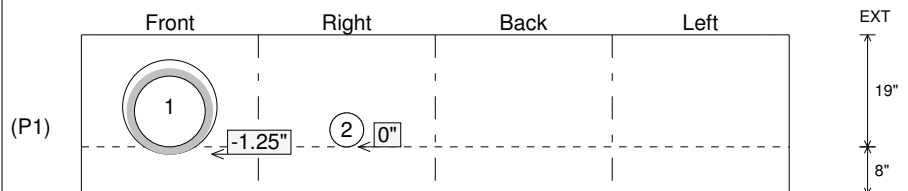

Submittal Drawing  
 3/11/2026 11:54:13 AM

SUBMITTAL  
 APPROVED BY: