

Job Name: 26-1077 - Westside Markets of Greensboro Village  
 Job Location: Gallatin, TN  
 Contractor: Cleary Construction, Inc.

Plant: 100

3/3/2026 1:26:11 PM

Tech: J. Horsley - F

PC: C. Goff



**Structure ID: D1 (30)**

**P1 BX066066-08W12FEBAV**

**BX BASE w/FLANGE 08W/12F/18EF T/n**

- P3) 66" x 66" - CASTING HEIGHT - 0"
- P2) 66" x 66" - BOX RISER 8inW, Variable Ht F/G - 49"
- P1) 66" x 66" - BX BASE w/FLANGE 08W/12F/18EF T/n - 70"
- 1) SECONDARY POUR
- 1) 66" x 66" - Conseal CS-102 1.00"
- 1) Hole - 62
- 1) Hole - 1
- 1) Hole - 3
- 1) Orifice - 6.5"
- 1) Weir n/n - 12"x31.2"

0 lb  
 9488 lb  
 25876 lb  
 0 lb  
 0 lb  
 0 lb  
 0 lb  
 0 lb  
 0 lb  
 0 lb  
 0 lb  
 0 lb  
 Structure Total: 35364 lb

- Structure Notes:**
1. PER ASTM C-913 SPECIFICATIONS
  2. CONCRETE: 4,000 PSI AT 28 DAYS
  3. REINFORCEMENT: DOUBLE MAT #5 BAR @ 12" C.C. E.W. (GRADE 60) - 2" MIN. REBAR CLEARANCE (TYP)
  4. NO STORM INVERT
  5. NO STEPS
  6. CASTING SUPPLIED BY OTHERS
  7. WET STICK #5 L-BARS SPACED @ 12" C.C. (GRADE 60) OUT OF FLOOR FOR WALL POUR TIE-IN (SEE L-BAR DETAILS)

**FIRST POUR (FLOOR): 14,021 LBS**  
**SECOND POUR (WALLS): 11,855 LBS**

Rim: 496.15' Rim to Invert: 9.95' Slack: 0.4" Sump: 0" Step Position:

Position	Elev	Angle	Ext. (cw)	Pipe	Pipe OD	Connector	Hole	Horz Size	Up (L)	Offset
Invert 1	486.2'	0°	41"	48" RCP B WALL	58"	Hole 62	62"	62"	-5"	0"
Invert 2	486.2'	180°	41"	1" Orifice	1"	Hole 1	1"	1"	0"	0"
Invert 3	488.9'	180°	41"	3" Orifice	3"	Hole 3	3"	3"	32.375"	0"
Invert 4	489.6'	180°	41"	6.5" Orifice	6.5"	Orifice 6.5"	6.5"	6.5"	40.75"	0"
Invert 5										
Invert 6										

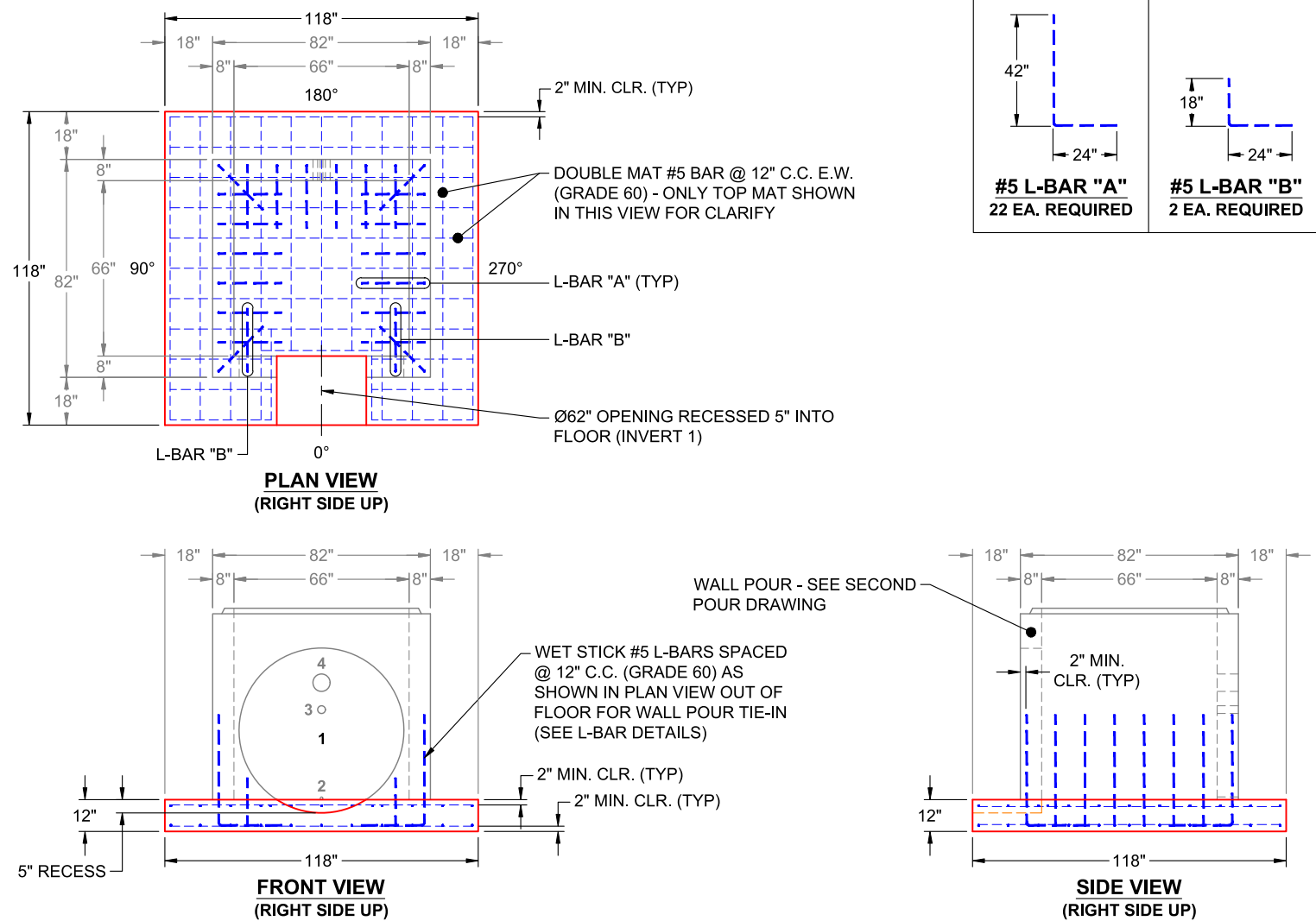

Coating (Int): Coating (Ext):	Seam Up: Tongue Seam Dn: n/a	Wall Thickness: 8" Floor Height: 12"	Height (Int): 70" Height (Ext): 82"	Weight (Net): 25876 lb Volume (Net): 6.61cu.yd
----------------------------------	---------------------------------	---	--	---

