

Job Name: 26-1077 - Westside Markets of Greensboro Village
 Job Location: Gallatin, TN
 Contractor: Cleary Construction, Inc.

Plant: 100

3/27/2026 4:33:38 PM

Tech: J. Horsley - F

PC: C. Goff



Structure ID: A9

P1 MH060BAVF

MH BASE Custom Ht F/n

- P3) 30" x 36" - CASTING HEIGHT - 6.50"
- P2) 60" - MH FLAT TOP w/30"x36" Hole F/F - 8"
- P1) 60" - MH BASE Custom Ht F/n - 63"
- 1) 60" - STORM INVERT CHANNEL - 1/4 HEIGHT
- 1) 60" - Conseal CS-102 1.00"
- 1) Hole - 38
- 1) Hole - 30
- 1) Hole - 20
- 3) Hole - 6
- 5) MH Step ML-10-TDS-NCR - 10"

0 lb
 2008 lb
 8127 lb
 1700 lb
 0 lb
 0 lb
 0 lb
 0 lb
 0 lb
 0 lb
 0 lb
 Structure Total: 11835 lb

Structure Notes:
 1. PER ASTM C478 SPECIFICATIONS.
 2. CONCRETE = 4,000 PSI AT 28 DAYS.
 3. CASTING SUPPLIED BY OTHERS (JBS 2064 F/G/H - SINGLE CURB INLET).

REINFORCING PER ASTM A615 (GRADE 60).
 - TOP SLAB (As .62) #5 BARS AT 6" C.C.E.W..
 - RISER/WALLS (As .18)
 - FLOOR (As .37) #5 BARS AT 10" C.C.E.W.

Rim: 500.5' Rim to Invert: 6.49' Slack: 2.93" Sump: 2.55" Step Position: 201.5°

Position	Elev	Angle	Ext. (cw)	Pipe	Pipe OD	Connector	Hole	Horz Size	Up ()	Offset
Invert 1	494.01'	0°	0"	30" HDPE	35.1"	Hole 38	38"	41.151"	0"	0"
Invert 2	494.06'	133°	83.625"	24" HDPE	27.8"	Hole 30	30"	31.416"	1.25"	0"
Invert 3	497'	48°	30.125"	15" HDPE	17.6"	Hole 20	20"	20.39"	37.125"	0"
Invert 4	498.33'	0°	0"	4" HDPE (perf pipe)	4.8"	Hole 6	6"	6.01"	54"	0"
Invert 5	498.33'	130°	81.625"	4" HDPE (perf pipe)	4.8"	Hole 6	6"	6.01"	54"	0"
Invert 6	498.33'	270°	169.625"	4" HDPE (perf pipe)	4.8"	Hole 6	6"	6.01"	54"	0"
Invert 7										
Invert 8										

RIGHT-SIDE UP VIEW (int. dimensions)

UPSIDE-DOWN VIEW (int. dimensions)

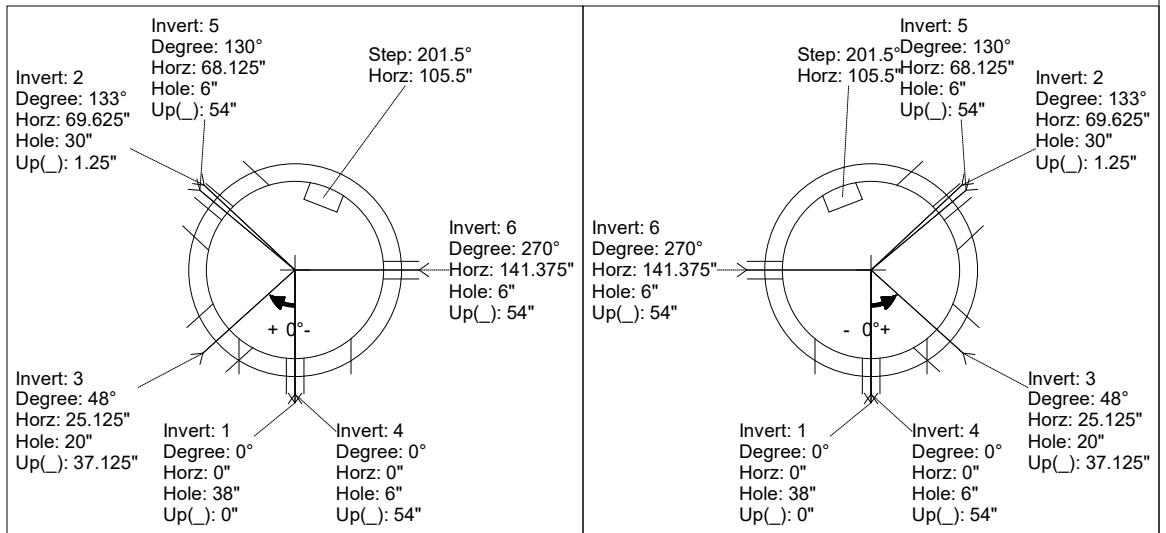

INSIDE WALL DIMENSIONS

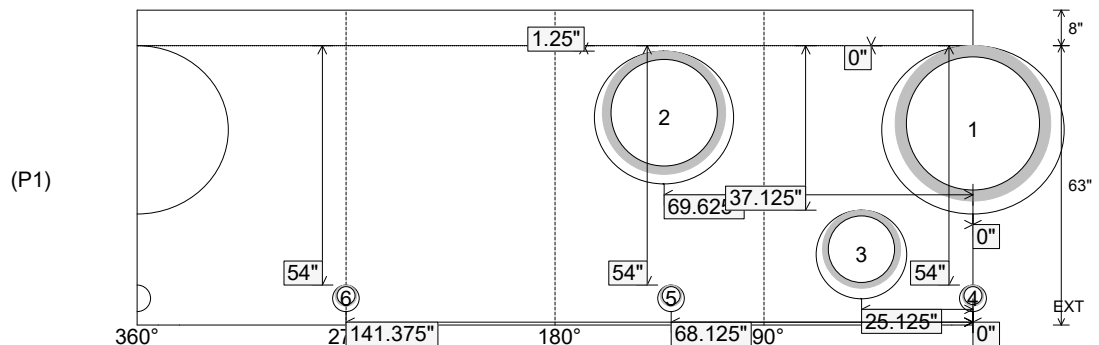

Coating (Int):
 Coating (Ext):

Seam Up: Flat
 Seam Dn: n/a

Wall Thickness: 6"
 Floor Height: 8"

Height (Int): 63"
 Height (Ext): 71"

Weight (Net): 8127 lb
 Volume (Net): 2.08cu.yd

Job Name: 26-1077 - Westside Markets of Greensboro Village
 Job Location: Gallatin, TN
 Contractor: Cleary Construction, Inc.

Plant: 100
 3/27/2026 4:33:38 PM

Tech: J. Horsley - F
 PC: C. Goff



Structure ID: A9

P1 MH060BAVF

MH BASE Custom Ht F/n

P3) 30" x 36" - CASTING HEIGHT - 6.50"
 P2) 60" - MH FLAT TOP w/30"x36" Hole F/F - 8"
 P1) 60" - MH BASE Custom Ht F/n - 63"

1) 60" - STORM INVERT CHANNEL - 1/4 HEIGHT

- 1) 60" - Conseal CS-102 1.00"
- 1) Hole - 38
- 1) Hole - 30
- 1) Hole - 20
- 3) Hole - 6
- 5) MH Step ML-10-TDS-NCR - 10"

0 lb
 2008 lb
 8127 lb
 1700 lb
 0 lb
 0 lb
 0 lb
 0 lb
 0 lb
 0 lb
 0 lb
 Structure Total: 11835 lb

Structure Notes:

1. PER ASTM C478 SPECIFICATIONS.
2. CONCRETE = 4,000 PSI AT 28 DAYS.
3. CASTING SUPPLIED BY OTHERS (JBS 2064 F/G/H - SINGLE CURB INLET).

REINFORCING PER ASTM A615 (GRADE 60).
 - TOP SLAB (As .62) #5 BARS AT 6" C.C.E.W..
 - RISER/WALLS (As .18)
 - FLOOR (As .37) #5 BARS AT 10" C.C.E.W.

Rim: 500.5' Rim to Invert: 6.49' Slack: 2.93' Sump: 2.55' Step Position: 201.5°

Position	Elev	Angle	Ext. (cw)	Pipe	Pipe OD	Connector	Hole	Horz Size	Up ()	Offset
Invert 1	494.01'	0°	0"	30" HDPE	35.1"	Hole 38	38"	41.151"	0"	0"
Invert 2	494.06'	133°	83.625"	24" HDPE	27.8"	Hole 30	30"	31.416"	1.25"	0"
Invert 3	497'	48°	30.125"	15" HDPE	17.6"	Hole 20	20"	20.39"	37.125"	0"
Invert 4	498.33'	0°	0"	4" HDPE (perf pipe)	4.8"	Hole 6	6"	6.01"	54"	0"
Invert 5	498.33'	130°	81.625"	4" HDPE (perf pipe)	4.8"	Hole 6	6"	6.01"	54"	0"
Invert 6	498.33'	270°	169.625"	4" HDPE (perf pipe)	4.8"	Hole 6	6"	6.01"	54"	0"
Invert 7										
Invert 8										

RIGHT-SIDE UP VIEW (int. dimensions)

UPSIDE-DOWN VIEW (int. dimensions)

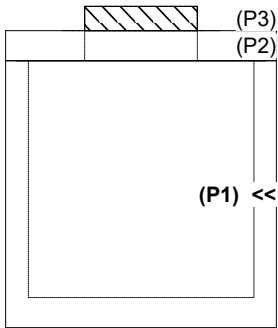
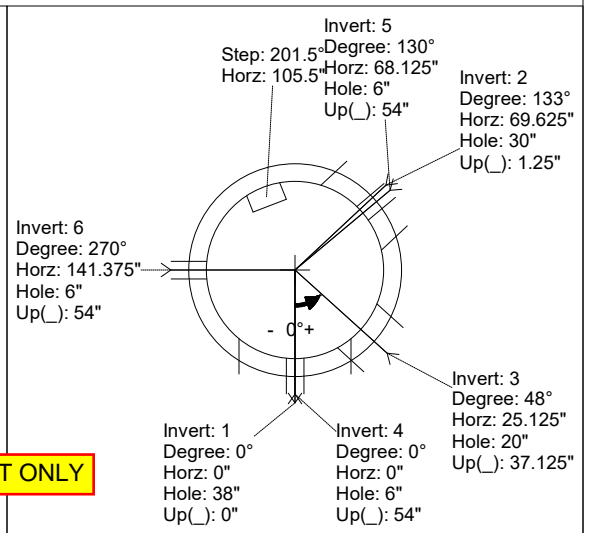
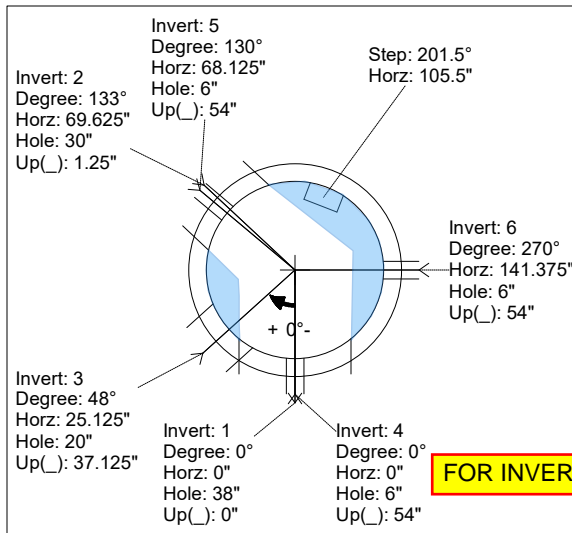

INSIDE WALL DIMENSIONS

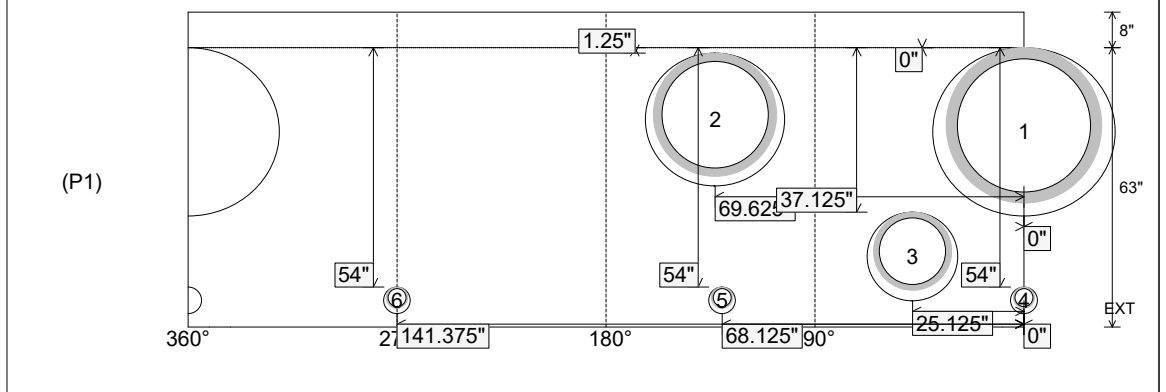

Coating (Int): Coating (Ext):	Seam Up: Flat Seam Dn: n/a	Wall Thickness: 6" Floor Height: 8"	Height (Int): 63" Height (Ext): 71"	Weight (Net): 8127 lb Volume (Net): 2.08cu.yd
----------------------------------	-------------------------------	--	--	--