

Job Name: 26-1077 - Westside Markets of Greensboro Village
 Job Location: Gallatin, TN
 Contractor: Cleary Construction, Inc.

Plant: 100
 3/27/2026 4:33:45 PM

Tech: J. Horsley - F
 PC: C. Goff



Structure ID: A11

P1 MH048BAVF

MH BASE Custom Ht F/n

- P3) 30" x 36" - CASTING HEIGHT - 6.50"
- P2) 48" - MH FLAT TOP w/30"x36" Hole F/F - 7"
- P1) 48" - MH BASE Custom Ht F/n - 32"
- 1) 48" - STORM INVERT CHANNEL - 1/4 HEIGHT
- 1) 48" - Conseal CS-102 1.00"
- 2) Hole - 24
- 3) Hole - 6
- 3) MH Step ML-10-TDS-NCR - 10"

0 lb
 918 lb
 3136 lb
 1075 lb
 0 lb
 0 lb
 0 lb
 0 lb
 0 lb
 Structure Total: 5128 lb

Structure Notes:
 1. PER ASTM C478 SPECIFICATIONS.
 2. CONCRETE = 4,000 PSI AT 28 DAYS.
 3. CASTING SUPPLIED BY OTHERS (JBS 2064 F/G/H - SINGLE CURB INLET).
 REINFORCING PER ASTM A615 (GRADE 60).
 - TOP SLAB (As .62) #5 BARS AT 6" C.C.E.W..
 - RISER/WALLS (As .12)
 - FLOOR (As .31) #5 BARS AT 12" C.C.E.W.

Rim: 500.55' Rim to Invert: 3.8' Slack: 1.7" Sump: 1.6" Step Position: 310°

| Position | Elev | Angle | Ext. (cw) | Pipe | Pipe OD | Connector | Hole | Horz Size | Up () | Offset |
|----------|---------|-------|-----------|---------------------|---------|-----------|------|-----------|--------|--------|
| Invert 1 | 496.75' | 0° | 0" | 18" HDPE | 21.2" | Hole 24 | 24" | 25.133" | 0" | 0" |
| Invert 2 | 496.8' | 165° | 83.5" | 18" HDPE | 21.2" | Hole 24 | 24" | 25.133" | 0.625" | 0" |
| Invert 3 | 498.55' | 60° | 30.375" | 4" HDPE (perf pipe) | 4.8" | Hole 6 | 6" | 6.016" | 22.75" | 0" |
| Invert 4 | 498.55' | 130° | 65.75" | 4" HDPE (perf pipe) | 4.8" | Hole 6 | 6" | 6.016" | 22.75" | 0" |
| Invert 5 | 498.55' | 260° | 131.625" | 4" HDPE (perf pipe) | 4.8" | Hole 6 | 6" | 6.016" | 22.75" | 0" |
| Invert 6 | | | | | | | | | | |
| Invert 7 | | | | | | | | | | |
| Invert 8 | | | | | | | | | | |

RIGHT-SIDE UP VIEW (int. dimensions)

UPSIDE-DOWN VIEW (int. dimensions)

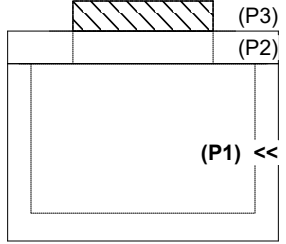
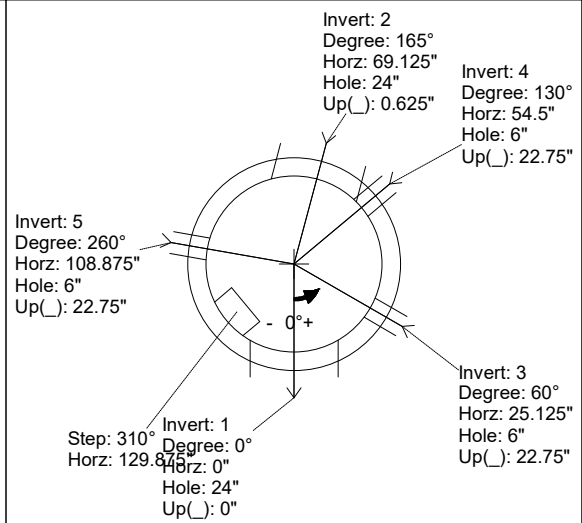
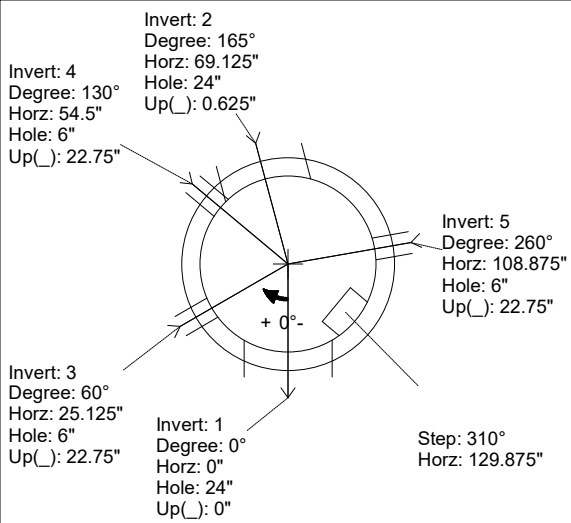

INSIDE WALL DIMENSIONS

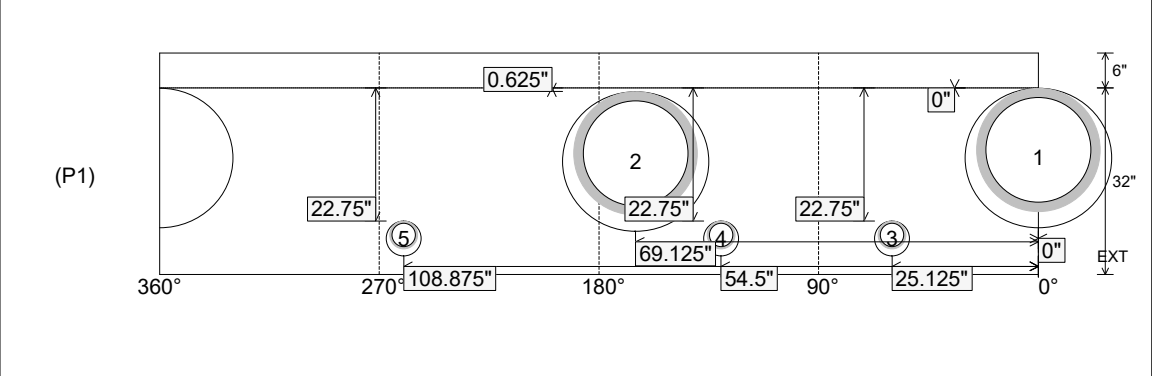

| | | | | |
|----------------------------------|-------------------------------|--|--|---|
| Coating (Int): Coating (Ext): | Seam Up: Flat Seam Dn: n/a | Wall Thickness: 5" Floor Height: 6" | Height (Int): 32" Height (Ext): 38" | Weight (Net): 3136 lb Volume (Net): 0.8cu.yd |
|----------------------------------|-------------------------------|--|--|---|

Job Name: 26-1077 - Westside Markets of Greensboro Village
 Job Location: Gallatin, TN
 Contractor: Cleary Construction, Inc.

Plant: 100
 3/27/2026 4:33:45 PM

Tech: J. Horsley - F
 PC: C. Goff



Structure ID: A11

P1 MH048BAVF

MH BASE Custom Ht F/n

P3) 30" x 36" - CASTING HEIGHT - 6.50"
 P2) 48" - MH FLAT TOP w/30"x36" Hole F/F - 7"
 P1) 48" - MH BASE Custom Ht F/n - 32"
1) 48" - STORM INVERT CHANNEL - 1/4 HEIGHT
 1) 48" - Conseal CS-102 1.00"
 2) Hole - 24
 3) Hole - 6
 3) MH Step ML-10-TDS-NCR - 10"

0 lb
 918 lb
 3136 lb
 1075 lb
 0 lb
 0 lb
 0 lb
 0 lb
 0 lb
 Structure Total: 5128 lb

Structure Notes:
 1. PER ASTM C478 SPECIFICATIONS.
 2. CONCRETE = 4,000 PSI AT 28 DAYS.
 3. CASTING SUPPLIED BY OTHERS (JBS 2064 F/G/H - SINGLE CURB INLET).
 REINFORCING PER ASTM A615 (GRADE 60).
 - TOP SLAB (As .62) #5 BARS AT 6" C.C.E.W..
 - RISER/WALLS (As .12)
 - FLOOR (As .31) #5 BARS AT 12" C.C.E.W.

Rim: 500.55' Rim to Invert: 3.8' Slack: 1.7" Sump: 1.6" Step Position: 310°

| Position | Elev | Angle | Ext. (cw) | Pipe | Pipe OD | Connector | Hole | Horz Size | Up (↓) | Offset |
|----------|---------|-------|-----------|---------------------|---------|-----------|------|-----------|--------|--------|
| Invert 1 | 496.75' | 0° | 0" | 18" HDPE | 21.2" | Hole 24 | 24" | 25.133" | 0" | 0" |
| Invert 2 | 496.8' | 165° | 83.5" | 18" HDPE | 21.2" | Hole 24 | 24" | 25.133" | 0.625" | 0" |
| Invert 3 | 498.55' | 60° | 30.375" | 4" HDPE (perf pipe) | 4.8" | Hole 6 | 6" | 6.016" | 22.75" | 0" |
| Invert 4 | 498.55' | 130° | 65.75" | 4" HDPE (perf pipe) | 4.8" | Hole 6 | 6" | 6.016" | 22.75" | 0" |
| Invert 5 | 498.55' | 260° | 131.625" | 4" HDPE (perf pipe) | 4.8" | Hole 6 | 6" | 6.016" | 22.75" | 0" |
| Invert 6 | | | | | | | | | | |
| Invert 7 | | | | | | | | | | |
| Invert 8 | | | | | | | | | | |

RIGHT-SIDE UP VIEW (int. dimensions)

UPSIDE-DOWN VIEW (int. dimensions)

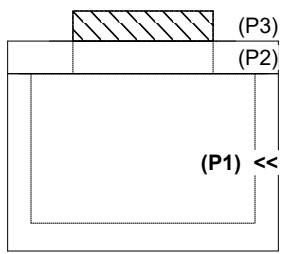
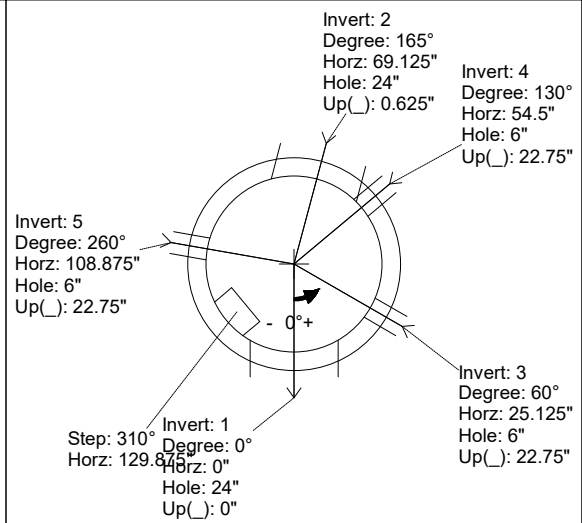
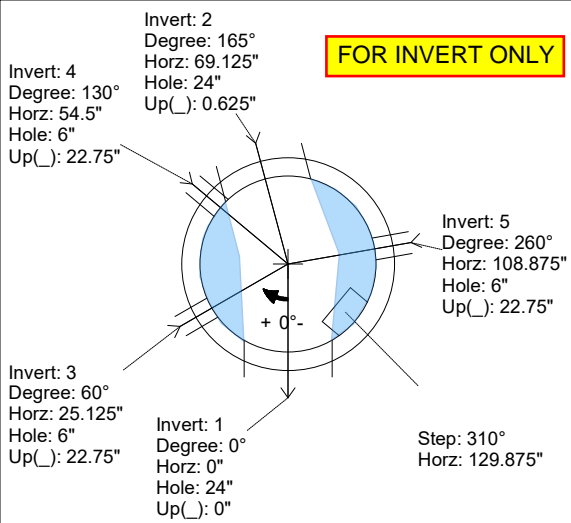

INSIDE WALL DIMENSIONS

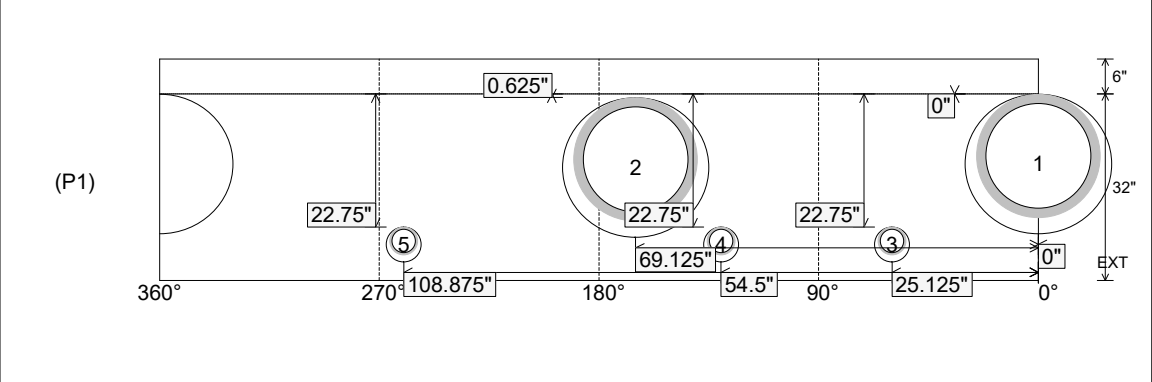

| | | | | |
|----------------------------------|-------------------------------|--|--|---|
| Coating (Int): Coating (Ext): | Seam Up: Flat Seam Dn: n/a | Wall Thickness: 5" Floor Height: 6" | Height (Int): 32" Height (Ext): 38" | Weight (Net): 3136 lb Volume (Net): 0.8cu.yd |
|----------------------------------|-------------------------------|--|--|---|