

Job Name: 26-1005 KPDI Water & Sewer Project  
 Job Location: Albany, KY  
 Contractor: Twin States Utilities, Inc.

Plant: Beaver Dam  
 2/6/2026 11:36:59 AM

Tech: S. Felletter  
 PC: E. Bradley



**Structure ID: 61005 (2)**

**P3 MH072LD15S**

**MH FLAT TOP w/36"x54" Hatch F/G**

- P3) 72" - MH FLAT TOP w/36"x54" Hatch F/G - 15"
- P2) 72" - MH RISER Custom Ht T/G - 63"
- P1) 72" - MH BASE T/n - 24"
- 1) HATCH (Alum.) - HALLIDAY W1S 36"x54"
- 1) JOINT WRAP - 12" WD x 072" MAC WRAP
- 1) SPECIAL Internal Coating
- 2) 72" - Conseal CS-231 1.00" (Double)
- 204.99 SqFt) Tnemec HS Epoxy Series 104 [INT]

3625 lb  
 9184 lb  
 7398 lb  
 107 lb  
 0 lb  
 0 lb  
 0 lb  
 0 lb  
 0 lb  
 -----  
 Structure Total: 20315 lb

**Structure Notes:**

1. PER ASTM C478 SPECIFICATIONS.
2. CONCRETE = 4,500 PSI AT 28 DAYS.
3. NO STEPS / NO INVERT CHANNEL.
4. HALLIDAY HATCH W1S 36X54 W/ SAFETY GRATING BY ICAST. CAST-IN.
5. INTERIOR COATING TO BE 2 COATS OF TNEMEC SERIES 104 H.S. EPOXY. APPLIED BY ICAST BEFORE DELIVERY.
6. 6" VENT PIPE CAST INTO TOP SLAB.
7. ALL OPENINGS TO BE CORED IN THE FIELD BY OTHERS.

REINFORCING PER ASTM A615 (GRADE 60).  
 - TOP SLAB (As .31) #5 BARS AT 6" C.C.E.W.  
 - RISER/WALLS (As .12)  
 - FLOOR (As .37) #5 BARS AT 10" C.C.E.W.

**GENERAL NOTES:**

1. MANUFACTURED TO ASTM C-478 (LATEST REVISION).
2. CONCRETE 5,000 PSI AT 28 DAYS.
3. REINFORCING: AS SHOWN BELOW PER ASTM C-478 (GRADE 60)
4. HALLIDAY W1S 36" X 54" HATCH BY ICAST
5. HATCH TO BE INSTALLED IN TOP SLAB
6. STRUCTURE TO RECEIVE TWO INTERNAL COATINGS OF TNEMEC SERIES 104 H.S. EPOXY.
7. 6" VENT PIPE TO BE CAST INTO THE TOP SLAB.

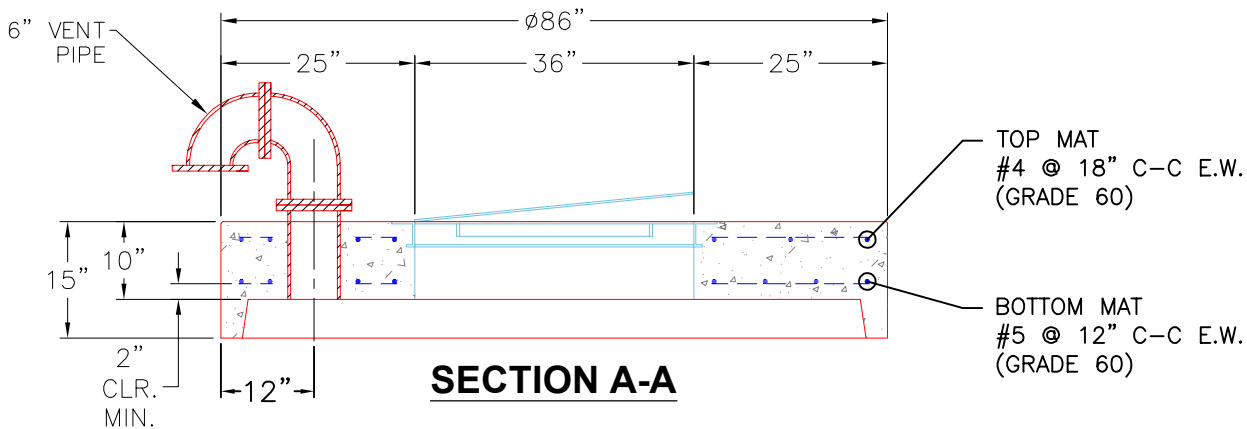
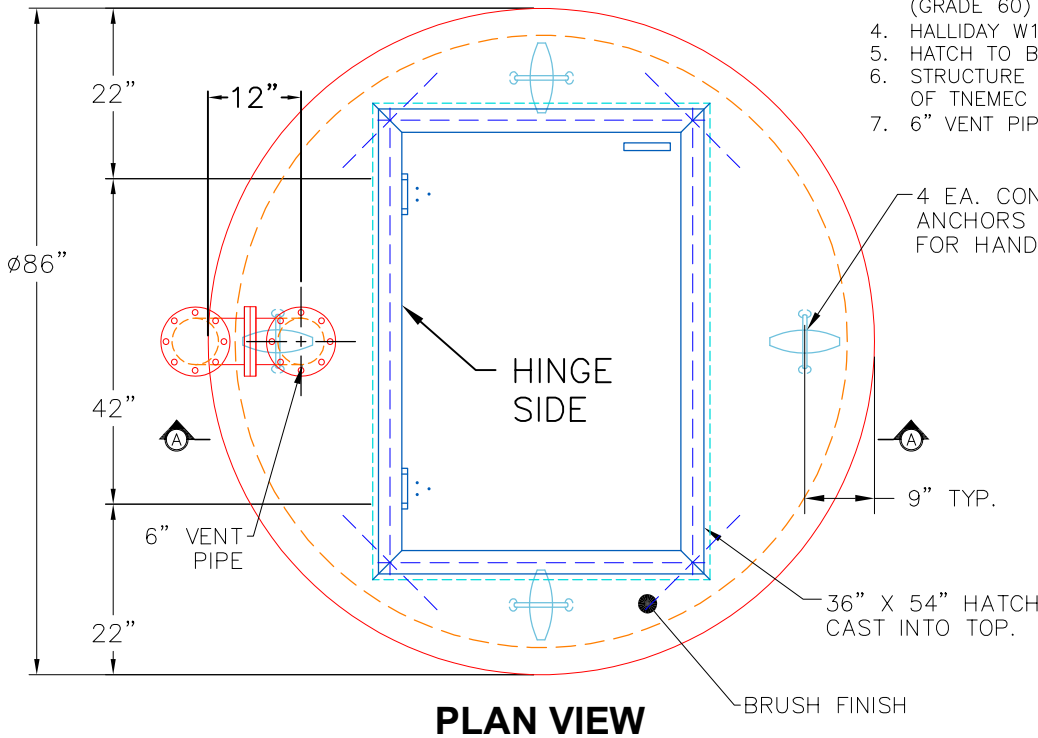

Coating (Int): Tnemec HS Epoxy Series 104 Coating (Ext):	Seam Up: Flat Seam Dn: Groove	Wall Thickness: 7"	Height (Ext): 15"	Weight (Net): 3625 lb Volume (Net): 0.93cu.yd
---	----------------------------------	--------------------	-------------------	--