

Job Name: 25-4674 TMMI Maverick SW3 & 4
 Job Location: Georgetown, KY
 Contractor: Aristeo Contracting

Plant: Beaver Dam
 3/5/2026 2:11:23 PM

Tech: S. Felletter
 PC: E. Bradley



Structure ID: OCS (11)

P2 BX363608R-VF

BOX RISER 8inW, Variable Ht F/G

- P3) 36" x 36" - CASTING HEIGHT - 0"
- P2) 36" x 36" - BOX RISER 8inW, Variable Ht F/G - 37"
- P1) 36" x 36" - BX BASE w/FLANGE 08W/08F/08EF T/n - 32"
- 1) CASTING - TRASHRACKS LFS-3636-P SQ. Flush Mount Grate
- 2) 36" x 36" - Conseal CS-102 1.00"
- 1) Hole - 32
- 2) Hole - 8
- 1) Weir n/n - 24"x15"
- 1) Weir n/n - 24"x10"

0 lb
 3969 lb
 6277 lb
 195 lb
 0 lb
 0 lb
 0 lb
 0 lb
 0 lb
 0 lb
 0 lb
 Structure Total: 10441 lb

Structure Notes:
 1. PER ASTM C913 SPECIFICATIONS.
 2. CONCRETE = 5,000 PSI AT 28 DAYS.
 3. CASTING BY ICAST (LFS-36 TRASH RACK).

 REINFORCING PER ASTM A615 (GRADE 60).
 - WALLS (As .47) #5 BARS AT 8" C.C.E.W.
 - FLOOR (As .47) #5 BARS AT 8" C.C.E.W.

Rim: 861.25' Rim to Invert: 5.75' Slack: -0.002" Sump: 0" Step Position:

Position	Elev	Angle	Ext. (cw)	Pipe	Pipe OD	Connector	Hole	Horz Size	Up ()	Offset
Invert 1										
Invert 2										
Invert 3	860'	180°	26"	24" x 15" Weir	24" x 15"	Weir 24"x15"	24" x 15"	24"	20"	0"
Invert 4	858.65'	180°	26"	24" x 10" Weir	24" x 10"	Weir 24"x10"	24" x 10"	24"	3.8"	0"
Invert 5										
Invert 6										
Invert 7										
Invert 8										

RIGHT-SIDE UP VIEW (int. dimensions)

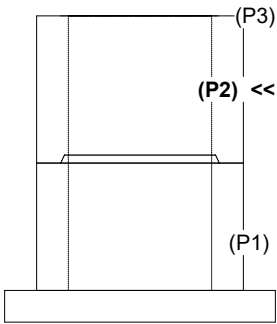
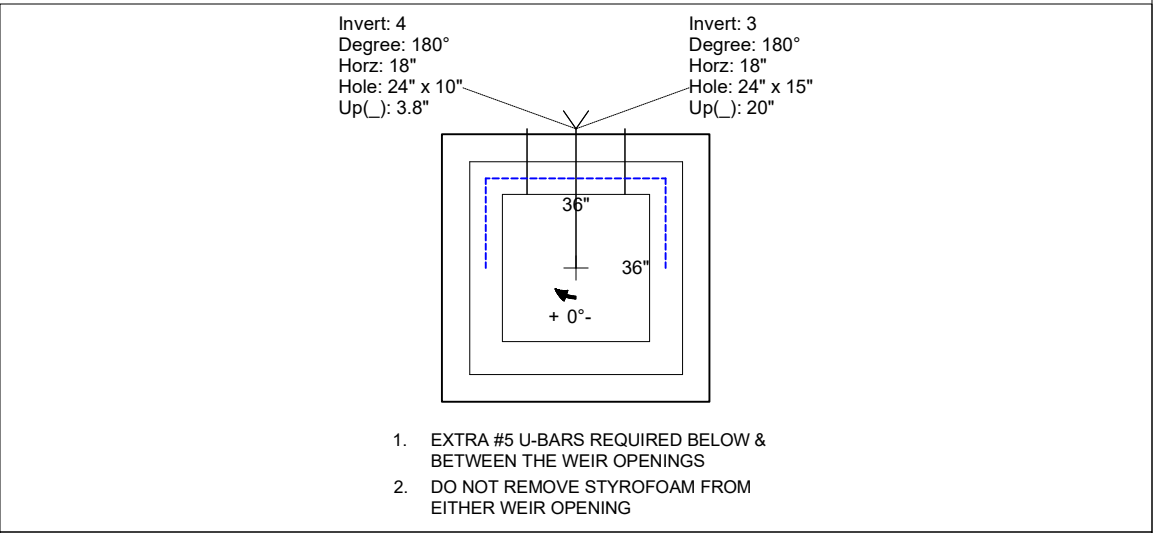

INSIDE WALL DIMENSIONS

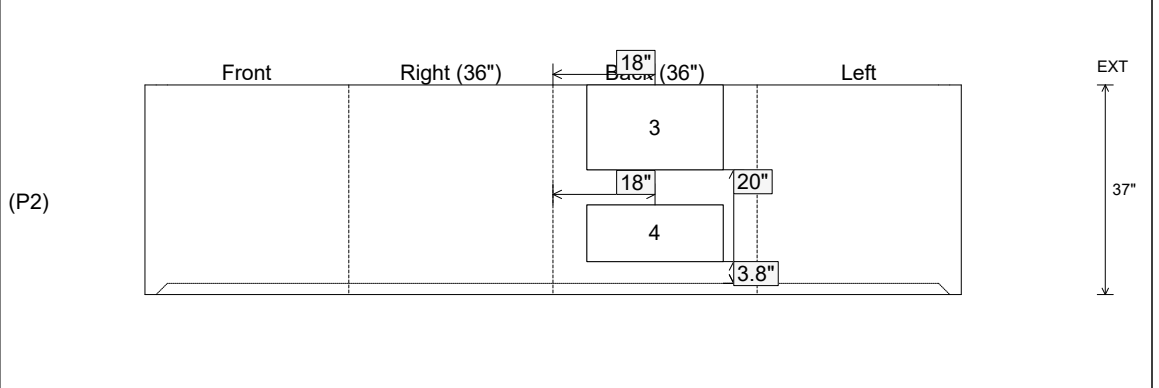

Coating (Int): Coating (Ext):	Seam Up: Flat Seam Dn: Groove	Wall Thickness: 8" Floor Height: 0"	Height (Int): 37" Height (Ext): 37"	Weight (Net): 3969 lb Volume (Net): 1.01cu.yd
----------------------------------	----------------------------------	--	--	--