

Job Name: 25-4595 - 4015 Utah Ave
 Job Location: Nashville, TN 37209
 Contractor: Hayes Pipe Supply

Plant: 100
 2/26/2026 12:07:44 PM

Tech: Jared - F
 PC: E. Bradley



Structure ID: A2 (3)

P2 MH048CCN24

CON CONE w/24" HOLE F/G

- P3) 24" - CASTING HEIGHT - 7"
- P2) 48" - CON CONE w/24" HOLE F/G - 24"
- P1) 48" - MH BASE Custom Ht T/n - 34"
- 1) 48" - Conseal CS-102 1.00"
- 2) Hole - 26
- 5) MH Step ML-10-TDS-NCR - 10"

0 lb
 2252 lb
 3239 lb
 0 lb
 0 lb
 0 lb

 0 lb

Structure Total: 5491 lb

- Structure Notes:
1. PER ASTM C-478 SPECIFICATIONS
 2. CONCRETE: 4,000 PSI AT 28 DAYS
 3. REINFORCEMENT: PER ASTM A615
 4. STEPS REQUIRED
 5. CASTING SUPPLIED BY OTHERS

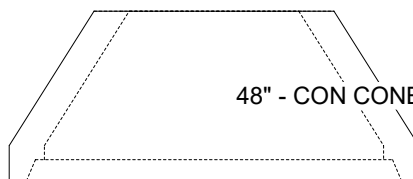
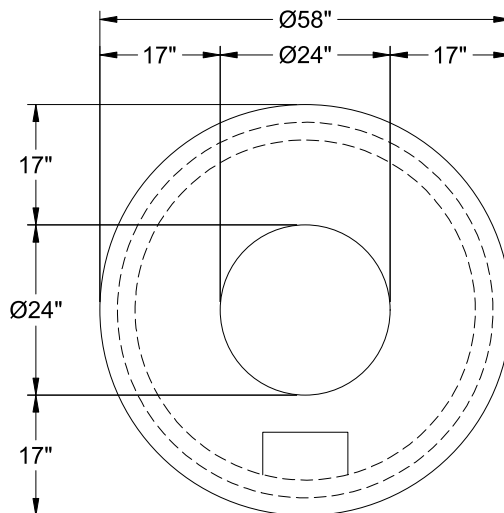

Coating (Int):
 Coating (Ext):

Seam Up: Flat
 Seam Dn: Groove

Wall Thickness: 5"

Height (Ext): 24"

Weight (Net): 2252 lb
 Volume (Net): 0.57cu.yd