

I:\QUIKRETE.NET\CONTECH\MERLIN\PROJECTS\2008\823277\823277-15-CDS\DRAWINGS\KMR EDIT - 823277-15-CDS5668-10-C-CON FAB DWG 11/10/2025 8:40 AM

25-4593 - 823277 Central Ramp Expansion BNA

015-CDS5668-10-C ADDITIONAL INFORMATION

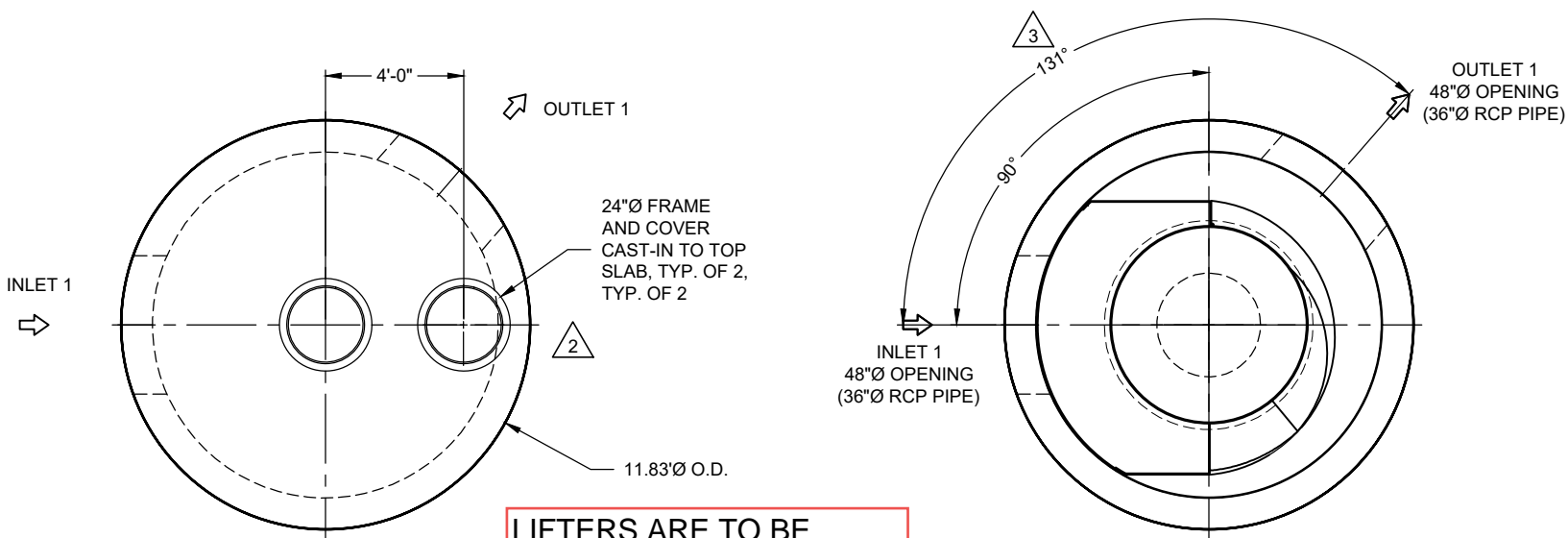

PLAN VIEW
INTERNALS NOT SHOWN

PLAN VIEW FOR PIPE ORIENTATION
TOP SLAB NOT SHOWN

LIFTERS ARE TO BE PLACED ON THE INSIDE OF THE PRECAST SECTIONS

INTERNAL COMPONENTS TO BE INSTALLED ON SITE BY CONTECH FIELD CONSULTANT. PRECASTER TO SHIP ALL INTERNAL COMPONENTS WITH STRUCTURE

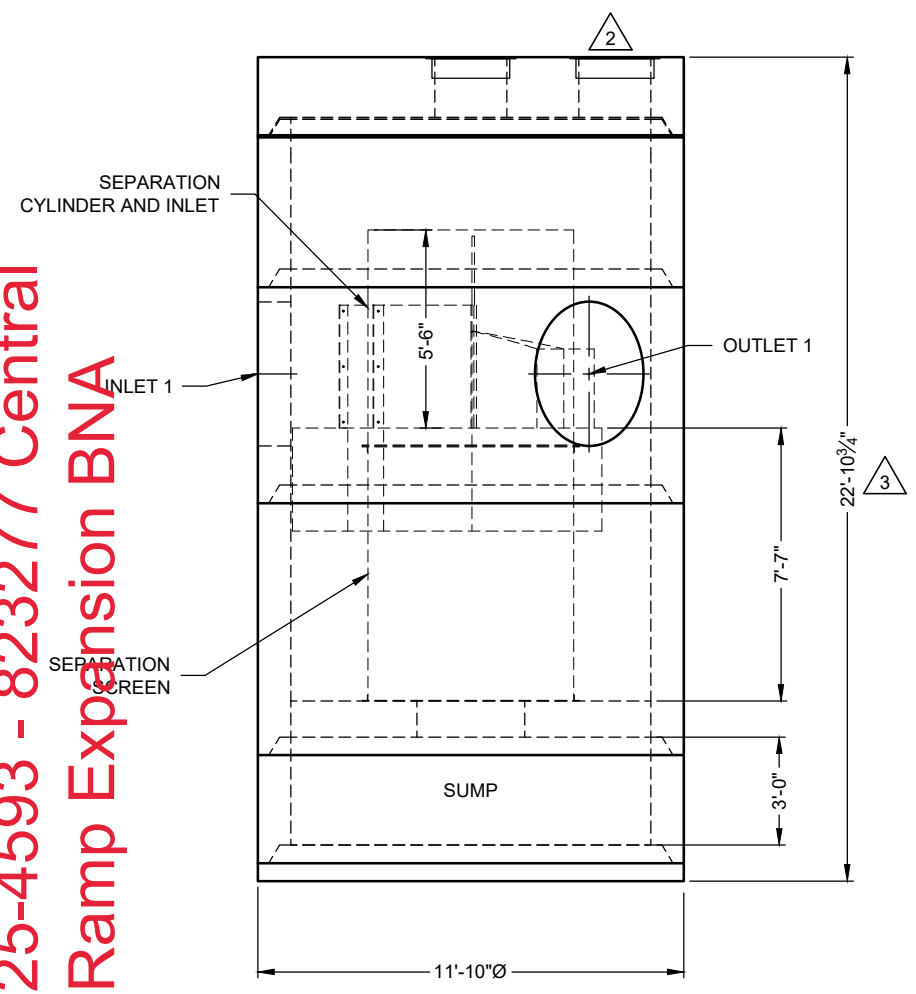

ELEVATION VIEW

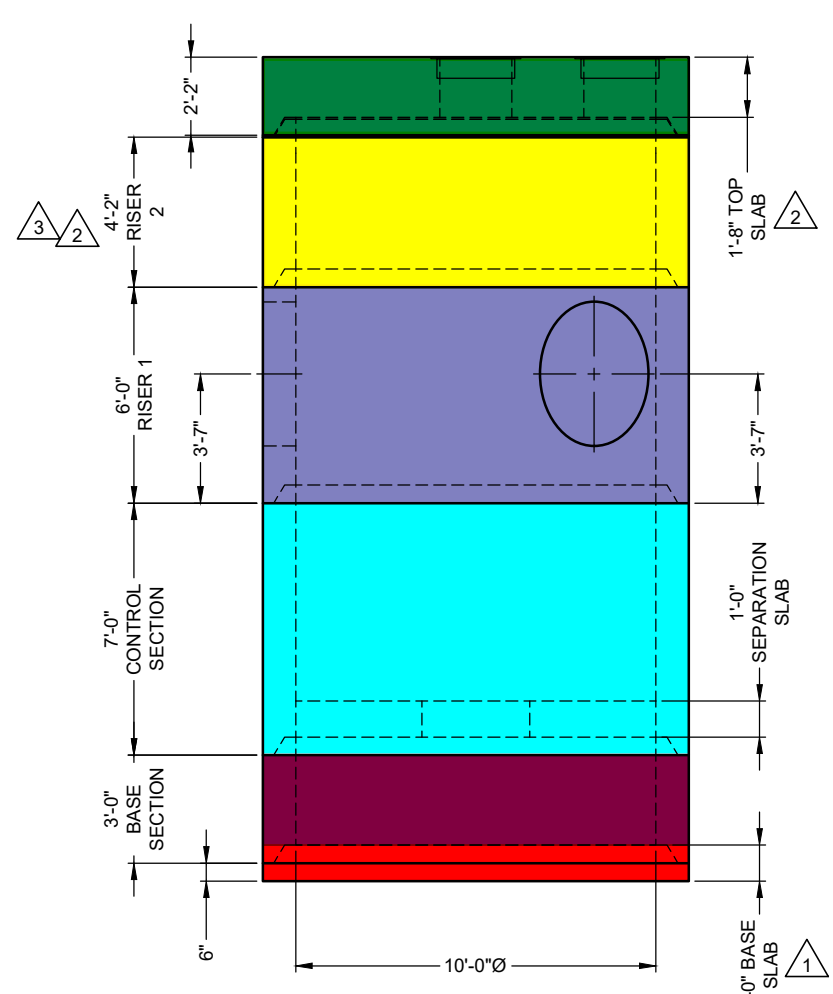

PRECAST COMPONENTS
INTERNALS NOT SHOWN

MATERIAL LIST

COUNT	DESCRIPTION	PART NUMBER	PROVIDED BY	INSTALLED BY
1	5668-10 CONCENTRIC FIBERGLASS INSERT	325-000799	CONTECH	CONTRACTOR
1	5668, 2400 micron, 5.71' O.D. x 7.08' SCREEN, GREEN FLANGE UP	335-000396	CONTECH	CONTRACTOR
1	56 SERIES HARDWARE KIT	325-003922	CONTECH	CONTRACTOR
1	SEALANT FOR JOINTS		PRECASTER	CONTRACTOR
3 2	24"Ø FRAME AND COVER, EJ# 00190522B01, CAST-IN	SNOWFLAKE	CONTECH	PRECASTER

- GENERAL NOTES**
- DESIGN LOADING - AIRPORT LOAD RATING (80KIP WHEEL LOADS WITH TIRE FOOTPRINT OF 17.19"x12.68")
 - ALL PRECAST CONCRETE MANUFACTURED PARTS SHALL CONFORM TO ASTM C-478, WITH MINIMUM CONCRETE STRENGTH OF 7000 PSI AT 28 DAYS
 - JOINT SEALANT SHALL CONFORM TO ASTM C-990 OR ASTM C-443
 - GROUND WATER ASSUMED AT OUTLET INVERT
 - MANUFACTURING TOLERANCE = +/- 1/2-INCH
 - SOME HIDDEN LINES MAY BE OMITTED FOR CLARITY

- INSTALLATION NOTES**
- PRECASTER TO CAST ACCESS FRAME INTO TOP SLAB AND SHIP COVER WITH STRUCTURE
 - REFER TO CONTECH ASSEMBLY INSTRUCTIONS FOR ADDITIONAL INFORMATION
 - FOR PROPER SCREEN ORIENTATION, FLANGE IS COLOR CODED, INSTALL GREEN FLANGE UP
 - IF REQUIRED, PVC HYDRAULIC SHEAR PLATE IS PLACED ON SEPARATION SLAB AT BOTTOM OF SCREEN CYLINDER
 - PRECASTER TO INSTALL INTERNAL COMPONENTS PRIOR TO SHIPPING UNLESS INSTRUCTED OTHERWISE BY CONTECH
 - PIPE OPENINGS SHALL BE STENCILED "INLET" OR "OUTLET" AS APPROPRIATE
 - APPLYING ALIGNMENT MARKS ON ALL PIECES OF MULTIPLE ASSEMBLIES IS HIGHLY ENCOURAGED
 - IF STRUCTURE IS DELIVERED IN MULTIPLE SECTIONS, EACH PIECE SHALL BE LABELED WITH THE CONTECH PROJECT NUMBER, SEQUENCE NUMBER AND SITE DESIGNATION

SITE INFORMATION

RIM ELEV. = 553.59+/-
TOP OF STRUCTURE ELEV. = 553.59
INLET PIPE 1 INVERT ELEV. = 543.29
INLET PIPE 1 DIAMETER AND MATERIAL = 36" RCP
OUTLET PIPE 1 INVERT ELEV. = 543.29
OUTLET PIPE 1 DIAMETER AND MATERIAL = 36" RCP
OUTSIDE BOTTOM OF STRUCTURE ELEV. = 530.71

STRUCTURE WEIGHT
APPROXIMATE HEAVIEST PICK = 44000 LBS.
STRUCTURE IS DELIVERED IN 6 PIECES

- TOP SLAB = 27500 LBS.
- RISER 2 = 20500 LBS.
- RISER 1 = 27000 LBS.
- CONTROL SECTION = 44000 LBS.
- BASE RISER = 16000 LBS.
- BASE SLAB = 16000 LBS.

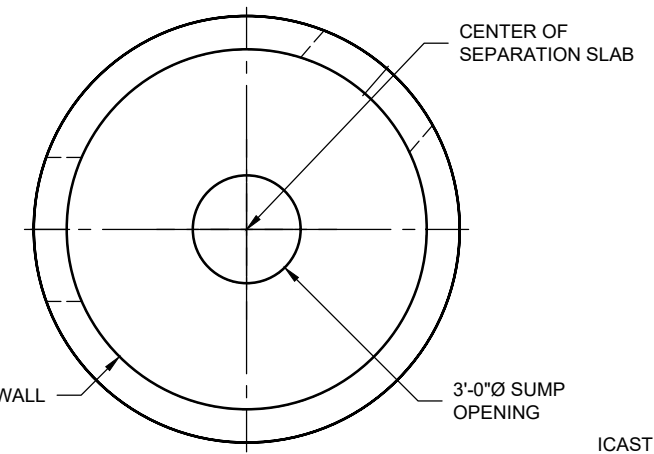

SEPARATION SLAB

CONTECH
FABRICATION
DRAWING

ICAST
5888 / 757440
LAYOUT 1G
71.99 TS

The design and information shown on this drawing is the property of CONTECH Engineered Solutions LLC. It is to be used only for the project and site conditions for which it was prepared. It is not to be used for any other project, site, or conditions without the written consent of CONTECH. Failure to comply with these conditions may result in the user's own risk and CONTECH expressly disclaims any liability or responsibility for such use. If discrepancies between the supplied information upon which the drawing is based and actual field conditions are encountered as site work progresses, these are to be immediately reported to the design engineer. CONTECH immediately reserves the right to modify the design. CONTECH accepts no liability for designs based on missing, incomplete or inaccurate information supplied by others.

MARK	DATE	REVISION DESCRIPTION	BY
3	11/10/25	PIPE SIZE & ANGLE, ELEVATIONS	DWB
2	10/14/25	FLUSH MOUNT	KMR
1	8/28/25	STRUCTURAL DESIGN CHANGES	BEC

CDS5668-10-C - 823277-015
CENTRAL RAMP EXPANSION PACKAGE 2
NASHVILLE, TN
SITE DESIGNATION: HS-B

CONTECH
ENGINEERED SOLUTIONS LLC
 www.conteches.com
 2528 Ridge Road, Hoover, AL 36036
 404-497-1500 410-740-9490 410-740-3482 FAX

FOR PATENT INFORMATION, GO TO www.conteches.com/IP

DESIGNED:	MJS	DRAWN:	DWB
CHECKED:	MJS	APPROVED:	MJS
PROJECT No.:	823277	SEQUENCE No.:	015
SHEET:	1	OF	2

DATE: 6/18/25

25-4593 - 823277 Central Ramp Expansion BNA 2450ZPT 1905APT DI Assembly

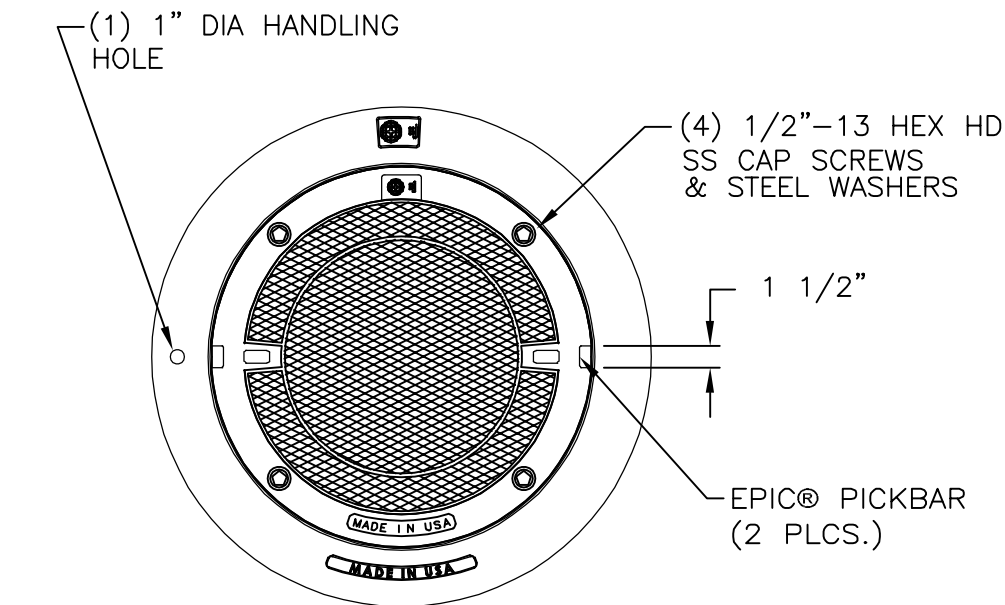

PLAN VIEW

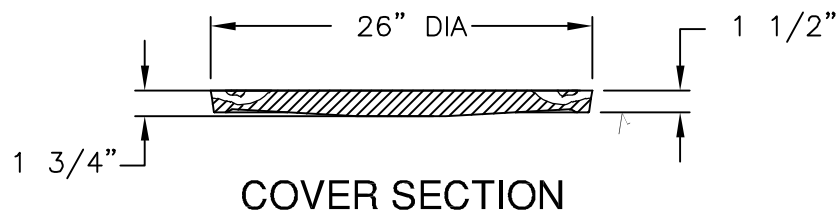

COVER SECTION

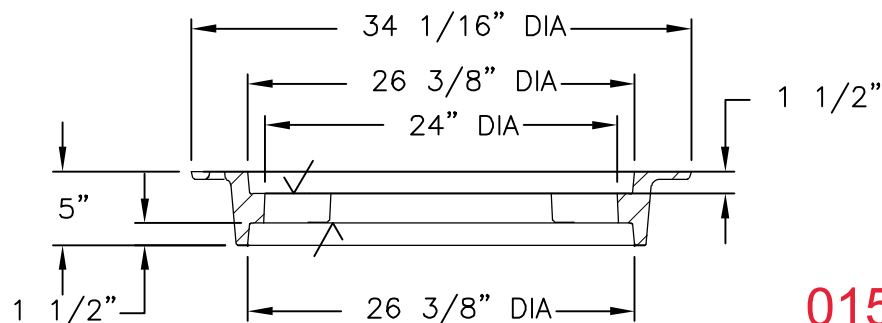

FRAME SECTION

Product Number
00190522B01

Design Features

- Materials
 - Frame
Gray Iron (CL35B)
 - Cover
Ductile Iron (70-50-05)

- Load Rating
Airport Extra Heavy Duty
- Open Area
n/a
- Coating
Undipped
- √ Designates Machined Surface

Certification

- ASTM A48
- ASTM A536
- Country of Origin: USA

Major Components

00245013
00190522

Drawing Revision

5/20/2020 Designer: MAH
6/11/2024 Revised By: MAH

Disclaimer

Weights (lbs./kg) dimensions (inches/mm) and drawings provided for your guidance. We reserve the right to modify specifications without prior notice.

CONFIDENTIAL: This drawing is the property of EJ GROUP, Inc., and embodies confidential information, registered marks, patents, trade secret information, and/or know how that is the property of EJ GROUP, Inc. Copyright © 2012 EJ GROUP, Inc. All rights reserved.

Contact

800 626 4653
ejco.com

**015-CDS5668-10-C
ADDITIONAL INFORMATION**