

**Structure ID: 85-CDS4045-8-C**

**P2 MH096RS48**

**MH RISER T/G**

P6) 24" - CASTING HEIGHT - 4" P5) 96" - MH FLAT TOP SPEC. (2 - 24"Ø HOLES) F/G - 17" P4) 96" - MH RISER T/G - 48" P3) 96" - MH RISER T/G - 60" P2) 96" - MH RISER T/G - 48" P1) 96" - MH MONOBASE 13F, Custom Ht T/n - 36" 1) SECONDARY POUR - SEPARATION SLAB 1) ASSEMBLY REQUIRED 1) CVSTENCILING 1) SECONDARY POUR - 96" MH BASE FLOOR POUR 4) 96" - Conseal CS-102 1.00" 1) Hole - 64 1) Hole - 58	0 lb 10015 lb 10698 lb 11469 lb 11958 lb 20103 lb 3334 lb 0 lb 0 lb 0 lb 0 lb 0 lb 0 lb ----- 67577 lb
--	--

**Structure Notes:**

1. PER ASTM C-478 SPECS
2. CONCRETE: 4,500 PSI AT 28 DAYS
3. REINFORCEMENT: PER ASTM A615
4. 2 EA. 4" TALL CASTINGS PROVIDED BY OTHERS

**SPECIAL NOTES:**

1. LIFTING HOOKS TO BE INSTALLED ON THE OUTSIDE OF THE STRUCTURE
2. CONTECH'S LOGO AS WELL AS THE INLET & OUTLET MUST BE STENCILED ONTO THE STRUCTURE
3. ICAST TO INSTALL THE INTERNALS
4. CONTROL RISER (P2) TO BE MECHANICALLY ATTACHED TO THE BOTTOM OF RISER 1 (P3)

Structure Total: 67577 lb

Rim: 880.39'    Rim to Invert: 9.04'    Slack: 3.48"    Sump: 108"    Step Position:

Position	Elev	Angle	Ext. (cw)	Pipe	Pipe OD	Connector	Hole	Horz Size	Up ( )	Offset
Invert 1										
Invert 2										
Invert 3										
Invert 4										
Invert 5										
Invert 6										
Invert 7										
Invert 8										

**RIGHT-SIDE UP VIEW (int. dimensions)**

**FIRST POUR (48" RISER):  
11,958 LBS  
(PAGE 1 OF 2 / THIS PAGE)**

**SECOND POUR  
(SEPARATION SLAB):  
3,334 LBS  
(PAGE 2 OF 2)**

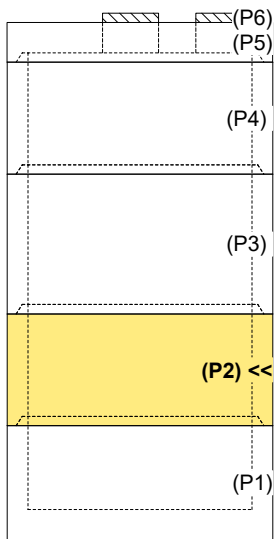
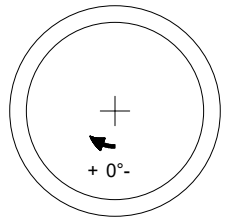

**INSIDE WALL DIMENSIONS**

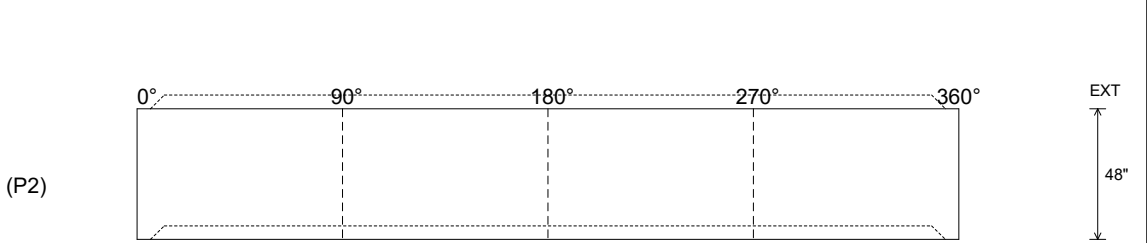

Coating (Int): Coating (Ext):	Seam Up: Tongue Seam Dn: Groove	Wall Thickness: 9" Floor Height: 0"	Height (Int): 48" Height (Ext): 48"	Weight (Net): 11958 lb Volume (Net): 3.05cu.yd
----------------------------------	------------------------------------	--	--	---

**GENERAL NOTES:**

1. MANUFACTURED TO ASTM C-913 (LATEST REVISION)
2. CONCRETE: 4,500 PSI AT 28 DAYS
3. REINFORCEMENT:
  - A) DRILL & DOWEL 16" LONG #5 STRAIGHT BARS (GRADE 60) @ 8" C.C. - MIN. 4" PENETRATION INTO WALLS & MIN. 2" REBAR CLEARANCE (TYP)
  - B) SLAB MAT: #5 BAR @ 12" C.C. E.W. (GRADE 60) - 2" MIN. REBAR CLEARANCE (TYP)
4. TOTAL WEIGHT: 15,292 LBS
  - A) FIRST POUR (48" RISER): 11,958 LBS
  - B) SECOND POUR (6" SEPARATION SLAB): 3,334 LBS
5. JOINT SEALANT: CONCRETE SEALANTS CS-102 1.00" BUTYL
6. CONTECH'S LOGO AS WELL AS INLETS & OUTLETS MUST BE STENCILED ONTO STRUCTURE
7. PRIOR TO SEPARATION SLAB POUR, PRODUCTION IS TO PLACE ONE ROW OF CS-231 1.00" BUTYL AS SHOWN TO CREATE WATERTIGHT SEAL
8. SEE PAGE 1 OF 2 FOR FIRST POUR (48" RISER) DETAILS

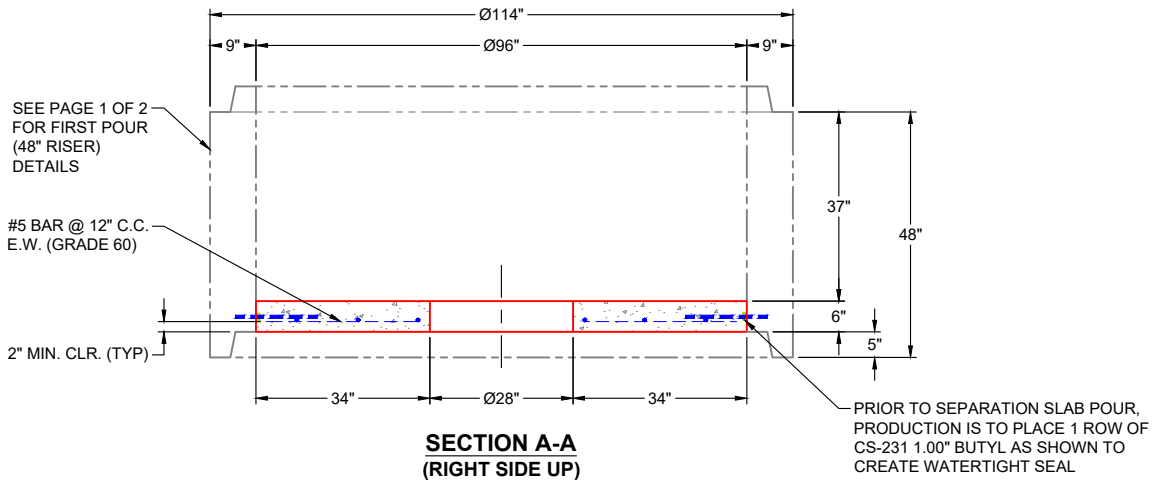
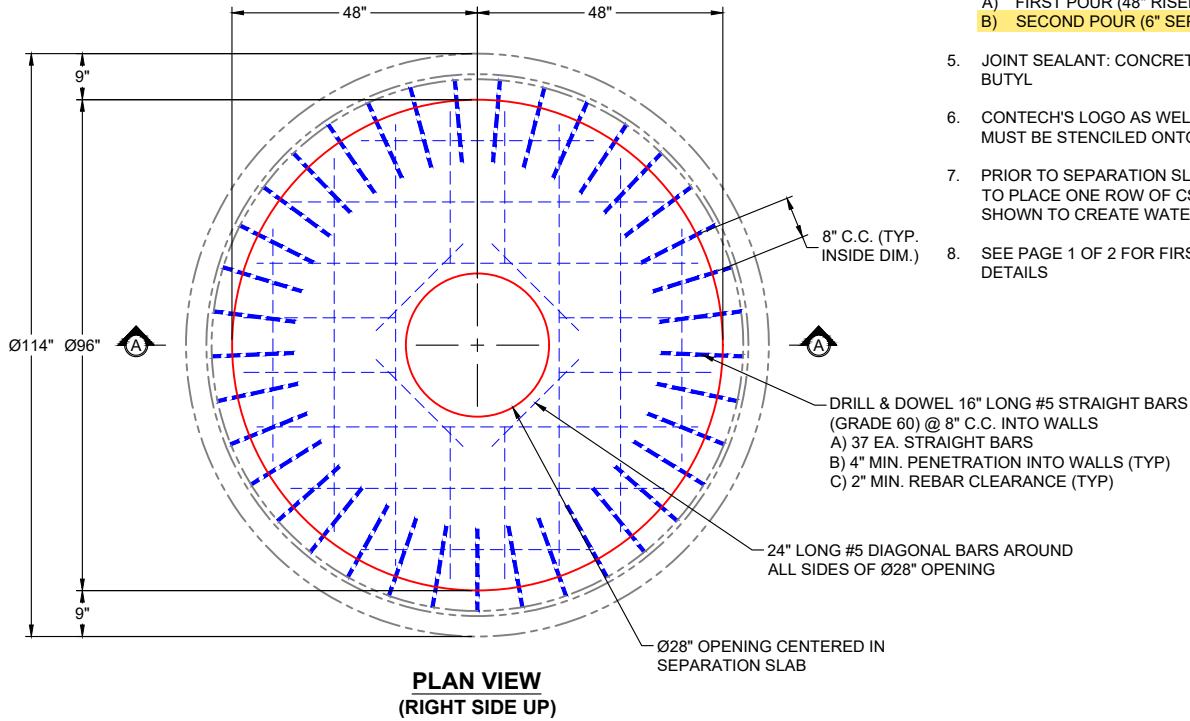

<b>PRODUCTION WORK ORDER</b>		PRODUCT I.D.: MH096RS48	DESCRIPTION: Ø96" MH SEPARATION SLAB, 6" HT.	
	QUALITY CONTROL CHECKLIST	PRODUCT VIEW: RIGHT SIDE UP	CUSTOMER: CONTECH ENGINEERING SOLUTIONS	
	<input type="checkbox"/> ALL DIMENSIONS CORRECT.	PLANT: BEAVER DAM, KY	PROJECT: 863626 PROJECT TAHOE	
	<input type="checkbox"/> LIFTERS INSTALLED.	WEIGHT: 15,292 LBS (TOTAL)	STRUCTURE: 85-CDS4045-8-C	
	<input type="checkbox"/> HOLE LOCATION(S) CORRECT.	TOP SECTION JOINT: N / A	QUOTE / SALES ORDER NO: 25-4537	
	<input type="checkbox"/> REINFORCING CORRECT.	BASE SECTION JOINT: N / A	PE: J.H. ROSS	DRAWN BY: K. CARDWELL
	<input type="checkbox"/> FINISH ON SURFACE UNIFORM.	QC CHECK INITIALS:	DATE: 11/21/25	SCALE: NTS
<input type="checkbox"/> OUTSIDE TOP EDGE TROWELLED.			PG. 2 OF 2	
<input type="checkbox"/> GROOVE JOINT INSTALLED.				