

PLAN VIEW

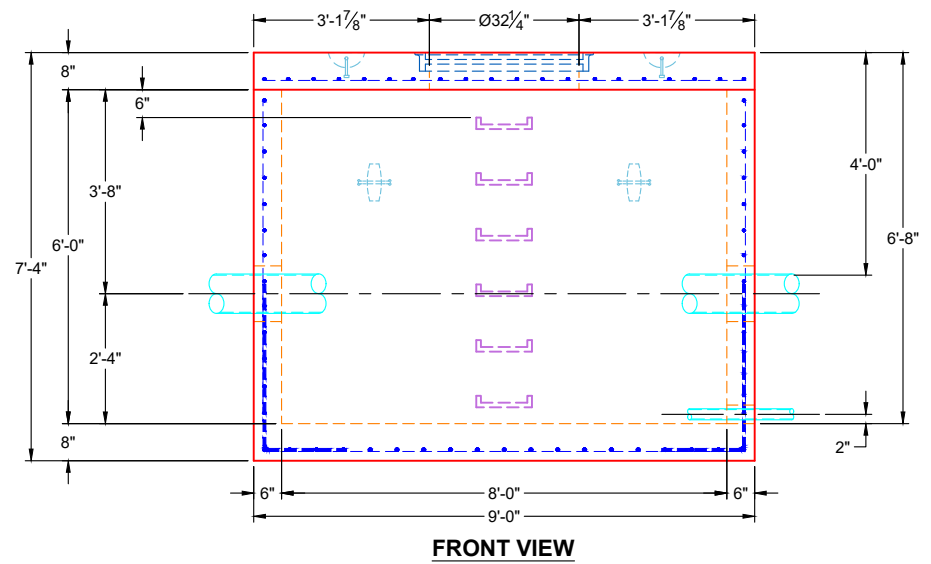

FRONT VIEW

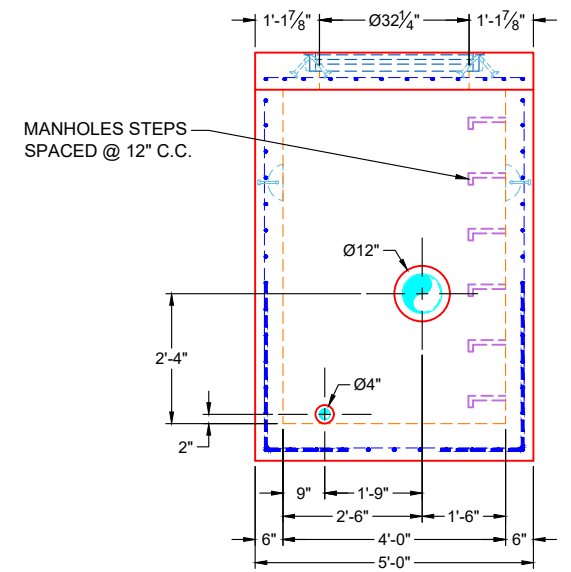

SIDE VIEW

GENERAL NOTES:

1. MANUFACTURED PER ASTM C-913 SPECIFICATIONS
2. CONCRETE: 5,000 PSI AT 28 DAYS
3. REINFORCEMENT:
 - FLAT LID: #5 BAR @ 6" C.C. E.W. (GRADE 60)
 - BASE WALLS: #5 BAR @ 6" C.C. E.W. (GRADE 60)
 - BASE FLOOR: #6 BAR @ 6" C.C. E.W. (GRADE 60)
4. WEIGHTS:

8" FLAT LID	4,080 LBS
72" BASE (6" WALLS, 8" FLOOR)	15,540 LBS
TOTAL WEIGHT	19,620 LBS
5. HOE MCS-455 FRAME & PLAIN COVER SUPPLIED BY ICAST - FRAME TO BE CAST INTO FLAT LID FLANGE SIDE UP
6. JOINT SEALANT: CONSEAL CS-102 - 1" (PRIMARY & SECONDARY ROWS)
7. ANY REQUIRED COATINGS, LINERS, OR ADMIXTURES TO BE SUPPLIED BY OTHERS
8. MANHOLE STEPS REQUIRED
9. LINK-SEAL CONNECTORS SUPPLIED BY OTHERS

REVISION INFORMATION

REV.	DATE:	NO REVISIONS TO DATE



SUBMITTAL DRAWING: 48" X 96" MASTER METER VAULT		
CUSTOMER: D-PORT DIRECTIONAL DRILLING & UTILITIES		
PROJECT: KUTTAWA & EDDYVILLE WATER INTERCONNECT		
STRUCTURE: MMV (4)		
QUOTE/SALES ORDER NO: 25-4530		
CHECKED BY: B. SMITH	DRAWN BY: FORMONIC	
DATE: 02/19/26	SCALE: NTS	PG. 1 OF 1