

PLAN VIEW

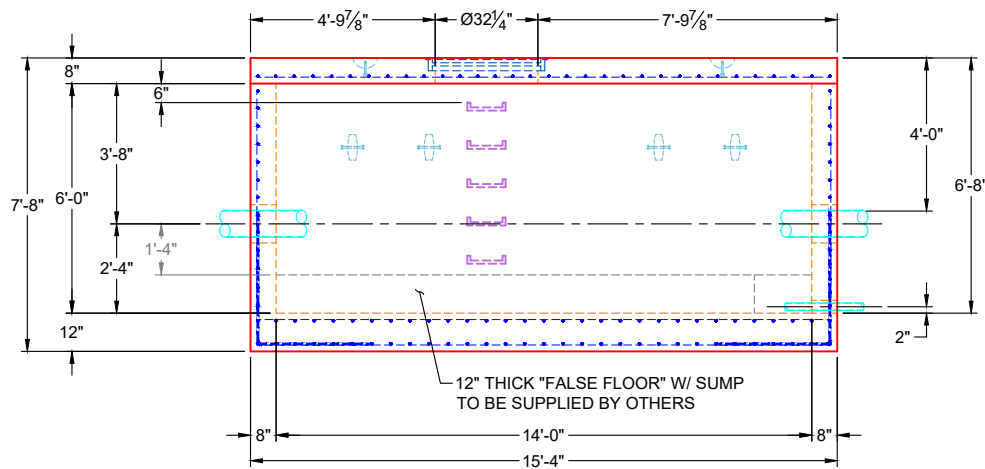

FRONT VIEW

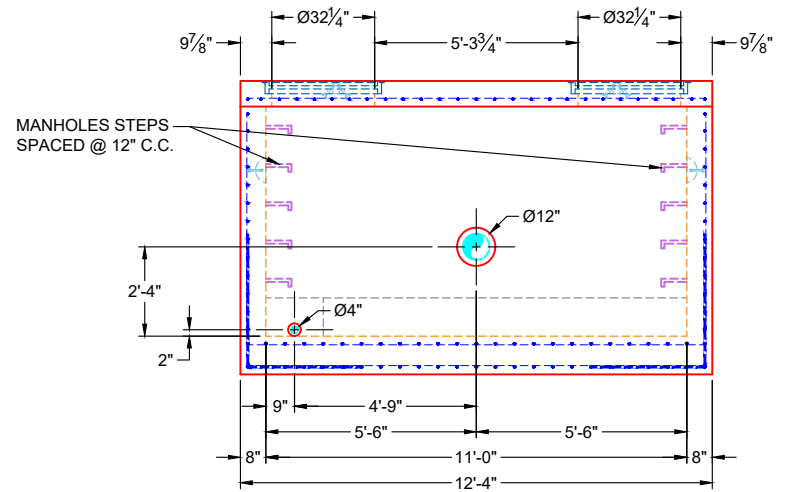

SIDE VIEW

GENERAL NOTES:

1. MANUFACTURED PER ASTM C-913 SPECIFICATIONS
2. CONCRETE: 5,000 PSI AT 28 DAYS
3. REINFORCEMENT:
 - FLAT LID: #5 BAR @ 6" C.C. E.W. (GRADE 60)
 - BASE WALLS: #5 BAR @ 6" C.C. E.W. (GRADE 60)
 - BASE FLOOR: DOUBLE MAT #6 BAR @ 6" C.C. E.W. (GRADE 60)
4. WEIGHTS:

8" FLAT LID	17,735 LBS
72" BASE (8" WALLS, 12" FLOOR)	57,807 LBS
TOTAL WEIGHT	75,533 LBS
5. 2 EA. HOE MCS-455 FRAMES & PLAIN COVERS SUPPLIED BY ICAST - FRAMES TO BE CAST INTO FLAT LID FLANGE SIDE UP
6. JOINT SEALANT: CONSEAL CS-102 - 1" (PRIMARY & SECONDARY ROWS)
7. ANY REQUIRED COATINGS, LINERS, OR ADMIXTURES TO BE SUPPLIED BY OTHERS
8. MANHOLE STEPS REQUIRED
9. LINK-SEAL CONNECTORS SUPPLIED BY OTHERS
10. 12" THICK "FALSE FLOOR" W/ SUMP TO BE SUPPLIED BY OTHERS

REVISION INFORMATION

REV. DATE: NO REVISIONS TO DATE



SUBMITTAL DRAWING: 132" X 168" MASTER METER VAULT

CUSTOMER: D-PORT DIRECTIONAL DRILLING & UTILITIES

PROJECT: KUTTAWA & EDDYVILLE WATER INTERCONNECT

STRUCTURE: MMV (3)

QUOTE/SALES ORDER NO: 25-4530

CHECKED BY: B. SMITH

DRAWN BY: FORMONIC

DATE: 02/19/26

SCALE: NTS

PG. 1 OF 1