

Job Name: 25-4530 - Kuttawa & Eddyville Water Interconnect  
 Job Location: Kuttawa, KY  
 Contractor: D-Port Directional Drilling & Utilities

Plant: 100  
 2/19/2026 1:22:09 PM

Tech: J. Horsley - F  
 PC: T. Lewis



**Structure ID: AR (2)**

**P4 GR3**

**GRADE RING F/F**

- P5) 24" - CASTING HEIGHT - 7"
- P4) 24" - GRADE RING F/F - 3"
- P3) 48" - MH FLAT TOP w/ 24" ECC Hole F/G - 12"
- P2) 48" - MH DH RISER T/F - 48"
- P1) 48" - P.I.P. BY OTHERS - BTM SLAB F/n - 0"
- 1) CASTING - EJ 1020B Vented Cover Water
- 1) CASTING - HOE MC-315 F/C Water
- 2) 48" - Conseal CS-102 1.00" (Double)
- 2) DOGHOUSE - 12"x12"
- 4) MH Step ML-10-TDS-NCR - 10"

0 lb  
 202 lb  
 1561 lb  
 3244 lb  
 0 lb  
 250 lb  
 258 lb  
 0 lb  
 0 lb  
 0 lb  
 -----  
 Structure Total: 5516 lb

- Structure Notes:
1. PER ASTM C-478 SPECIFICATIONS
  2. CONCRETE: 4,000 PSI AT 28 DAYS
  3. REINFORCEMENT: (1) #3 HOOP CENTERED (GRADE 60)

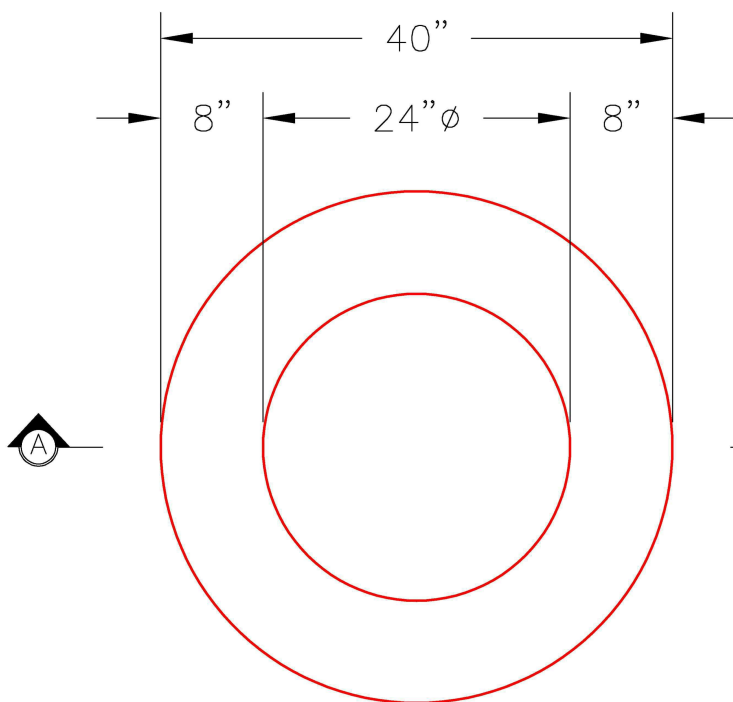

**PLAN VIEW**

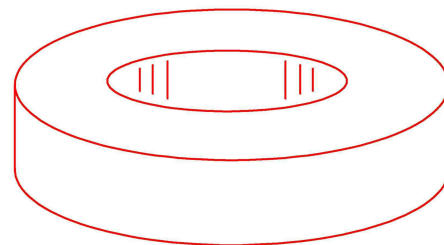

**ISOMETRIC VIEW**

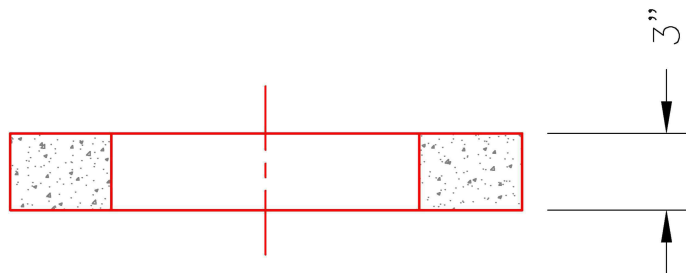

**SECTION A-A**

Coating (Int):  
 Coating (Ext):

Seam Up: Flat  
 Seam Dn: Flat

Wall Thickness: 8"

Height (Ext): 3"

Weight (Net): 202 lb  
 Volume (Net): 0.05cu.yd