

Job Name: 25-4438 - Carson St MH
 Job Location: CPU
 Contractor: Luttrell & Sons, LLC

Plant: Beaver Dam, KY

Tech: K. Cardwell

11/15/2025 9:34:48 AM

PC: T. Lewis



Structure ID: 54438 (2)

P2 MH048CN24

ECC CONE w/ 24" HOLE F/G

- P4) 24" - CASTING HEIGHT - 7"
- P3) 24" - GRADE RING F/F - 4"
- P2) 48" - ECC CONE w/ 24" HOLE F/G - 24"
- P1) 48" - MH BASE T/n - 24"
- 1) JOINT WRAP PRIMER - CONSEAL CS-75 (1 gal.)
- 1) JOINT WRAP - 0.065"x6"x50' CONSEAL CS212
- 1) 48" - MH INVERT CHANNEL - FULL HEIGHT
- 1) CASTING - HOE MC-375 F/C Sanitary
- 1) 48" - Conseal CS-102 1.00" (Double)
- 1) PSX - 12-08 NYLO
- 1) PSX - 8QRS-S NYLO
- 3) MH Step ML-10-TDS-NCR - 10"

- 0 lb
- 270 lb
- 1550 lb
- 2938 lb
- 0 lb
- 0 lb
- 1440 lb
- 271 lb
- 0 lb
- 8 lb
- 6 lb
- 0 lb

Structure Notes:
 1. PER ASTM C-478 SPECS
 2. CONCRETE: 4,500 PSI AT 28 DAYS
 3. REINFORCEMENT: PER ASTM A615
 4. INVERT CHANNEL REQUIRED
 5. STEPS AT 0 DEGREES
 6. HOE MC-375 FRAME & COVER "SANITARY" SUPPLIED BY ICAST

Structure Total: 6483 lb

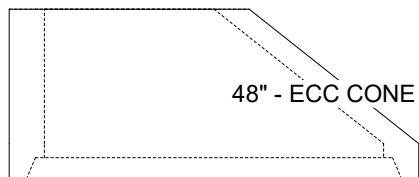
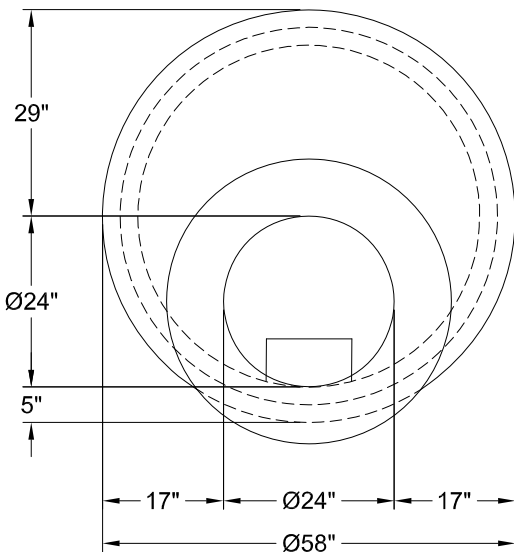

48" - ECC CONE w/ 24" HOLE F/G - 24" - (P2)

Coating (Int):
 Coating (Ext):

Seam Up: Flat
 Seam Dn: Groove

Wall Thickness: 5"

Height (Ext): 24"

Weight (Net): 1550 lb
 Volume (Net): 0.33cu.yd