

Job Name: 25-4436 - Chipotle Carriage Gate  
 Job Location: Richmond, KY 40475  
 Contractor: Lagco Inc.

Plant: 100

2/24/2026 8:58:53 AM

Tech: J. Horsley - A

PC: Celina Goff



**Structure ID: ST-2 (3) Rev**

**P1 BX3654-08BAVF**

**BOX BASE 8inW, 8inF, Variable Ht F/n**

- P3) 24" - CASTING HEIGHT - 4"
- P2) 36" x 54" - BX FLAT LID 8inW w/24in Hole F/F - 8"
- P1) 36" x 54" - BOX BASE 8inW, 8inF, Variable Ht F/n - 23"
- 1) CASTING - HOE MCB-295-BH F/G
- 1) SECONDARY POUR
- 1) 36" x 54" - Conseal CS-102 1.00"
- 1) Hole - 20
- 1) Hole - 16

0 lb  
 2140 lb  
 5371 lb  
 239 lb  
 0 lb  
 0 lb  
 0 lb  
 0 lb  
 -----  
 Structure Total: 7750 lb

Structure Notes:

1. PER ASTM C-913 SPECIFICATIONS
2. CONCRETE: 4,000 PSI AT 28 DAYS
3. REINFORCEMENT: #5 BAR @ 6" C.C. E.W. (GRADE 60) - 2" MIN. REBAR CLEARANCE (TYP)
4. NO STORM INVERT
5. NO STEPS
6. HOE MCB-295-BH FRAME & BEEHIVE GRATE SUPPLIED BY ICAST
7. WET STICK 18" X 18" #5 L-BARS SPACED @ 12" C.C. (GRADE 60) OUT OF FLOOR FOR WALL POUR TIE-IN (SEE L-BAR DETAIL)

**FIRST POUR (FLOOR): 2,444 LBS**  
**SECOND POUR (WALLS): 2,927 LBS**

Rim: 935' Rim to Invert: 2.99' Slack: 0.88" Sump: 0" Step Position:

Position	Elev	Angle	Ext. (cw)	Pipe	Pipe OD	Connector	Hole	Horz Size	Up ( )	Offset
Invert 1	932.01'	180°	26"	15" HDPE	17.6"	Hole 20	20"	20"	-1.25"	0"
Invert 2	932.26'	90°	35"	12" HDPE	14.5"	Hole 16	16"	16"	1.75"	0"
Invert 3										
Invert 4										
Invert 5										
Invert 6										
Invert 7										
Invert 8										

**RIGHT-SIDE UP VIEW (int. dimensions)**

**UPSIDE-DOWN VIEW (int. dimensions)**

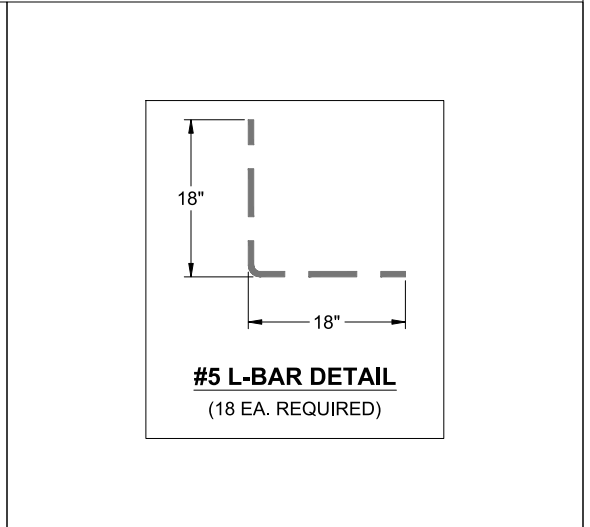
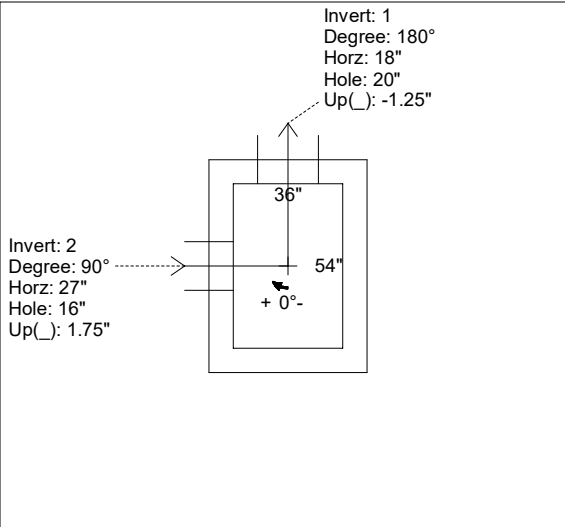
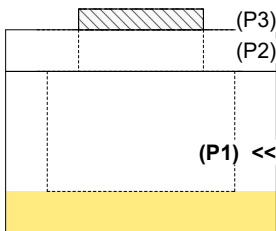

**INSIDE WALL DIMENSIONS**

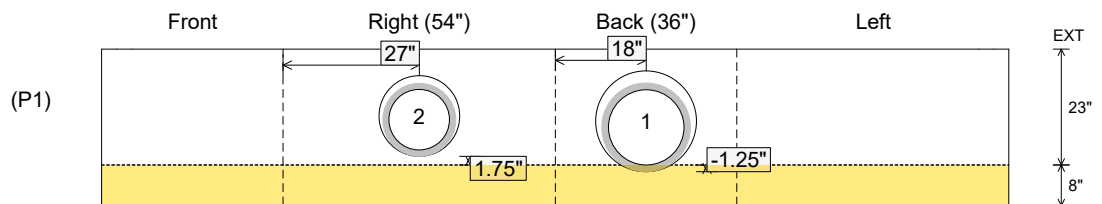

Coating (Int):  
 Coating (Ext):

Seam Up: Flat  
 Seam Dn: n/a

Wall Thickness: 8"  
 Floor Height: 8"

Height (Int): 23"  
 Height (Ext): 31"

Weight (Net): 5371 lb  
 Volume (Net): 1.37cu.yd

Job Name: 25-4436 - Chipotle Carriage Gate  
 Job Location: Richmond, KY 40475  
 Contractor: Lagco Inc.

Plant: 100  
 2/24/2026 8:58:53 AM

Tech: J. Horsley - A  
 PC: Celina Goff



**Structure ID: ST-2 (3) Rev**

**P1 BX3654-08BAVF**

**BOX BASE 8inW, 8inF, Variable Ht F/n**

- P3) 24" - CASTING HEIGHT - 4"
- P2) 36" x 54" - BX FLAT LID 8inW w/24in Hole F/F - 8"
- P1) 36" x 54" - BOX BASE 8inW, 8inF, Variable Ht F/n - 23"
- 1) CASTING - HOE MCB-295-BH F/G
- 1) SECONDARY POUR
- 1) 36" x 54" - Conseal CS-102 1.00"
- 1) Hole - 20
- 1) Hole - 16

0 lb  
 2140 lb  
 5371 lb  
 239 lb  
 0 lb  
 0 lb  
 0 lb  
 0 lb  
 -----  
 Structure Total: 7750 lb

- Structure Notes:
1. PER ASTM C-913 SPECIFICATIONS
  2. CONCRETE: 4,000 PSI AT 28 DAYS
  3. REINFORCEMENT: #5 BAR @ 6" C.C. E.W. (GRADE 60) - 2" MIN. REBAR CLEARANCE (TYP)
  4. NO STORM INVERT
  5. NO STEPS
  6. HOE MCB-295-BH FRAME & BEEHIVE GRATE SUPPLIED BY ICAST
  7. LIFTERS: 4 EA. 4CA14 CONAC A-ANCHORS FOR PLANT & FIELD HANDLING - INSTALLED IN 90° & 270° WALLS, MIN. 10" FROM TOP OF WALLS

**FIRST POUR (FLOOR): 2,444 LBS**  
**SECOND POUR (WALLS): 2,927 LBS**

Rim: 935' Rim to Invert: 2.99' Slack: 0.88" Sump: 0" Step Position:

Position	Elev	Angle	Ext. (cw)	Pipe	Pipe OD	Connector	Hole	Horz Size	Up ( )	Offset
Invert 1	932.01'	180°	26"	15" HDPE	17.6"	Hole 20	20"	20"	-1.25"	0"
Invert 2	932.26'	90°	35"	12" HDPE	14.5"	Hole 16	16"	16"	1.75"	0"
Invert 3										
Invert 4										
Invert 5										
Invert 6										
Invert 7										
Invert 8										

RIGHT-SIDE UP VIEW (int. dimensions)

UPSIDE-DOWN VIEW (int. dimensions)

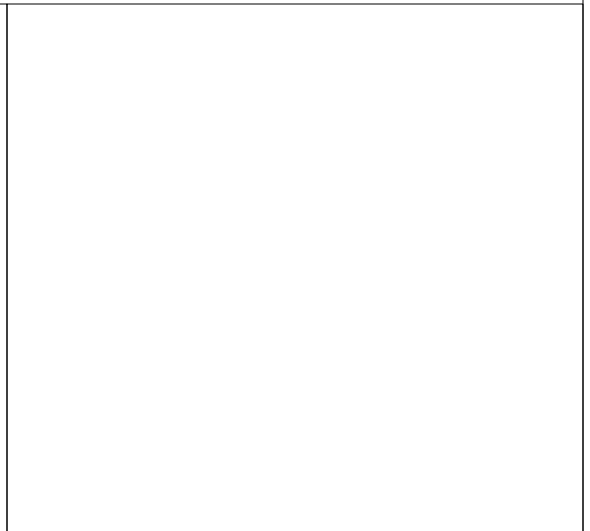
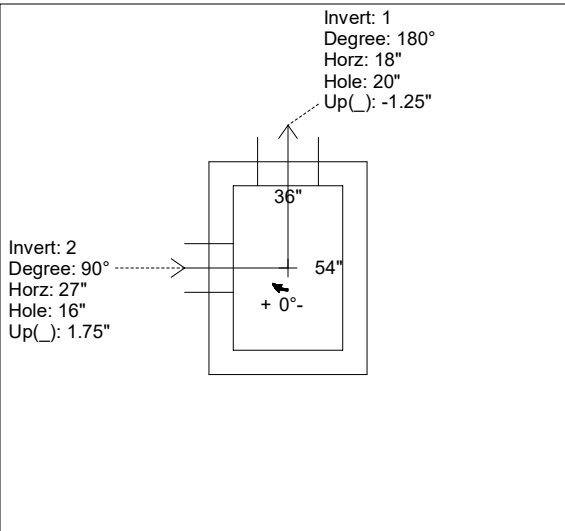
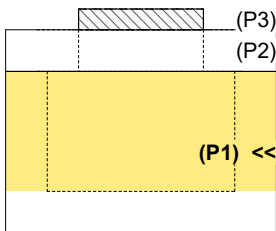

INSIDE WALL DIMENSIONS

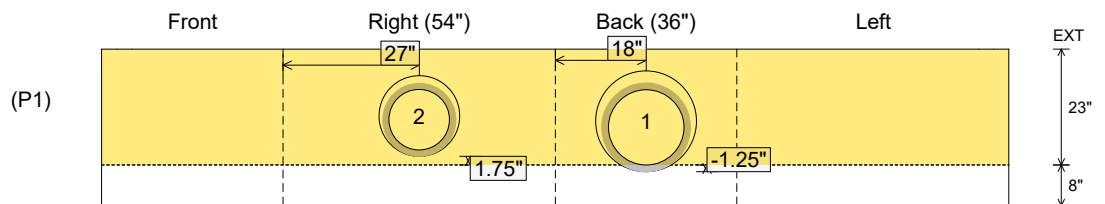

Coating (Int):  
 Coating (Ext):

Seam Up: Flat  
 Seam Dn: n/a

Wall Thickness: 8"  
 Floor Height: 8"

Height (Int): 23"  
 Height (Ext): 31"

Weight (Net): 5371 lb  
 Volume (Net): 1.37cu.yd