

**PLAN VIEW**

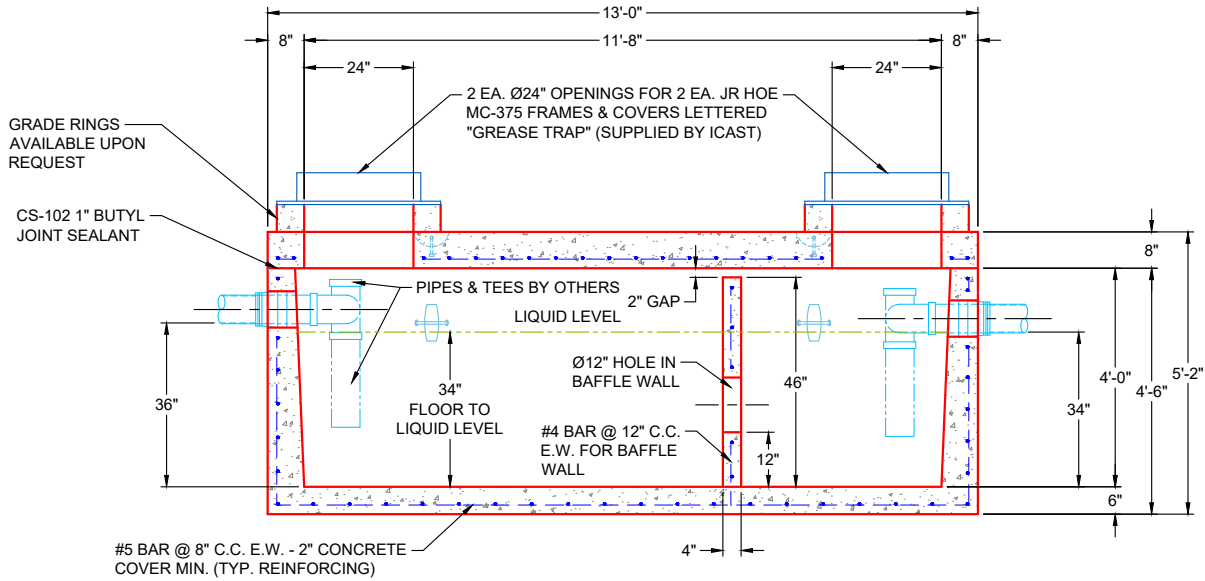

**SECTION A-A**

**STRUCTURE NOTES:**

1. MANUFACTURED PER ASTM C-890-13 LATEST REVISION
2. CONCRETE: 5,000 PSI AT 28 DAYS
3. REINFORCING PER ASTM A615 (GRADE 60)
4. SEALED PER ASTM C-990-09
5. GRADE RINGS BY REQUEST

**WEIGHTS:**

8" THICK TOP SLAB:	8,190 LBS
4'-0" TALL BASE W/ BAFFLE:	20,450 LBS
TOTAL WEIGHT:	28,640 LBS

REVISIONS	
REV. 0	DATE: NO REVISIONS TO DATE



SUBMITTAL DRAWING: 12' X 6' GREASE TRAP (1,500 GAL.)	
CUSTOMER: LAGCO INC.	
PROJECT: CHIPOTLE CARRIAGE GATE	
STRUCTURE: 54436 (9)	
SALES ORDER NO: 25-4436	
CHECKED BY: B. SMITH	DRAWN BY: K. CARDWELL
DATE: 01/27/26	SCALE: NTS
	PG. 1 OF 1