

Job Name: 25-4430 KYTC Daviess Co Call 104 (2511035)  
 Job Location: Owensboro, KY  
 Contractor: Ragle, Inc.

Plant: 100

3/11/2026 2:14:44 PM

Tech: Jared - A

PC: Andy Chambers



**Structure ID: 8941R (19)**

**P2 BX4848-08LD08**

**CB FLAT TOP 8"W w/36"X36" HOLE**

- P3) 36" x 36" - P.I.P. - BY OTHERS - 8"
- P2) 48" x 48" - CB FLAT TOP 8"W w/36"X36" HOLE - 8"
- P1) 48" x 48" - BOX BASE 8inW, 8inF, Variable Ht - 42"
- 1) CASTING - HOE KY-328 SET (DBI 3)
- 1) 48" x 48" - Conseal CS-102 1.00"
- 1) 36" x 36" - Conseal CS-102 1.00"
- 2) Hole - 38"

Structure Total:

- 0 lb Structure Notes:  
 1880 lb \*\*KYTC STATE PROJECT\*\*  
 7494 lb 1. HOE KY-328 SET (DBI 3) PROVIDED BY ICAST.  
 328 lb 2. KYTC DBI TYPE 3  
 0 lb 3. PER ASTM C-913  
 0 lb 4. DBI 3 F&G (BY CONTR)  
 0 lb 5. STUB #5 BARS 20" OUT TOP OF TOP SLAB  
 (SPA@12"C/C)  
 9701 lb 6. REINFORCING PER ASTM A615 (GRADE 60).  
 - TOP SLAB : DBL. MAT #5 #6"  
 - WALLS (As .31) #5 BARS AT 12" C.C.E.W.  
 - FLOOR (As .31) #5 BARS AT 12" C.C.E.W.

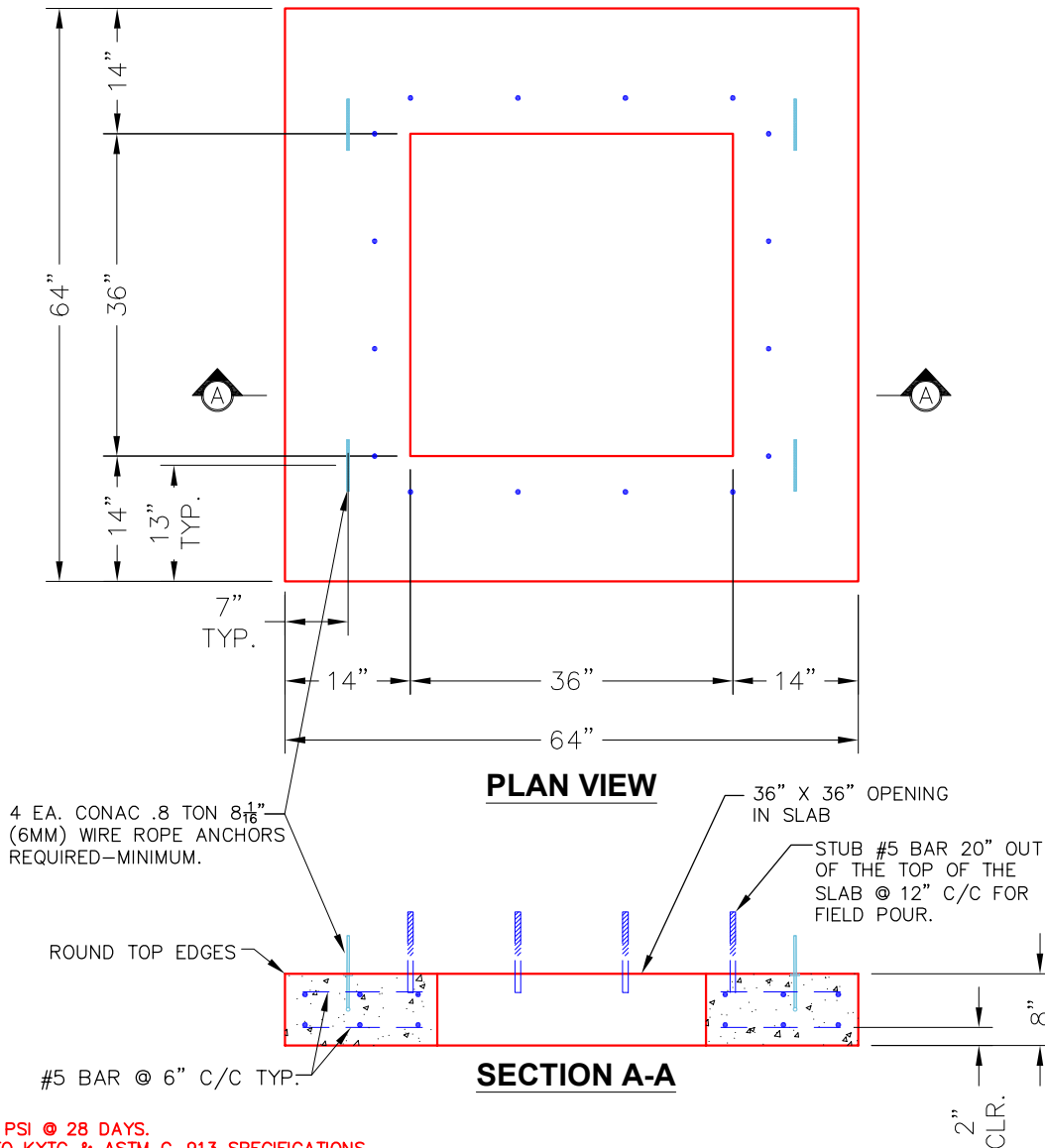

- NOTES:**
- CONCRETE: 4500 PSI @ 28 DAYS.
  - MANUFACTURED TO KYTC & ASTM C-913 SPECIFICATIONS.
  - REINFORCING: #5 BAR AS SHOWN-GRADE 60.
  - 4 EA. CONAC WIRE LOOP LIFTS REQUIRED (MIN.)
  - STUB #5 BAR 20" OUT TO OF THE SLAB (SPA @ 12" C/C)

Coating (Int):  
 Coating (Ext):

Seam Up: Flat  
 Seam Dn: Flat

Wall Thickness: 8"

Height (Ext): 8"

Weight (Net): 1880 lb  
 Volume (Net): 0.48cu.yd