

Job Name: 25-4423 - City of Madisonville Manhole
 Job Location: CPU
 Contractor: City of Madisonville

Plant: Beaver Dam, KY

Tech: K. Cardwell

12/11/2025 10:38:31 AM

PC: T. Lewis



Structure ID: 2-54423

P3 GR3CDARED

GRADE RING w/ConBlock-CDA Red F/F

- P4) 24" - CASTING HEIGHT - 7"
- P3) 24" - GRADE RING w/ConBlock-CDA Red F/F - 3"
- P2) 48" - ECC CONE w/ 24" HOLE, w/ConBlock-CDA Red F/G - 30"
- P1) 48" - MH BASE w/ConBlock-CDA Red T/n - 36"
- 1) JOINT WRAP PRIMER - CONSEAL CS-75 (1 gal.)
- 1) JOINT WRAP - 0.065"x6"x50' CONSEAL CS212
- 1) ADMIXTURE CONBLOCK CDA RED
- 1) 48" - MH INVERT CHANNEL w/ConBlock-CDA Red - FULL HEIGHT
- 1) CASTING - HOE MC-375 F/C Sanitary
- 1) 48" - Conseal CS-102 1.00" (Double)
- 2) PSX - 18M DD
- 2) PSX - 12-08 NYLO
- 1) PSX - 8QRS-S NYLO
- 6) MH Step ML-10-TDS-NCR - 10"

- 0 lb
- 202 lb
- 1961 lb
- 3510 lb
- 0 lb
- 0 lb
- 0 lb
- 1440 lb
- 271 lb
- 0 lb
- 16 lb
- 16 lb
- 6 lb
- 0 lb

Structure Total: 7424 lb

Structure Notes:

1. PER ASTM C-478 SPECS
2. CONCRETE: 4,500 PSI AT 28 DAYS
3. REINFORCEMENT: (1) #3 HOOP CENTERED (GRADE 60)
4. CONBLOCK CDA RED ADMIXTURE REQUIRED

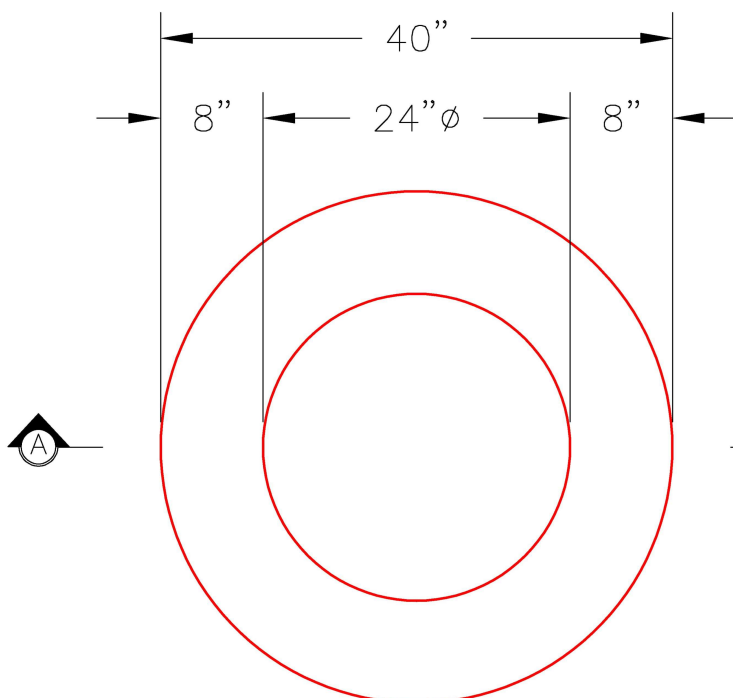

PLAN VIEW

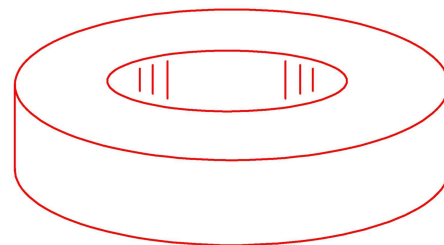

ISOMETRIC VIEW

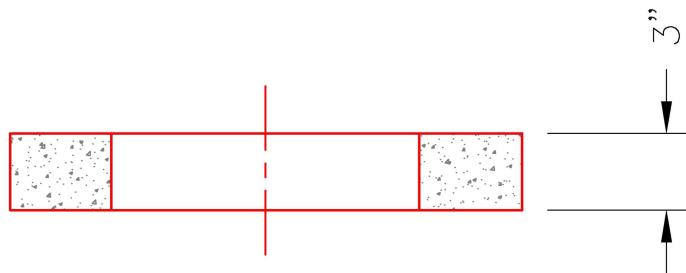

SECTION A-A

Coating (Int):
Coating (Ext):

Seam Up: Flat
Seam Dn: Flat

Wall Thickness: 8"

Height (Ext): 3"

Weight (Net): 202 lb
Volume (Net): 0.05cu.yd