

Structure ID: CI8

P1 MH060BAVF

MH BASE Custom Ht F/n

P3) 24" x 36" - CASTING HEIGHT - 6" P2) 60" - MH FLAT TOP w/24"x36" Hole F/F - 8" P1) 60" - MH BASE Custom Ht F/n - 56" 1) 60" - Conseal CS-102 1.00" 1) 24" x 36" - Conseal CS-102 1.00" 1) Hole - 44 1) Hole - 48 4) MH Step ML-10-TDS-NCR - 10"	0 lb 2153 lb 6711 lb 0 lb 0 lb 0 lb 0 lb 0 lb 0 lb Structure Total: 8864 lb
---	--

Structure Notes:

1. PER ASTM C-478 SPECIFICATIONS
2. CONCRETE: 4,000 PSI AT 28 DAYS
3. REINFORCEMENT: PER ASTM A615
4. NO INVERT CHANNEL
5. CASTING SUPPLIED BY OTHERS (HOE 470 FRAME, GRATE, & CURB HOOD)

Rim: 700.15' Rim to Invert: 5.52' Slack: 0.24" Sump: 4" Step Position: 268°

Position	Elev	Angle	Ext. (cw)	Pipe	Pipe OD	Connector	Hole	Horz Size	Up ()	Offset
Invert 1	694.63'	0°	0"	36" HDPE	41.7"	Hole 44	44"	49.393"	1.15"	0"
Invert 2	694.63'	176°	110.584"	36" RCP B WALL	44"	Hole 48	48"	55.638"	0"	0"
Invert 3										
Invert 4										
Invert 5										
Invert 6										
Invert 7										
Invert 8										

RIGHT-SIDE UP VIEW (int. dimensions)

UPSIDE-DOWN VIEW (int. dimensions)

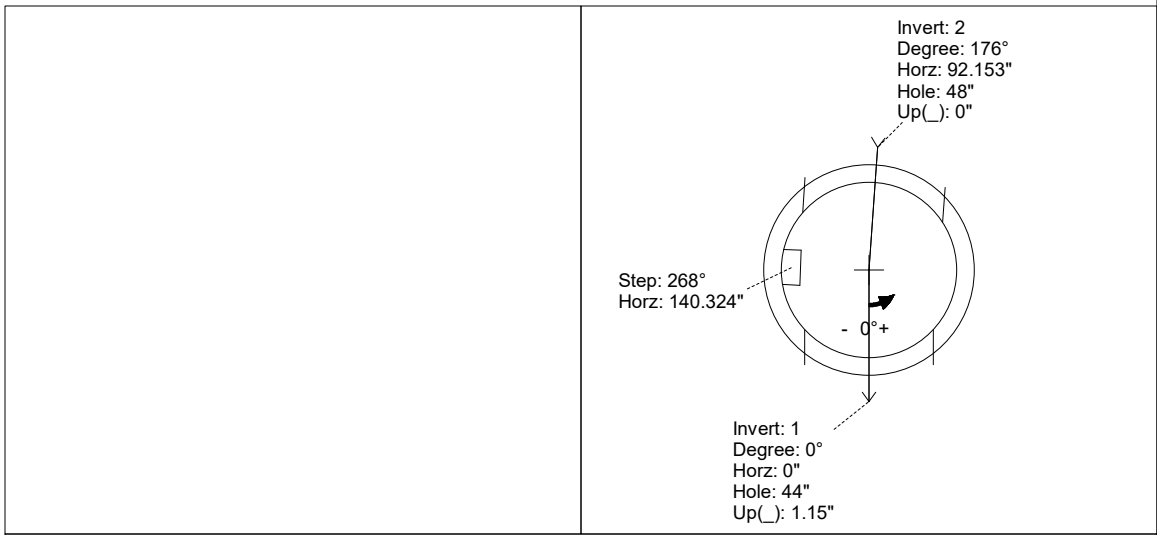
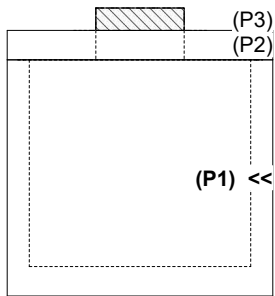

INSIDE WALL DIMENSIONS

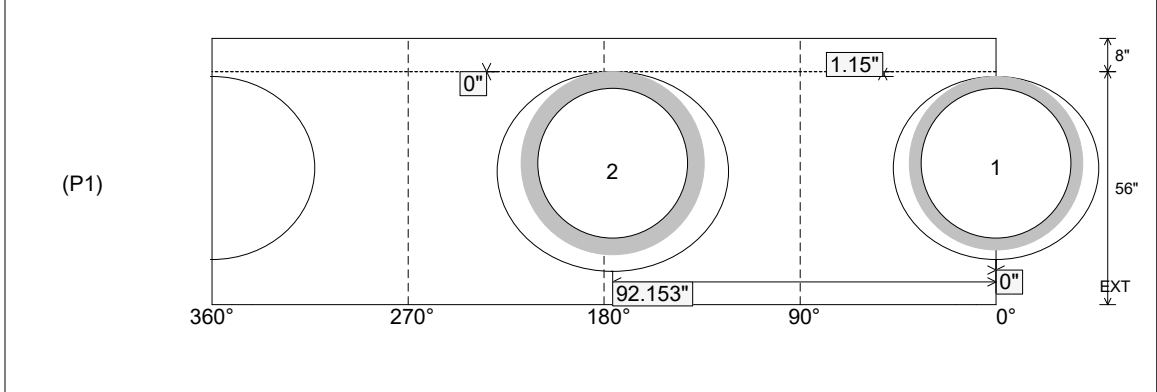

Coating (Int): Coating (Ext):	Seam Up: Flat Seam Dn: n/a	Wall Thickness: 6" Floor Height: 8"	Height (Int): 56" Height (Ext): 64"	Weight (Net): 6711 lb Volume (Net): 1.71cu.yd
----------------------------------	-------------------------------	--	--	--