

THIS DRAWING IS INTENDED TO BE PRINTED IN COLOR.

GENERAL NOTES:

1. MANUFACTURED TO ASTM C-478 (LATEST REVISION).
2. CONCRETE 5,000 PSI AT 28 DAYS.
3. REINFORCING: #4 @ 9" O.C. E.W. (GRADE 60)  
PER ASTM A615 (GRADE 60)

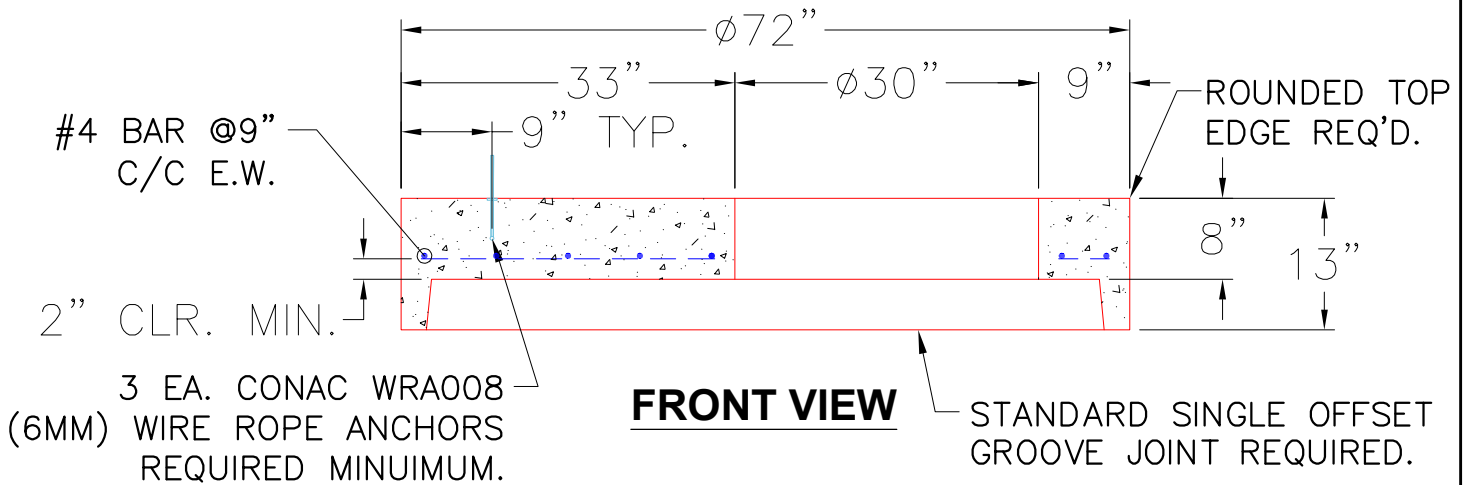
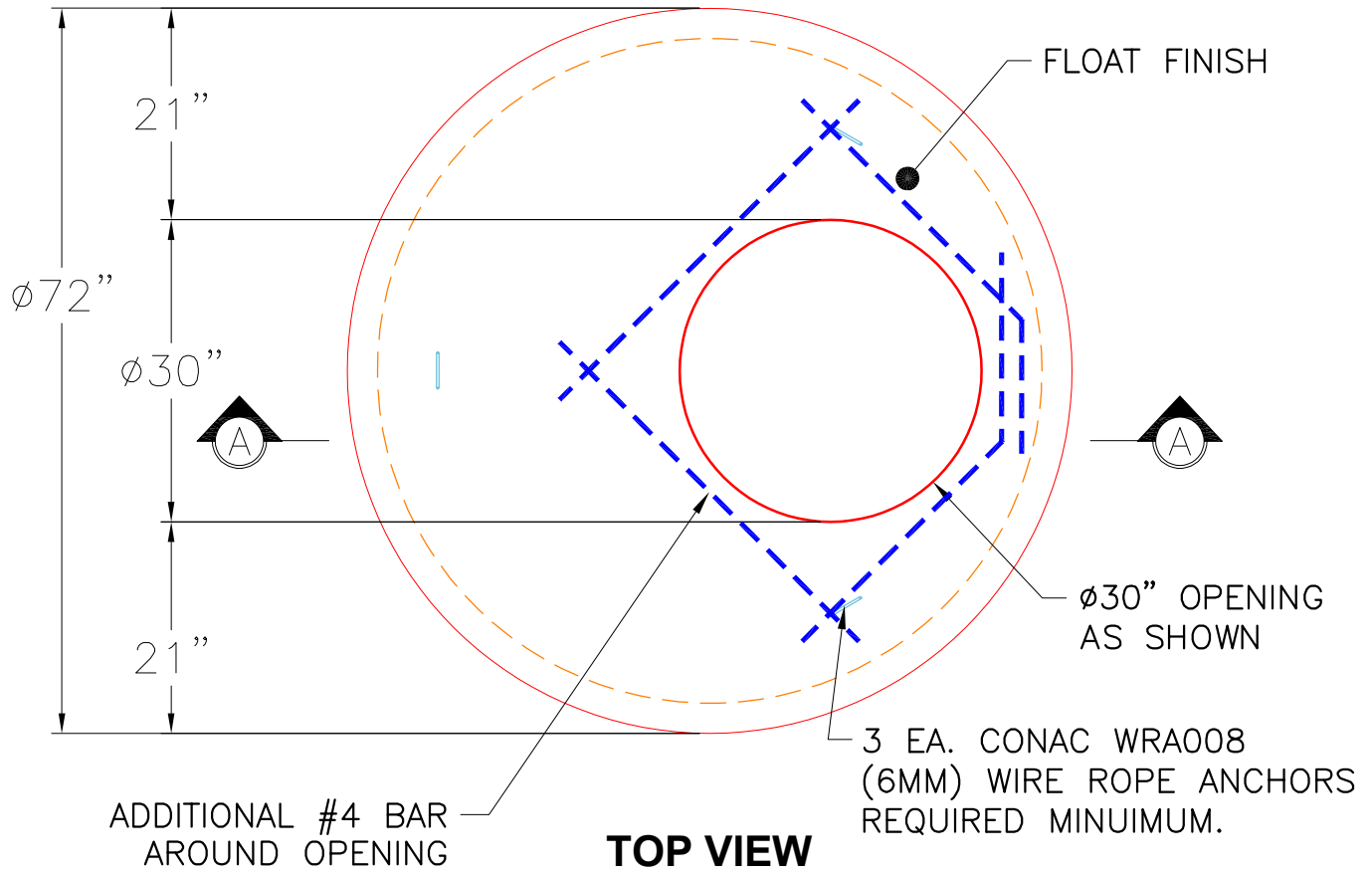

<p>PRODUCTION WORK ORDER</p>		<p>PRODUCT I.D.: MH060LD13-30ECC</p>	<p>DESCRIPTION: 60"ø TOP SLAB, 13" HEIGHT W/ ø30" ECCENTRIC OPENING</p>	
	<p>QUALITY CONTROL CHECKLIST</p>	<p>PRODUCT VIEW: RIGHT SIDE UP</p>	<p>CUSTOMER: CONTECH ENGINEERING SOLUTIONS</p>	
	<input type="checkbox"/> ALL DIMENSIONS CORRECT.	<p>PLANT: BEAVER DAM, KY.</p>	<p>PROJECT: 834447 LOU FUSZ TOYOTA KIRKWOOD</p>	
	<input type="checkbox"/> LIFTING ANCHORS INSTALLED.	<p>WEIGHT: 2,589 LBS.</p>	<p>STRUCTURE: 10-CS-5</p>	
	<input type="checkbox"/> HOLE LOCATION CORRECT.	<p>TOP SECTION JOINT: N/A</p>	<p>QUOTE/SALES ORDER NO: 25-4327</p>	
	<input type="checkbox"/> REINFORCING CORRECT.	<p>BASE SECTION JOINT: GROOVE</p>	<p>PC: T. SEKULA</p>	<p>DRAWING: J. COPPAGE</p>
<input type="checkbox"/> FLOAT FINISH ON SLAB SURFACE.	<p>QC CHECK INITIALS:</p>	<p>DATE: 10/29/25</p>	<p>SCALE: NTS</p>	<p>PG. 1 of 1</p>
<input type="checkbox"/> OUTSIDE TOP EDGE TROWELLED.				
<input type="checkbox"/> GROOVE JOINT INSTALLED.				