

Structure ID: G7

P1 MH048BAVF

MH BASE Custom Ht T/n

P3) 24" x 36" - CASTING HEIGHT - 6" P2) 48" - MH FLAT TOP w/24"x36" Hole LOU-MSD F/G - 12" P1) 48" - MH BASE Custom Ht T/n - 59" 1) 48" - Conseal CS-102 1.00" 1) 24" x 36" - Conseal CS-102 1.00" 2) Hole - 30 5) MH Step ML-10-TDS-NCR - 10"	<table style="width:100%; border-collapse: collapse;"> <tr><td style="text-align: right;">0 lb</td><td></td></tr> <tr><td style="text-align: right;">1790 lb</td><td></td></tr> <tr><td style="text-align: right;">4820 lb</td><td></td></tr> <tr><td style="text-align: right;">0 lb</td><td></td></tr> <tr><td style="text-align: right;">0 lb</td><td></td></tr> <tr><td style="text-align: right;">0 lb</td><td></td></tr> <tr><td style="text-align: right;">0 lb</td><td></td></tr> <tr><td style="text-align: right;">-----0 lb</td><td></td></tr> <tr><td style="text-align: right;">Structure Total:</td><td style="text-align: right;">6610 lb</td></tr> </table>	0 lb		1790 lb		4820 lb		0 lb		0 lb		0 lb		0 lb		-----0 lb		Structure Total:	6610 lb
0 lb																			
1790 lb																			
4820 lb																			
0 lb																			
0 lb																			
0 lb																			
0 lb																			
-----0 lb																			
Structure Total:	6610 lb																		

Structure Notes:

1. PER LOUISVILLE MSD / ASTM C-478 SPECIFICATIONS
2. CONCRETE: 4,000 PSI AT 28 DAYS
3. REINFORCEMENT: PER ASTM A615
4. NO STORM INVERT
5. STEPS AT 261 DEGREES
6. HOE 470 FRAME, GRATE, & CURB HOOD SUPPLIED BY OTHERS

Rim: 484.15' Rim to Invert: 6.3' Slack: 0.5" Sump: 1.9" Step Position: 261°

Position	Elev	Angle	Ext. (cw)	Pipe	Pipe OD	Connector	Hole	Horz Size	Up ()	Offset
Invert 1	477.85'	0°	0"	24" HDPE	27.8"	Hole 30	30"	32.406"	0"	0"
Invert 2	477.85'	162°	81.996"	24" HDPE	27.8"	Hole 30	30"	32.406"	0"	0"
Invert 3										
Invert 4										
Invert 5										
Invert 6										
Invert 7										
Invert 8										

RIGHT-SIDE UP VIEW (int. dimensions)

UPSIDE-DOWN VIEW (int. dimensions)

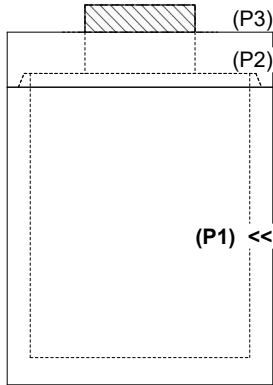

INSIDE WALL DIMENSIONS

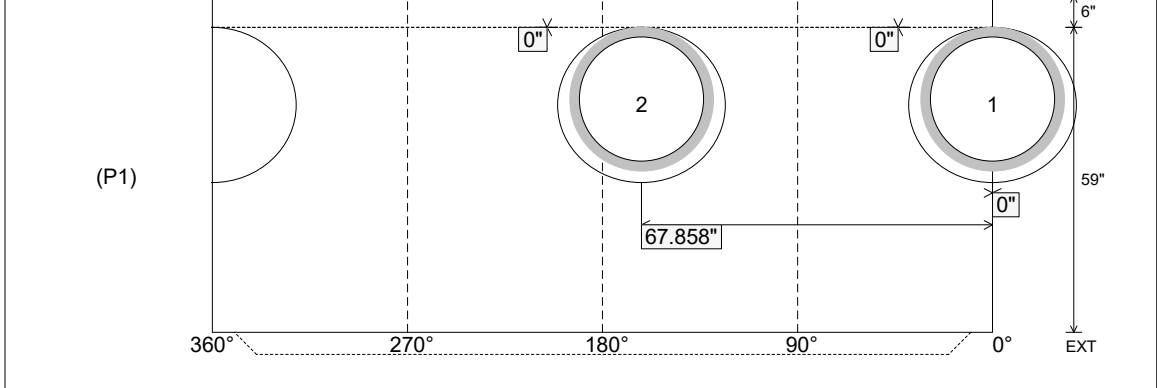

Coating (Int): Coating (Ext):	Seam Up: Tongue Seam Dn: n/a	Wall Thickness: 5" Floor Height: 6"	Height (Int): 59" Height (Ext): 65"	Weight (Net): 4820 lb Volume (Net): 1.23cu.yd
----------------------------------	---------------------------------	--	--	--