

Structure ID: E1

P1 BX3660-08BAVF

BOX BASE 8inW, 8inF, Variable Ht F/n

- | | |
|-----------------------------------------------------------------------------------------------------------------------------------------------------------------------------------------------------------------------------------------------------------------------------------------------------------------|----------------------------------------------------------------------------------------------------------------|
| P3) 24" x 24" - CASTING HEIGHT - 4"
P2) 36" x 60" - CB FLAT TOP 8"W w/24"x24" HOLE F/F - 6"
P1) 36" x 60" - BOX BASE 8inW, 8inF, Variable Ht F/n - 27"
1) SECONDARY POUR
1) 36" x 60" - Conseal CS-102 1.00"
1) 24" x 24" - Conseal CS-102 1.00"
1) Hole - 30
1) Hole - 16
1) Hole - 20 | 0 lb
1691 lb
5624 lb
0 lb
0 lb
0 lb
0 lb
0 lb
0 lb
0 lb
Structure Total: 7315 lb |
|-----------------------------------------------------------------------------------------------------------------------------------------------------------------------------------------------------------------------------------------------------------------------------------------------------------------|----------------------------------------------------------------------------------------------------------------|

- Structure Notes:**
1. PER LOUISVILLE MSD / ASTM C-913 SPECIFICATIONS
 2. CONCRETE: 4,000 PSI AT 28 DAYS
 3. REINFORCEMENT: #5 BAR @ 12" C.C. E.W. (GRADE 60) - 2" MIN. REBAR CLEARANCE (TYP)
 4. NO STORM INVERT
 5. NO STEPS
 6. HOE 280T FRAME & GRATE SUPPLIED BY OTHERS
 7. WET STICK 18" X 18" #5 L-BARS SPACED @ 12" C.C. (GRADE 60) OUT OF FLOOR FOR WALL POUR TIE-IN (SEE L-BAR DETAIL)
 8. LIFTERS: 4 EA. 4CA14 CONAC A-ANCHORS FOR PLANT & FIELD HANDLING - INSTALLED IN FLOOR, MIN. 16" FROM EDGE OF SLAB

FIRST POUR (FLOOR): 2,653 LBS
SECOND POUR (WALLS): 2,971 LBS

Rim: 486.6' Rim to Invert: 3.1' Slack: 0.2" Sump: 0" Step Position:

Position	Elev	Angle	Ext. (cw)	Pipe	Pipe OD	Connector	Hole	Horz Size	Up (↓)	Offset
Invert 1	483.5'	320°	45.65"	24" HDPE	27.8"	Hole 30	30"	46.672"	-1.9"	-15"
Invert 2	484.1'	0°	26"	12" HDPE	14.5"	Hole 16	16"	16"	5.95"	0"
Invert 3	483.5'	110°	42.142"	15" HDPE	17.6"	Hole 20	20"	21.284"	-1.3"	-5"
Invert 4										
Invert 5										
Invert 6										
Invert 7										
Invert 8										

RIGHT-SIDE UP VIEW (int. dimensions)

UPSIDE-DOWN VIEW (int. dimensions)

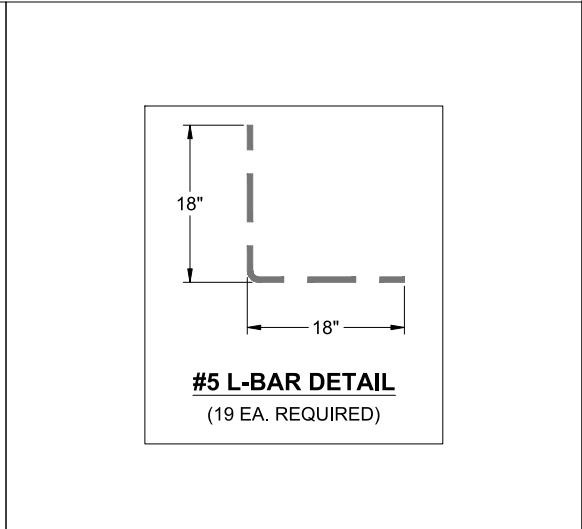
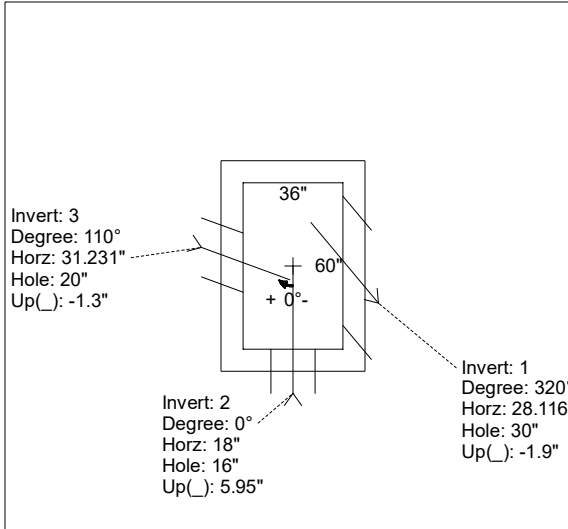
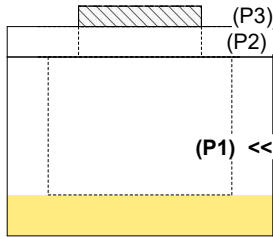

INSIDE WALL DIMENSIONS

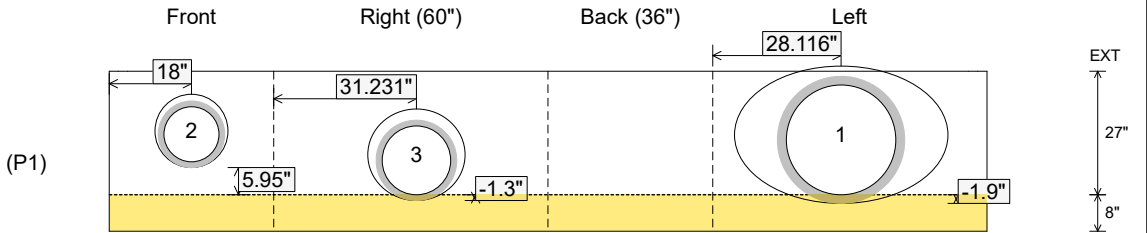

Coating (Int): Coating (Ext):	Seam Up: Flat Seam Dn: n/a	Wall Thickness: 8" Floor Height: 8"	Height (Int): 27" Height (Ext): 35"	Weight (Net): 5624 lb Volume (Net): 1.44cu.yd
----------------------------------	-------------------------------	----------------------------------------	----------------------------------------	--------------------------------------------------

Job Name: 25-4299 - Seneca High School
 Job Location: Louisville, KY
 Contractor: Dan Cristiani Excavating Co. Inc.

Plant: 100

2/16/2026 10:16:31 AM

Tech: J. Horsley

PC: J. Jarvis



Structure ID: E1

P1 BX3660-08BAVF

BOX BASE 8inW, 8inF, Variable Ht F/n

- P3) 24" x 24" - CASTING HEIGHT - 4"
- P2) 36" x 60" - CB FLAT TOP 8"W w/24"x24" HOLE F/F - 6"
- P1) 36" x 60" - BOX BASE 8inW, 8inF, Variable Ht F/n - 27"
- 1) SECONDARY POUR
- 1) 36" x 60" - Conseal CS-102 1.00"
- 1) 24" x 24" - Conseal CS-102 1.00"
- 1) Hole - 30
- 1) Hole - 16
- 1) Hole - 20

0 lb
 1691 lb
 5624 lb
 0 lb
 0 lb
 0 lb
 0 lb
 0 lb
 0 lb
 0 lb

 Structure Total: 7315 lb

- Structure Notes:
1. PER LOUISVILLE MSD / ASTM C-913 SPECIFICATIONS
 2. CONCRETE: 4,000 PSI AT 28 DAYS
 3. REINFORCEMENT: #5 BAR @ 12" C.C. E.W. (GRADE 60) - 2" MIN. REBAR CLEARANCE (TYP)
 4. NO STORM INVERT
 5. NO STEPS
 6. HOE 280T FRAME & GRATE SUPPLIED BY OTHERS

FIRST POUR (FLOOR): 2,653 LBS

SECOND POUR (WALLS): 2,971 LBS

Rim: 486.6' Rim to Invert: 3.1' Slack: 0.2" Sump: 0" Step Position:

Position	Elev	Angle	Ext. (cw)	Pipe	Pipe OD	Connector	Hole	Horz Size	Up (↓)	Offset
Invert 1	483.5'	320°	45.65"	24" HDPE	27.8"	Hole 30	30"	46.672"	-1.9"	-15"
Invert 2	484.1'	0°	26"	12" HDPE	14.5"	Hole 16	16"	16"	5.95"	0"
Invert 3	483.5'	110°	42.142"	15" HDPE	17.6"	Hole 20	20"	21.284"	-1.3"	-5"
Invert 4										
Invert 5										
Invert 6										
Invert 7										
Invert 8										

RIGHT-SIDE UP VIEW (int. dimensions)

UPSIDE-DOWN VIEW (int. dimensions)

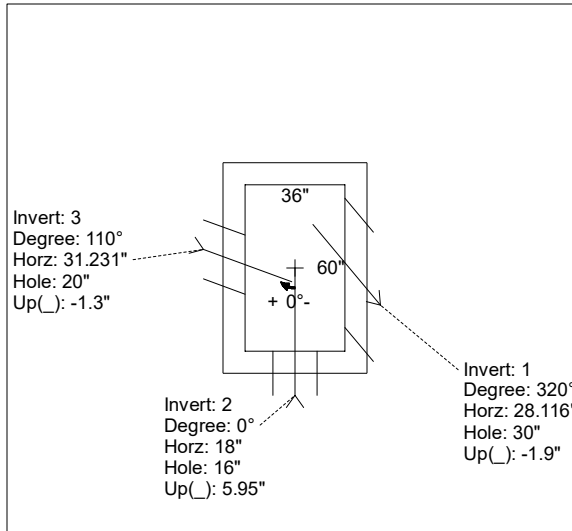
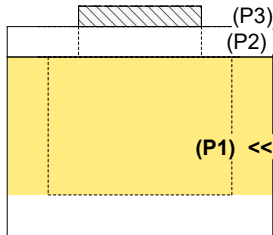

INSIDE WALL DIMENSIONS

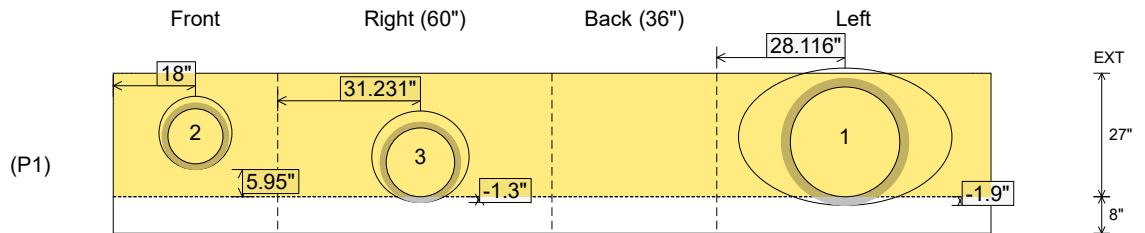

Coating (Int):
 Coating (Ext):

Seam Up: Flat
 Seam Dn: n/a

Wall Thickness: 8"
 Floor Height: 8"

Height (Int): 27"
 Height (Ext): 35"

Weight (Net): 5624 lb
 Volume (Net): 1.44cu.yd