

Job Name: 25-4299 - Seneca High School
 Job Location: Louisville, KY
 Contractor: Dan Cristiani Excavating Co. Inc.

Plant: 100
 2/10/2026 8:24:01 AM

Tech: J. Horsley
 PC: J. Jarvis



Structure ID: A8

P1 MH072BAVF

MH BASE Custom Ht F/n

- P3) 24" x 36" - CASTING HEIGHT - 6"
- P2) 72" - MH FLAT TOP SPEC. HT. (8") w/24"x36" Hole F/F - 8"
- P1) 72" - MH BASE Custom Ht F/n - 51"
- 1) 72" - Conseal CS-102 1.00"
- 2) Hole - 46
- 1) Hole - 24
- 4) MH Step ML-10-TDS-NCR - 10"

0 lb
 3319 lb
 8975 lb
 0 lb
 0 lb
 0 lb
 0 lb

 12295 lb

Structure Total: 12295 lb

- Structure Notes:**
1. PER LOUISVILLE MSD / ASTM C-478 SPECIFICATIONS
 2. CONCRETE: 4,000 PSI AT 28 DAYS
 3. REINFORCEMENT: PER ASTM A615
 4. NO STORM INVERT
 5. STEPS AT 75.5 DEGREES
 6. HOE 470 FRAME, GRATE, & CURB HOOD SUPPLIED BY OTHERS

Rim: 484.4' Rim to Invert: 5.1' Slack: 0.2" Sump: 4" Step Position: 75.5°

Position	Elev	Angle	Ext. (cw)	Pipe	Pipe OD	Connector	Hole	Horz Size	Up ()	Offset
Invert 1	479.3'	0°	0"	36" RCP B WALL	44"	Hole 46	46"	49.9"	0"	0"
Invert 2	479.3'	148°	111.073"	36" RCP B WALL	44"	Hole 46	46"	49.9"	0"	0"
Invert 3	480.4'	218°	163.607"	18" HDPE	21.2"	Hole 24	24"	24.468"	15.6"	0"
Invert 4										
Invert 5										
Invert 6										
Invert 7										
Invert 8										

RIGHT-SIDE UP VIEW (int. dimensions)

UPSIDE-DOWN VIEW (int. dimensions)

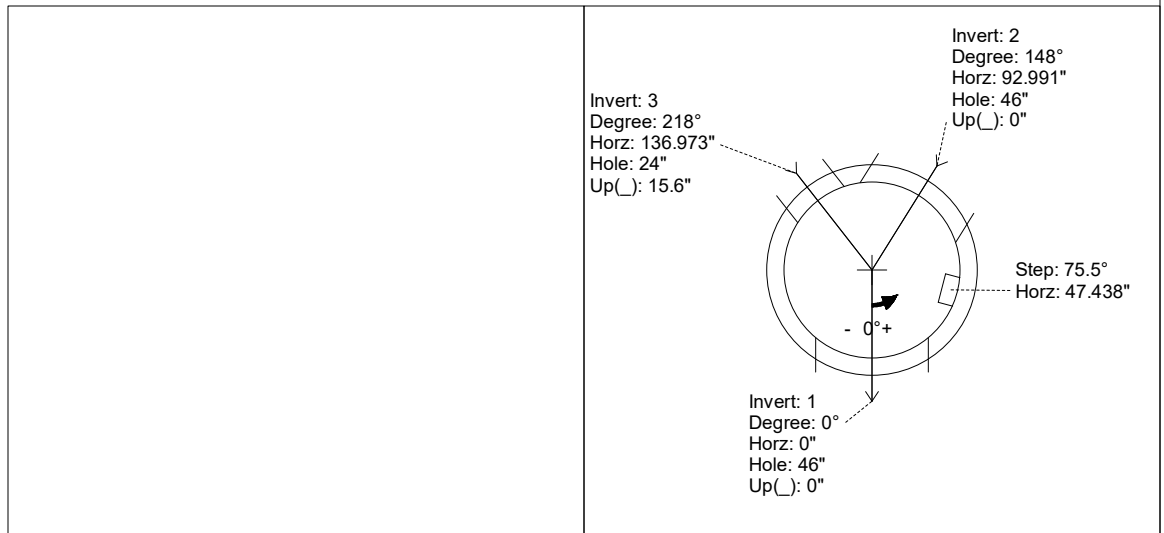
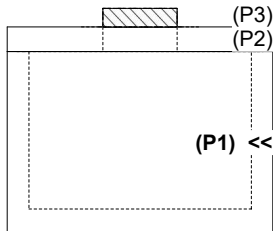

INSIDE WALL DIMENSIONS

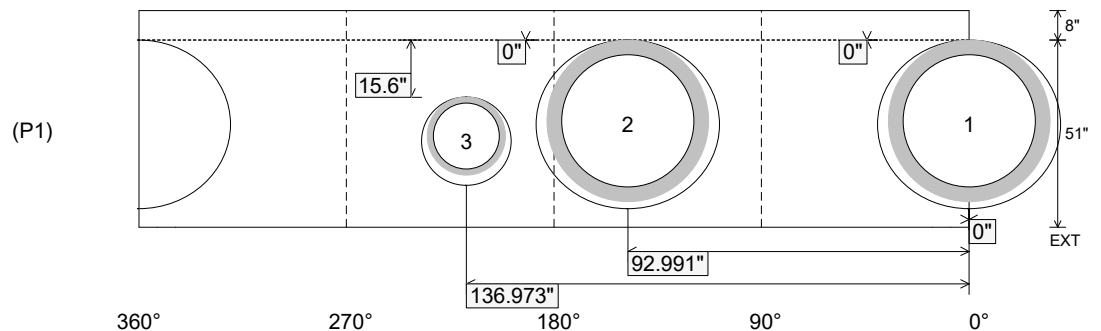

Coating (Int):
 Coating (Ext):

Seam Up: Flat
 Seam Dn: n/a

Wall Thickness: 7"
 Floor Height: 8"

Height (Int): 51"
 Height (Ext): 59"

Weight (Net): 8975 lb
 Volume (Net): 2.29cu.yd