

**Structure ID: A12**

**P1 MH060BA42**

**MH BASE F/n**

- P3) 24" x 36" - CASTING HEIGHT - 6"
- P2) 60" - MH FLAT TOP w/24"x36" Hole LOU-MSD F/F - 8"
- P1) 60" - MH BASE F/n - 42"
- 1) 60" - Conseal CS-102 1.00"
- 1) 24" x 36" - Conseal CS-102 1.00"
- 1) Hole - 38
- 1) Hole - 30
- 3) MH Step ML-10-TDS-NCR - 10"

0 lb  
 2322 lb  
 6138 lb  
 0 lb  
 0 lb  
 0 lb  
 0 lb  
 0 lb  
 0 lb  
 Structure Total: 8459 lb

- Structure Notes:**
1. PER LOUISVILLE MSD / ASTM C-478 SPECIFICATIONS
  2. CONCRETE: 4,000 PSI AT 28 DAYS
  3. REINFORCEMENT: PER ASTM A615
  4. NO STORM INVERT
  5. STEPS AT 98.5 DEGREES
  6. HOE 470 FRAME, GRATE, & CURB HOOD SUPPLIED BY OTHERS

Rim: 486'    Rim to Invert: 4.5'    Slack: 0.55"    Sump: 2.55"    Step Position: 98.5°

| Position | Elev   | Angle | Ext. (cw) | Pipe     | Pipe OD | Connector | Hole | Horz Size | Up ( ) | Offset |
|----------|--------|-------|-----------|----------|---------|-----------|------|-----------|--------|--------|
| Invert 1 | 481.5' | 0°    | 0"        | 30" HDPE | 35.1"   | Hole 38   | 38"  | 41.151"   | 0"     | 0"     |
| Invert 2 | 481.5' | 197°  | 123.779"  | 24" HDPE | 27.8"   | Hole 30   | 30"  | 31.416"   | 0.65"  | 0"     |
| Invert 3 |        |       |           |          |         |           |      |           |        |        |
| Invert 4 |        |       |           |          |         |           |      |           |        |        |
| Invert 5 |        |       |           |          |         |           |      |           |        |        |
| Invert 6 |        |       |           |          |         |           |      |           |        |        |
| Invert 7 |        |       |           |          |         |           |      |           |        |        |
| Invert 8 |        |       |           |          |         |           |      |           |        |        |

RIGHT-SIDE UP VIEW (int. dimensions)

UPSIDE-DOWN VIEW (int. dimenions)

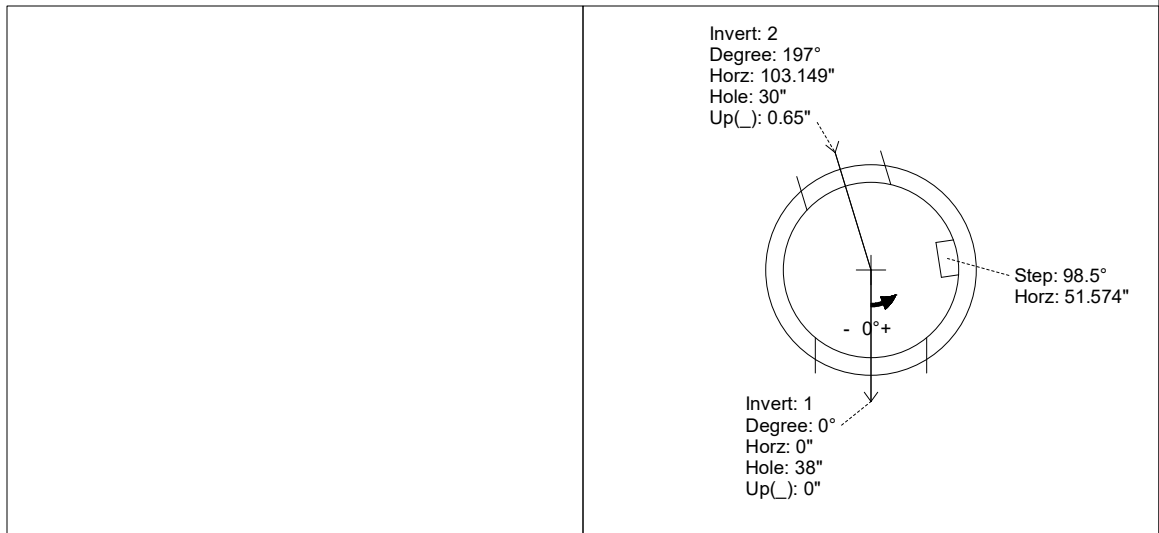
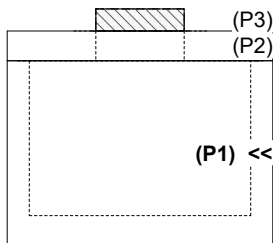

INSIDE WALL DIMENSIONS

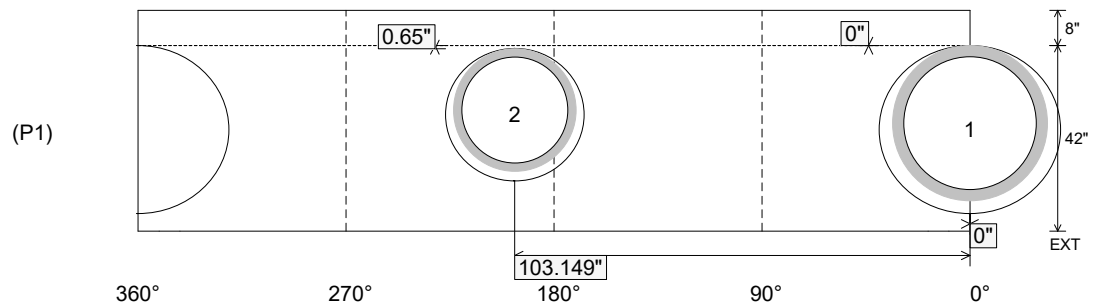

|                                  |                               |  |  |  |
|----------------------------------|-------------------------------|--|--|--|
| Coating (Int):<br>Coating (Ext): | Seam Up: Flat<br>Seam Dn: n/a | Wall Thickness: 6"<br>Floor Height: 8" | Height (Int): 42"<br>Height (Ext): 50" | Weight (Net): 6138 lb<br>Volume (Net): 1.57cu.yd |
|----------------------------------|-------------------------------|--|--|--|