

Job Name: 25-4268 - The Professional Park Lots 5 & 6
 Job Location: Bowling Green, KY
 Contractor: Scott & Ritter, Inc.

Plant: Beaver Dam, KY
 10/28/2025 6:17:18 AM

Tech: K. Cardwell
 PC: C. Goff



Structure ID: ST B2

P1 MH048BAVF

MH BASE Custom Ht F/n

- P3) 18" x 36" - CASTING HEIGHT - 5.5"
- P2) 48" - MH FLAT TOP w/18"x36" Hole F/F - 7"
- P1) 48" - MH BASE Custom Ht F/n - 23"
- 1) CASTING - HOE 580-A F/G
- 1) 48" - Conseal CS-102 1.00"
- 1) 18" x 36" - Conseal CS-102 1.00"
- 2) Hole - 20"

0 lb
 1171 lb
 2666 lb
 574 lb
 0 lb
 0 lb
 0 lb

 Structure Total: 4412 lb

- Structure Notes:**
 STATION: 0+13.75 LN B
1. PER ASTM C-478 SPECS
 2. CONCRETE: 4,500 PSI AT 28 DAYS
 3. REINFORCEMENT: PER ASTM A615
 4. NO STEPS
 5. HOE 580-A FRAME & GRATES SUPPLIED BY ICAST

Rim: 538.13' Rim to Invert: 3.01' Slack: 0.62" Sump: 0" Step Position:

Position	Elev	Angle	Ext. (cw)	Pipe	Pipe OD	Connector	Hole	Horz Size	Up ()	Offset
Invert 1	535.12'	0°	0"	15" HDPE	17.6"	Hole 20	20"	20.629"	-1.3"	0"
Invert 2	535.12'	110°	55.676"	15" HDPE	17.6"	Hole 20	20"	20.629"	-1.3"	0"
Invert 3										
Invert 4										
Invert 5										
Invert 6										
Invert 7										
Invert 8										

RIGHT-SIDE UP VIEW (int. dimensions)

UPSIDE-DOWN VIEW (int. dimensions)

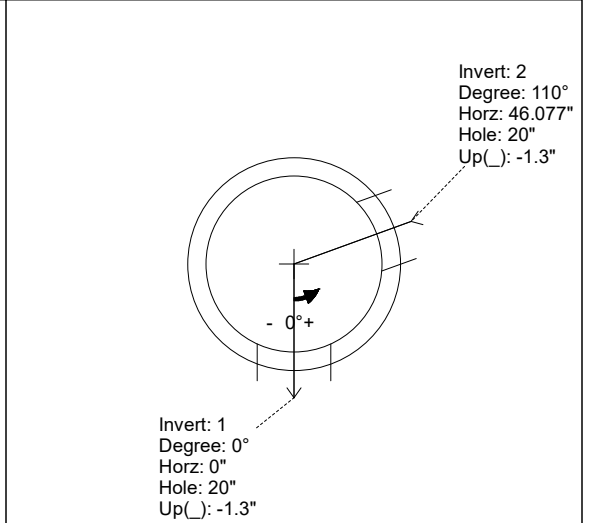
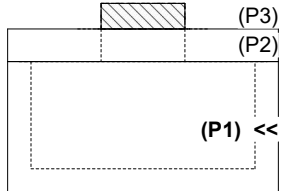

INSIDE WALL DIMENSIONS

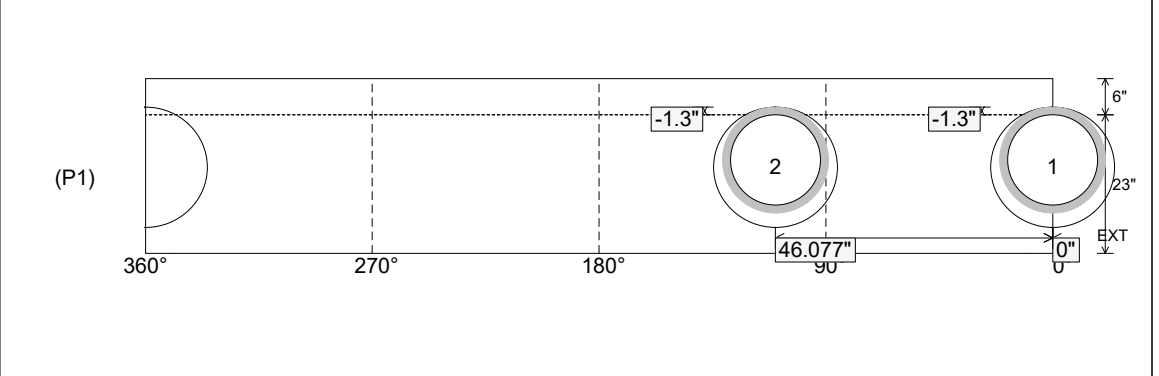

Coating (Int): Coating (Ext):	Seam Up: Flat Seam Dn: n/a	Wall Thickness: 5" Floor Height: 6"	Height (Int): 23" Height (Ext): 29"	Weight (Net): 2666 lb Volume (Net): 0.68cu.yd
----------------------------------	-------------------------------	--	--	--