



Structure ID: 6

P1 BX2436-08BVF

BOX BASE 8inW, 8inF, Variable Ht T/n

P3) 24" x 120" - CB INLET KY A 10' TOP RIGHT F/G - 10"
 P2) 24" x 120" - CB INLET KY A 10' BOTTOM RIGHT T/G - 18"
 P1) 24" x 36" - BOX BASE 8inW, 8inF, Variable Ht T/n - 46"
 1) CASTING - HOE KY-206 F/C (KY TY1)
 1) 24" x 36" - Conseal CS-102 1.00"
 1) Hole - 22
 2) Hole - 6

3398 lb
 5270 lb
 5797 lb
 206 lb
 0 lb
 0 lb
 0 lb

 14671 lb

Structure Notes:
 ** KYTC STATE PROJECT **
 1. HOE KY-206 FRAME & COVER (KY TY 1) PROVIDED BY ICAST - FRAME TO BE CAST INTO TOP PHASE TOP FLANGE SIDE UP
 2. PER KYTC CBI TYPE A / ASTM C-913 SPECS
 3. CONCRETE: 4,000 PSI AT 28 DAYS
 4. REINFORCEMENT: #5 BAR @ 12" C.C. E.W. (GRADE 60) - 2" MIN. REBAR CLEARANCE (TYP)
 5. NO INVERT CHANNEL

Structure Total: 14671 lb

Rim: 836.88' Rim to Invert: 6.22' Slack: 0.64" Sump: 0" Step Position:

Position	Elev	Angle	Ext. (cw)	Pipe	Pipe OD	Connector	Hole	Horz Size	Up ()	Offset
Invert 1	830.66'	270°	20"	18" CMP	19"	Hole 22	22"	22"	-2"	-6"
Invert 2	831.16'	90°	26"	4" HDPE (perf pipe)	4.8"	Hole 6	6"	6"	5"	0"
Invert 3	831.16'	270°	40"	4" HDPE (perf pipe)	4.8"	Hole 6	6"	6"	5"	14"
Invert 4										
Invert 5										
Invert 6										
Invert 7										
Invert 8										

RIGHT-SIDE UP VIEW (int. dimensions) UPSIDE-DOWN VIEW (int. dimenions)

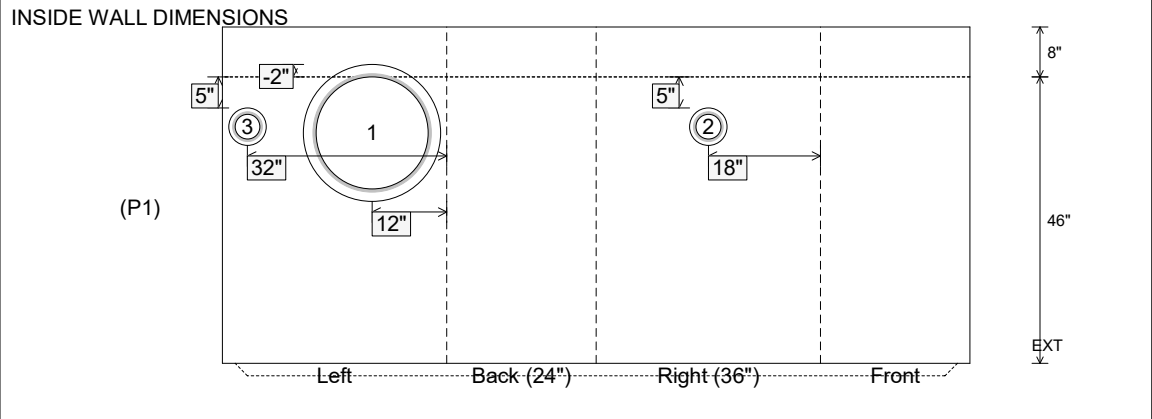
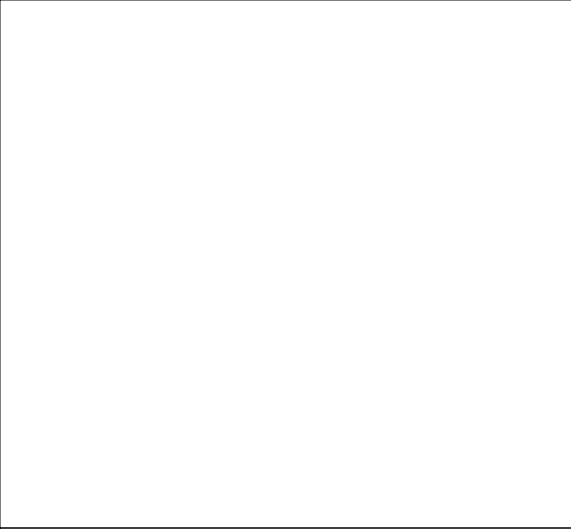
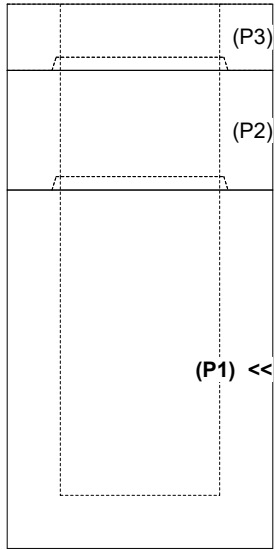

Coating (Int): Coating (Ext):	Seam Up: Tongue Seam Dn: n/a	Wall Thickness: 8" Floor Height: 8"	Height (Int): 46" Height (Ext): 54"	Weight (Net): 5797 lb Volume (Net): 1.48cu.yd
----------------------------------	---------------------------------	--	--	--