

Job Name: 25-4219 - Hitachi Berea  
 Job Location: Berea, KY  
 Contractor: Brown General Contractors

Plant: 100  
 3/26/2026 2:13:02 PM

Tech: J. Horsley - F  
 PC: J. Jarvis



**Structure ID: ST-8**

**P2 BX3648-08R24**

**BOX RISER 8inW**

- P3) 36" x 48" - P.I.P. - BY OTHERS - 8"
- P2) 36" x 48" - BOX RISER 8inW - 24"
- P1) 36" x 48" - BOX BASE 8inW, 8inF - 42"
- 1) CASTING - HOE KY-460 SET (DBI 5A)
- 2) 36" x 48" - Conseal CS-102 1.00"
- 1) Hole - 24
- 1) Hole - 20

0 lb  
 3222 lb  
 7358 lb  
 460 lb  
 0 lb  
 0 lb  
 0 lb  
 -----  
 Structure Total: 11041 lb

- Structure Notes:**
1. PER ASTM C913 SPECIFICATIONS.
  2. CONCRETE = 4,000 PSI AT 28 DAYS.
  3. CASTING BY I-CAST (HOE KY-460 SET (DBI 5A))
  4. STUB #5 BARS @ 12" O.C. EXTENDED 20" ABOVE THE TOP OF THE RISER WALLS.

REINFORCING PER ASTM A615 (GRADE 60).  
 - WALLS (As .12) #5 BARS AT 12" C.C.E.W.  
 - FLOOR (As .12) #5 BARS AT 12" C.C.E.W.

Rim: 965.09' Rim to Invert: 6.18' Slack: 0.16" Sump: 0" Step Position:

Position	Elev	Angle	Ext. (cw)	Pipe	Pipe OD	Connector	Hole	Horz Size	Up (L)	Offset
Invert 1										
Invert 2										
Invert 3										
Invert 4										
Invert 5										
Invert 6										
Invert 7										
Invert 8										

**RIGHT-SIDE UP VIEW (int. dimensions)**

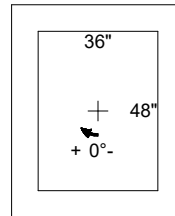
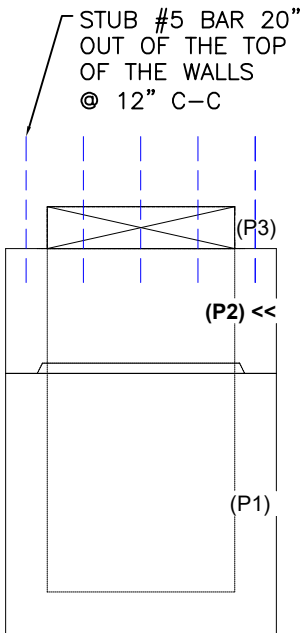

**INSIDE WALL DIMENSIONS**

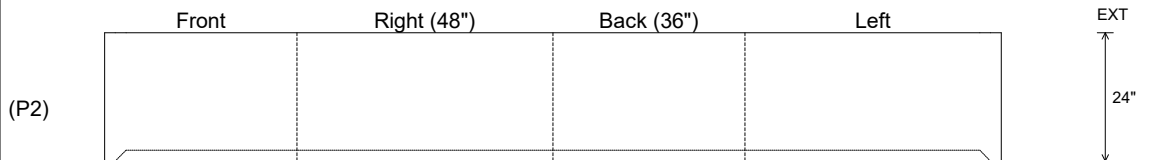

Coating (Int):  
 Coating (Ext):

Seam Up: Flat  
 Seam Dn: Groove

Wall Thickness: 8"  
 Floor Height: 0"

Height (Int): 24"  
 Height (Ext): 24"

Weight (Net): 3222 lb  
 Volume (Net): 0.82cu.yd