

Structure ID: MH A5

P4 MH048CN36SP

ECC CONE w/ 24" HOLE, w/Coating F/G

P5) 24" - CASTING HEIGHT - 7" P4) 48" - ECC CONE w/ 24" HOLE, w/Coating F/G - 36" P3) 48" - MH RISER w/COATING T/G - 60" P2) 60" - MH Trans. Slab - 48" Hole ECC, w/Coating T/G - 15" P1) 60" - MH BASE w/FLANGE (08F/07EF) w/Coating T/n - 71" 1) JOINT WRAP - 12" WD x 060" MAC WRAP 1) 60" - MH INVERT CHANNEL - FULL HEIGHT 1) SPECIAL EXTERNAL COATING 2) JOINT WRAP - 12" WD x 048" MAC WRAP 1) SECONDARY POUR - Extended Flange 1) 60" - Conseal CS-102 1.00" (Double) 2) 48" - Conseal CS-102 1.00" (Double) 2) A-Lok - 1040 14) MH Step ML-10-TDS-NCR - 10" 292.38 SqFt) Carboline Bitumastic 300M [EXT]	0 lb 2251 lb 4192 lb 1928 lb 10379 lb 0 lb 2692 lb 0 lb 0 lb 0 lb 0 lb 0 lb 2 lb 0 lb 0 lb 0 lb	Structure Notes: 1. PER ASTM C-478 SPECIFICATIONS 2. CONCRETE: 4,000 PSI AT 28 DAYS 3. REINFORCEMENT: PER ASTM A615 4. CARBOLINE 300M EXTERIOR COATING REQUIRED 5. STEPS REQUIRED 6. HOE MC-375 FRAME & COVER "SANITARY" SUPPLIED BY OTHERS
Structure Total:	21444 lb	

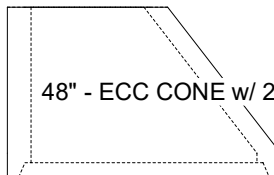
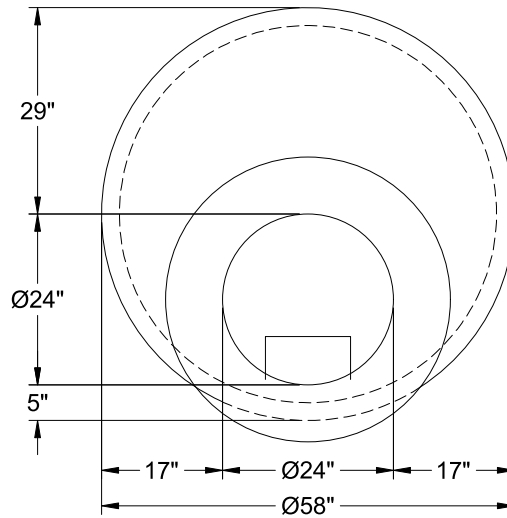

48" - ECC CONE w/ 24" HOLE, w/Coating F/G - 36" - (P4)

Coating (Int): Coating (Ext): Carboline Bitumastic 300M	Seam Up: Flat Seam Dn: Groove	Wall Thickness: 5"	Height (Ext): 36"	Weight (Net): 2251 lb Volume (Net): 0.57cu.yd
--	----------------------------------	--------------------	-------------------	--

Job Number:

25-3579

Job Name:

Lebanon Rd Clarks Run Trunk Sewer
Ph 2

Structure:

MH A5

Note:

This Structure Is To Receive An
External Coating of Carboline 300M
(Supplied By iCast)