

Job Name: 25-3560 Stephens Behavioral Consulting
 Job Location: Shelbyville, KY
 Contractor: Joda International Inc.

Plant: Beaver Dam
 2/6/2026 2:20:19 PM

Tech: S. Felletter
 PC: T. Lewis



Structure ID: CBI-6

P2 BX024030-08LD06S

CB FLAT TOP 8"W w/24"x24"Hole F/F

- P3) 24" x 24" - CASTING HEIGHT - 5"
- P2) 24" x 30" - CB FLAT TOP 8"W w/24"x24"Hole F/F - 6"
- P1) 24" x 30" - BOX BASE 8inW, 8inF, Variable Ht F/n - 25"
- 1) 24" x 30" - Conseal CS-102 1.00"
- 1) 24" x 24" - Conseal CS-102 1.00"
- 1) Hole - 16

0 lb
 636 lb
 3394 lb
 0 lb
 0 lb
 0 lb

 Structure Total: 4030 lb

Structure Notes:
 1. PER ASTM C913 SPECIFICATIONS.
 2. CONCRETE = 4,000 PSI AT 28 DAYS.
 3. NO INVERT CHANNEL.
 4. CASTING HOE KY-465 PROVIDED BY ICAST.

REINFORCING PER ASTM A615 (GRADE 60).
 - WALLS (As .12) #5 BARS AT 12" C.C.E.W.
 - FLOOR (As .12) #5 BARS AT 12" C.C.E.W.

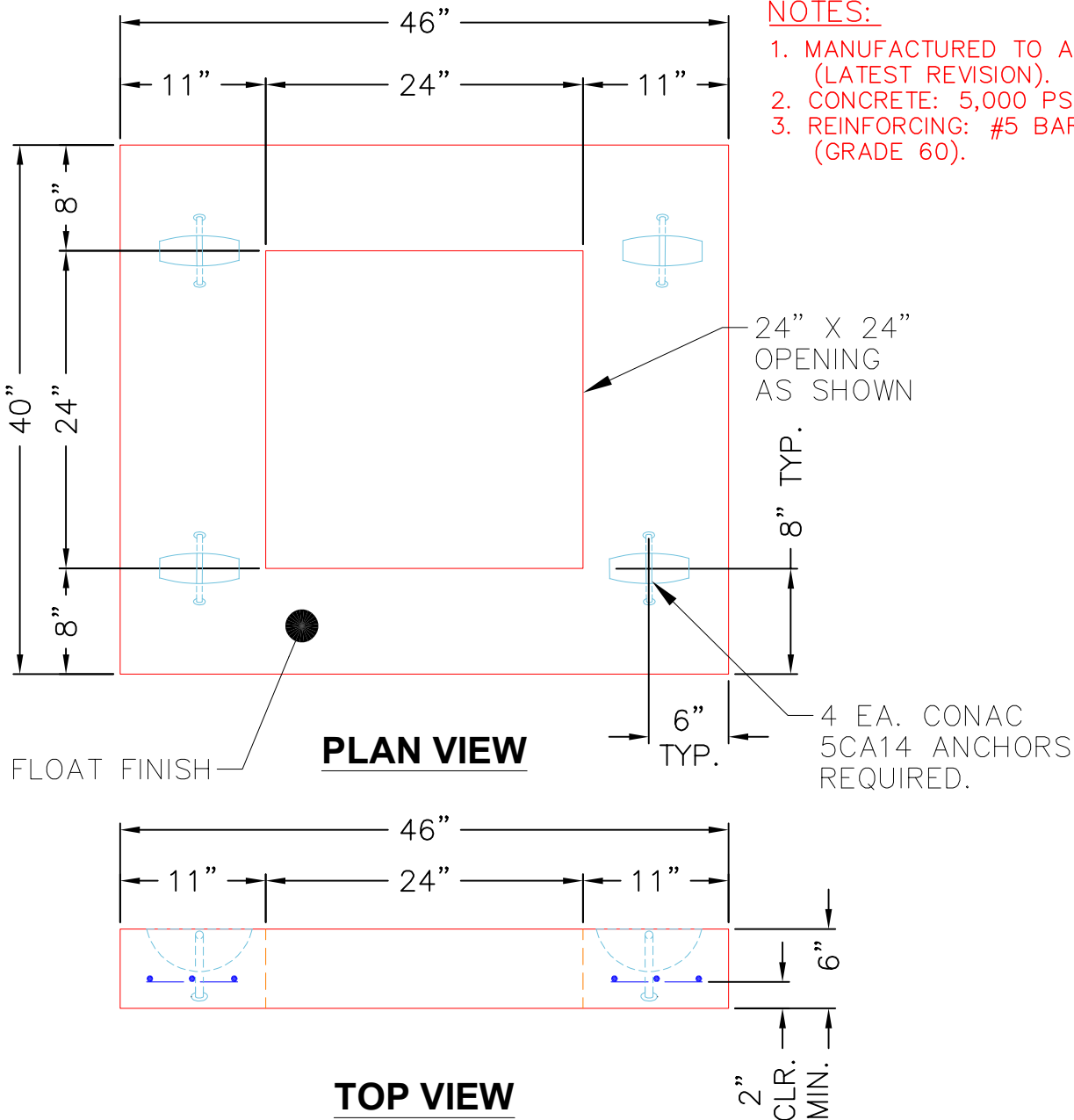

NOTES:

1. MANUFACTURED TO ASTM C-913 (LATEST REVISION).
2. CONCRETE: 5,000 PSI AT 28 DAYS.
3. REINFORCING: #5 BAR @ 6" O.C. E.W. (GRADE 60).

Coating (Int): Coating (Ext):	Seam Up: Flat Seam Dn: Flat	Wall Thickness: 8"	Height (Ext): 6"	Weight (Net): 636 lb Volume (Net): 0.16cu.yd
----------------------------------	--------------------------------	--------------------	------------------	---