

CONAC A-ANCHORS FOR PLANT & FIELD HANDLING

PLAN VIEW

48" X 72" HATCH SUPPLIED BY OTHERS - TO BE CAST INTO FLAT LID

GENERAL NOTES:

1. MANUFACTURED TO ASTM C-913 (LATEST REVISION)
2. CONCRETE: 5,000 PSI AT 28 DAYS
3. REINFORCEMENT:
 - FLAT LID: #5 BAR @ 6" C.C. E.W. (GRADE 60)
 - BASE: #4 BAR @ 12" C.C. E.W. (GRADE 60)
4. WEIGHTS:

8" FLAT LID:	4,620 LBS
63" BASE:	17,040 LBS
TOTAL WEIGHT:	21,660 LBS
5. CONTRACTOR TO VERIFY ALL DIMENSIONS BEFORE MANUFACTURE
6. 48" X 72" HATCH SUPPLIED BY OTHERS - HATCH TO BE CAST INTO FLAT LID
7. ALL LIFT POINTS AND PIPE OPENINGS TO BE GROUTED BY CONTRACTOR
8. JOINT SEALANT: CONSEAL CS-102 - 1" (PRIMARY & SECONDARY ROWS)

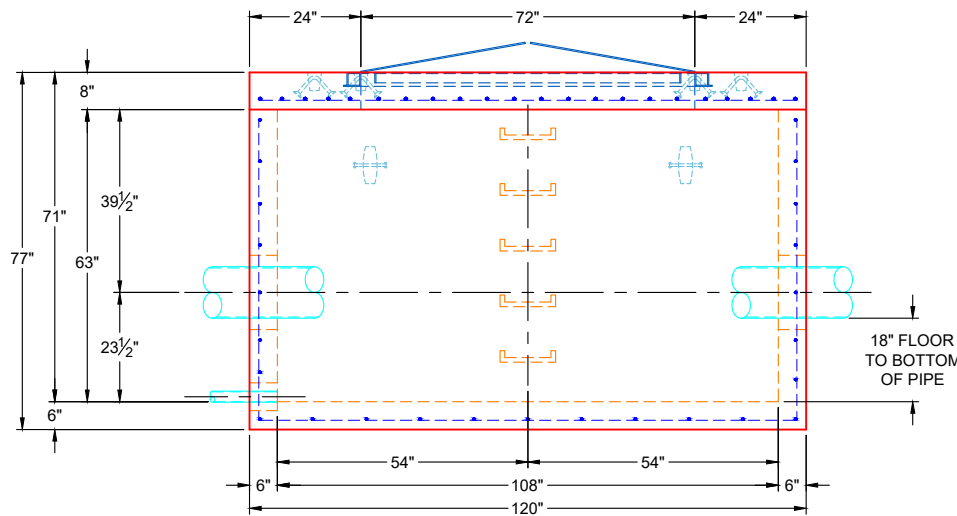

FRONT VIEW

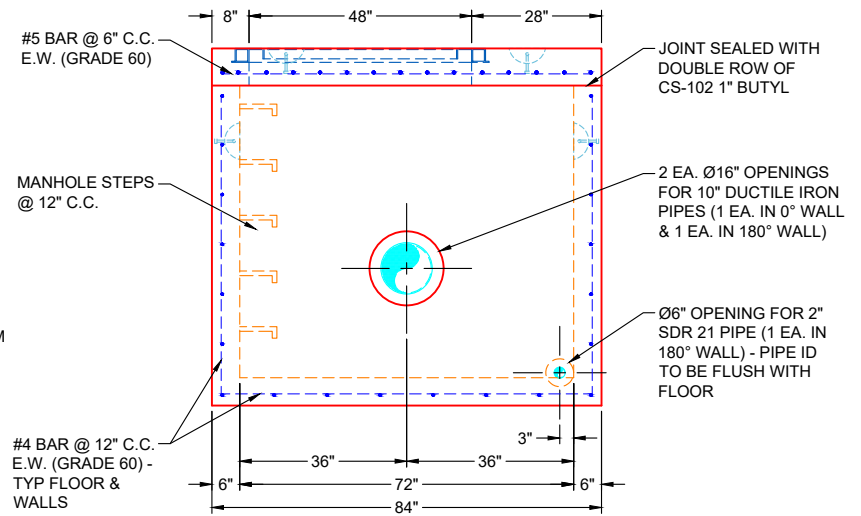

SIDE VIEW

REVISION INFORMATION

REV.	DATE:	NO REVISIONS TO DATE



SUBMITTAL DRAWING: 72" X 108" CONTROL VALVE VAULT		
CUSTOMER: HAYES PIPE SUPPLY		
PROJECT: RUDDERVILLE PS MODIFICATIONS		
STRUCTURE: 2-53525 (CONTROL VALVE VAULT)		
QUOTE/SALES ORDER NO: 25-3525		
CHECKED BY: B. SMITH	DRAWN BY: K. CARDWELL	
DATE: 10/03/25	SCALE: NTS	PG. 1 OF 1