

Job Name: 25-3505 KYTC Multi Co Call 200 (251117)
 Job Location:
 Contractor: Jim Smith Contracting Co, LLC

Plant: 100

3/25/2026 8:42:44 AM

Tech: J. Coppage - A

PC: Jay Ross Jarvis



Structure ID: 2021 87

P2 BX032032-08LD08S

CB FLAT TOP 8"W SOLID

- P2) 32" x 32" - CB FLAT TOP 8"W SOLID - 8"
- P1) 32" x 32" - BOX BASE 8inW, 8inF, Variable Ht - 32"
- 1) 32" x 32" - Conseal CS-102 1.00"
- 2) Hole - 30

1547 lb
 4035 lb
 0 lb
 0 lb

 Structure Total: 5581 lb

- Structure Notes:**
 ***KYTC STATE PROJECT**
1. SOLID TOP SLAB - NO CASTING.
 2. KYTC JUNCTION BOX / PER ASTM C913 SPEC'S.
 3. CONCRETE = 4,000 PSI AT 28 DAYS.
 4. REINFORCING PER ASTM A615 (GRADE 60).
 - TOP SLAB (As .62) #5 BARS AT 6" C.C.E.W.
 - WALLS (As .31) #5 BARS AT 12" C.C.E.W.
 - FLOOR (As .31) #5 BARS AT 12: C.C.E.W.

3 EA. CONAC .8 TON 8¹/₁₆"
 (6MM) WIRE ROPE ANCHORS
 REQUIRED—MINIMUM.

KYTC STATE PROJECT

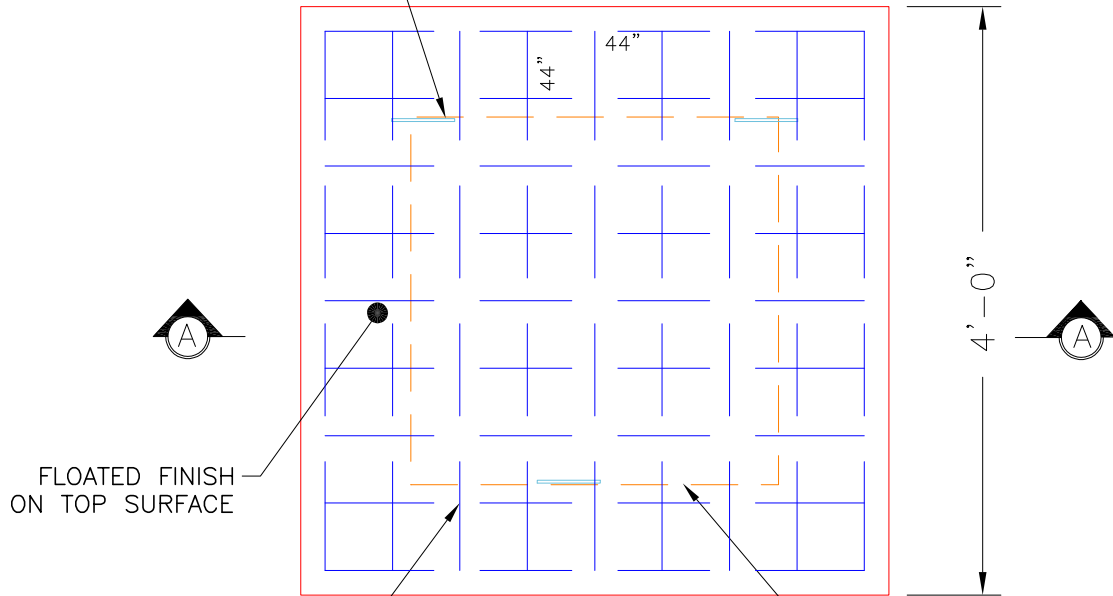

FLOATED FINISH
 ON TOP SURFACE

PLAN VIEW

#4 BAR @ 6"
 C/C E.W. (TYP.)

3/4" DEEP X 9" WIDE
 RECESS REQUIRED

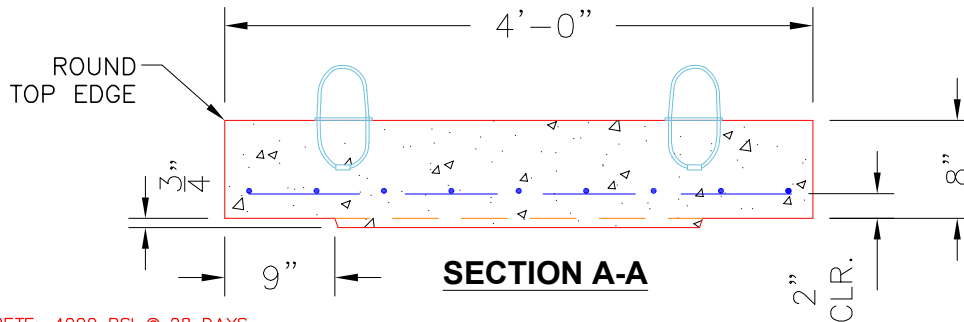

SECTION A-A

NOTES:

- CONCRETE: 4000 PSI @ 28 DAYS.
- MANUFACTURE TO KYTC SPECIFICATIONS.
- REINFORCING: #5 BAR @ 6" C/C E.W.—GRADE 60.
 (BOTTOM LAYER ONLY)
- 3 EA. CONAC WIRE LOOP LIFTERS REQUIRED.

#4 BAR CUT LIST
 18 EA. @ 44"

Coating (Int):
 Coating (Ext):

Seam Up: Flat
 Seam Dn: Flat

Wall Thickness: 8"

Height (Ext): 8"

Weight (Net): 1547 lb
 Volume (Net): 0.4cu.yd