

Job Name: 25-3505 KYTC Multi Co Call 200 (251117)	Plant: 100	Tech: J. Coppage - A	
Job Location: Contractor: Jim Smith Contracting Co, LLC	3/25/2026 8:52:15 AM	PC: Jay Ross Jarvis	

**Structure ID: 1726 22**

**P1 BX3648-08BAVF**

**BOX BASE 8inW, 8inF, Variable Ht**

- P2) 36" x 48" - P.I.P. - BY OTHERS - 8"
- P1) 36" x 48" - BOX BASE 8inW, 8inF, Variable Ht - 25"
- 1) CASTING - HOE KY-460 SET (DBI 5D)
- 1) 36" x 48" - Conseal CS-102 1.00"
- 1) Hole - 20

0 lb  
5380 lb  
460 lb  
0 lb  
0 lb  
-----  
Structure Total: 5840 lb

Structure Notes:  
**\*\*KYTC STATE PROJECT\*\***  
 1. HOE KY-460 SET (DBI 5D) PROVIDED BY ICAST.  
 2. KYTC DBI TYPE 5  
 3. PER ASTM C-913  
 - WALLS (As .31) #5 BARS AT 12" C.C.E.W..  
 - FLOOR (As .31) #5 BARS AT 12" C.C.E.W..  
 4. STUB #5 BARS 20" OUT TOP OF WALLS (SPA@12"C/C)

Rim: 429.3' Rim to Invert: 2.75' Slack: 0" Sump: 0" Step Position:

Position	Elev	Angle	Ext. (cw)	Pipe	Pipe OD	Connector	Hole	Horz Size	Up ( )	Offset
Invert 1	426.55'	270°	32"	15" HDPE	17.6"	Hole 20	20"	20"	-2.5"	0"
Invert 2										
Invert 3										
Invert 4										
Invert 5										
Invert 6										
Invert 7										
Invert 8										

RIGHT-SIDE UP VIEW (int. dimensions)

UPSIDE-DOWN VIEW (int. dimensions)

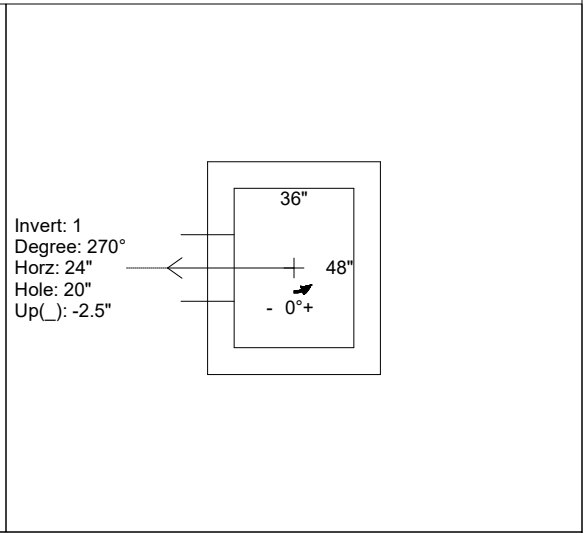
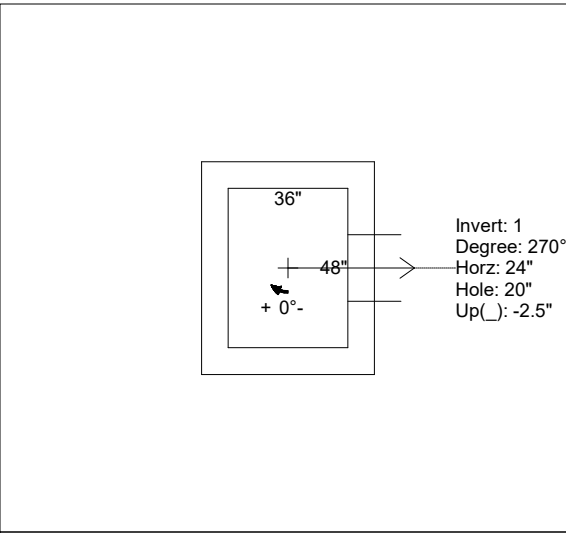
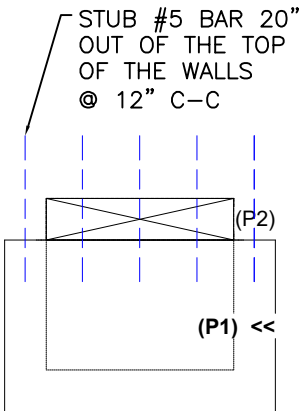

INSIDE WALL DIMENSIONS

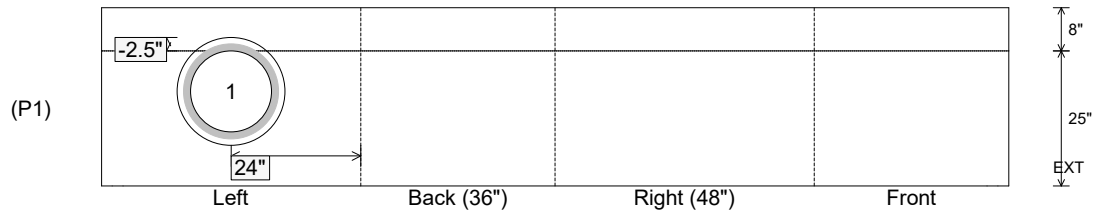

Coating (Int): Coating (Ext):	Seam Up: Flat Seam Dn: n/a	Wall Thickness: 8" Floor Height: 8"	Height (Int): 25" Height (Ext): 33"	Weight (Net): 5380 lb Volume (Net): 1.37cu.yd
----------------------------------	-------------------------------	--	--	--