

Job Name: 25-3479 - Phase 24 Wastewater System Improvements
 Job Location: Columbia, KY
 Contractor: Cumberland Pipeline LLC

Plant: 100
 3/26/2026 8:20:46 PM

Tech: J. Horsley - F
 PC: E. Bradley



Structure ID: Majestic W.W.

P1 MH096SBE12CDARED-1420D

MH SEPARATE BASE-T EXT. 14" (142" OD) w/ConBlock-CDA Red

P4) 96" - MH FLAT TOP w/36"x72" Hatch w/ConBlock-CDA Red F/G - 17"	9188 lb
P3) 96" - MH RISER w/ConBlock-CDA Red T/G - 78"	19269 lb
P2) 96" - MH RISER w/ConBlock-CDA Red T/G - 78"	18994 lb
P1) 96" - MH SEPARATE BASE-T EXT. 14" (142" OD) w/ConBlock-CDA Red T/n - 12"	20303 lb
1) ADMIXTURE CONBLOCK CDA RED	0 lb
1) HATCH (Alum.) - HALLIDAY W1S 36"x72"	135 lb
1) JOINT WRAP - 12" WD x 096" MAC WRAP	0 lb
3) 96" - Conseal CS-231 1.00" (Double)	0 lb
1) 36" x 72" - Conseal CS-231 1.00" (Double)	0 lb
1) A-Lok - 0820	1 lb
1) A-Lok - 0160	1 lb
2) Quik-Lok - QL-06-C	2 lb
Structure Total:	67893 lb

Structure Notes:

- PER ASTM C478 SPECIFICATIONS.
- CONCRETE = 4,500 PSI AT 28 DAYS.
- ADMIXTURE = CONBLOCK CDA RED.
- NO STEPS AND NO INVERT CHANNEL.
- CASTING BY ICAST (HALLIDAY W1S 36"x72")

REINFORCING PER ASTM A615 (GRADE 60).
 - TOP SLAB = H20 LOADING.
 - RISER/WALLS (As .24)
 - FLOOR (As .31) #5 BARS AT 12" C.C.E.W.

Rim: 675.89' Rim to Invert: 11.3' Slack: 0.04" Sump: 37.44" Step Position:

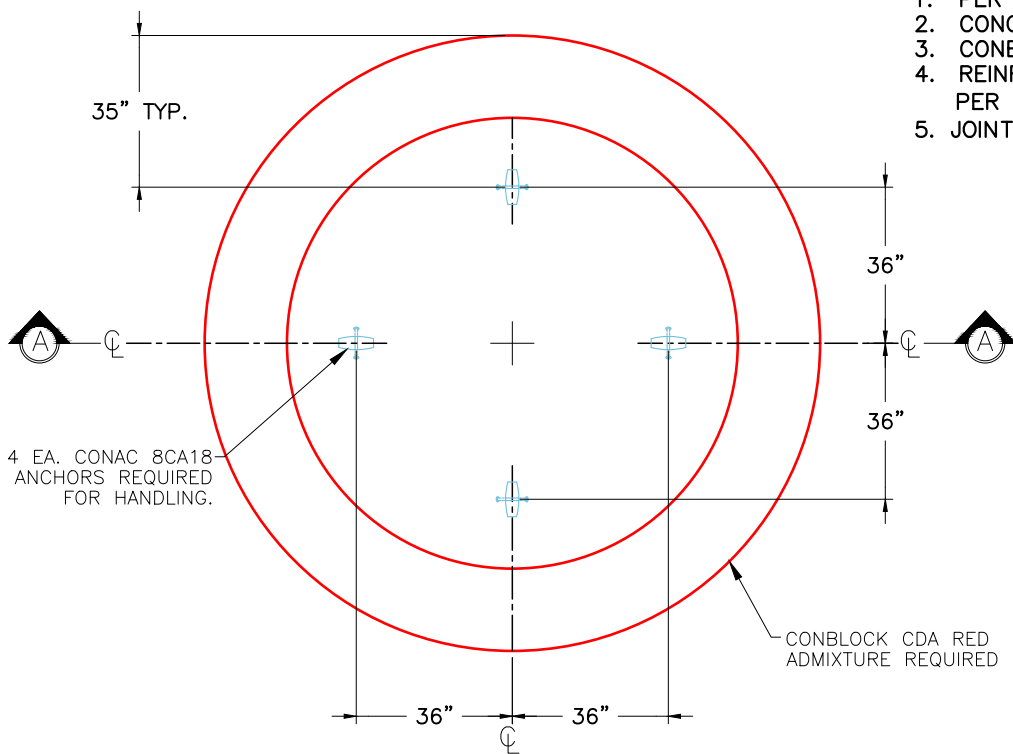

PLAN VIEW

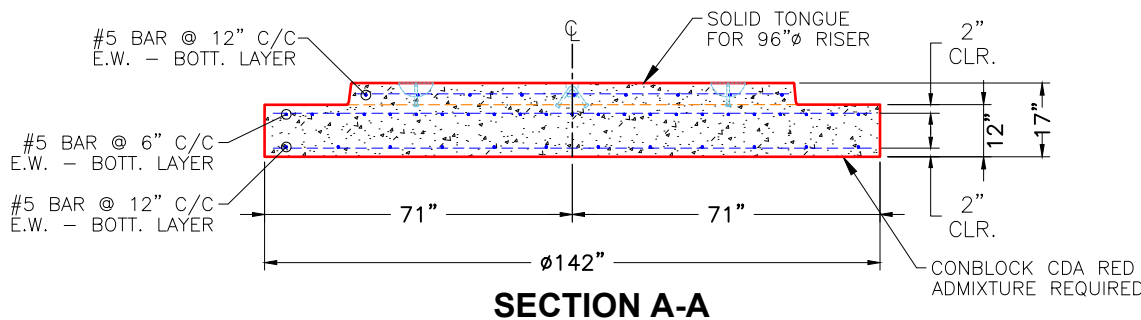

SECTION A-A

NOTES:

- PER ASTM C-478 LATEST REVISION
- CONCRETE: 4,500 PSI AT 28 DAYS.
- CONBLOCK CDA RED ADMIXTURE REQUIRED
- REINFORCEMENT: AS SHOWN BELOW. PER ASTM A615 (GRADE 60)
- JOINT SEALANT - 1" CS-231-DOUBLE

Coating (Int): Coating (Ext):	Seam Up: Tongue Seam Dn: n/a	Wall Thickness: 9" Floor Height: 12"	Height (Int): 0" Height (Ext): 0"	Weight (Net): 20303 lb Volume (Net): 5.19cu.yd
----------------------------------	---------------------------------	-----------------------------------------	--------------------------------------	---------------------------------------------------