

Structure ID: SI 1

P1 MH048BAVF

MH BASE Custom Ht F/n

- P3) 24" x 30" - CASTING HEIGHT - 6"
- P2) 48" - MH FLAT TOP w/24"x30" Hole F/F - 7"
- P1) 48" - MH BASE Custom Ht F/n - 31"
- 1) CASTING - HOE 360 L Vane Set (F/G/H)
- 1) 48" - Conseal CS-102 1.00"
- 1) 24" x 30" - Conseal CS-102 1.00"
- 2) Hole - 16"

0 lb
 1129 lb
 3324 lb
 362 lb
 0 lb
 0 lb

 0 lb
 Structure Total: 4815 lb

- Structure Notes:
1. PER ASTM C-478 SPECIFICATIONS
 2. CONCRETE: 4,000 PSI AT 28 DAYS
 3. REINFORCEMENT: PER ASTM A615
 4. NO STORM INVERT
 5. NO STEPS
 6. HOE 360 FRAME, L-VANE GRATE, & CURB HOOD SUPPLIED BY ICAST

Rim: 393.97' Rim to Invert: 3.6' Slack: 0.45" Sump: 1.25" Step Position:

Position	Elev	Angle	Ext. (cw)	Pipe	Pipe OD	Connector	Hole	Horz Size	Up (⌋)	Offset
Invert 1	390.37'	0°	0"	12" HDPE	14.5"	Hole 16	16"	16.312"	0"	0"
Invert 2	390.37'	168°	85"	12" HDPE	14.5"	Hole 16	16"	16.312"	0"	0"
Invert 3										
Invert 4										
Invert 5										
Invert 6										
Invert 7										
Invert 8										

RIGHT-SIDE UP VIEW (int. dimensions)

UPSIDE-DOWN VIEW (int. dimensions)

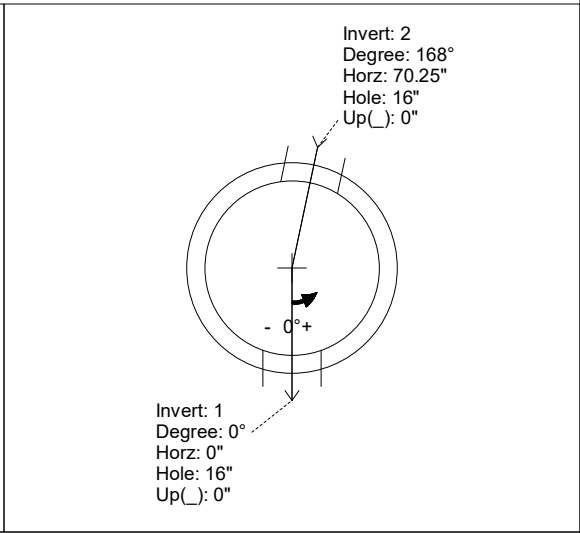
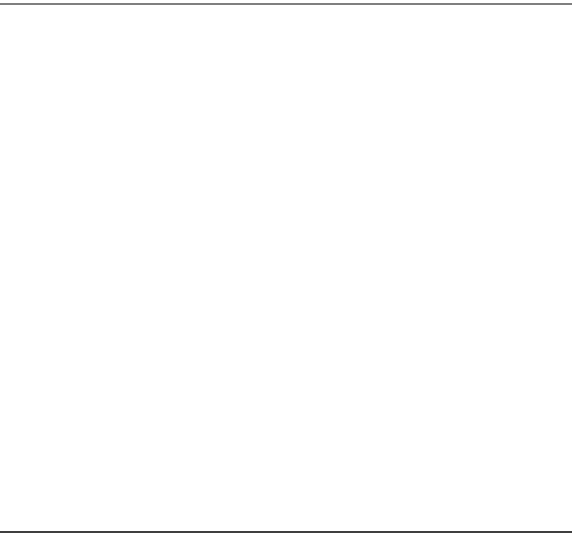
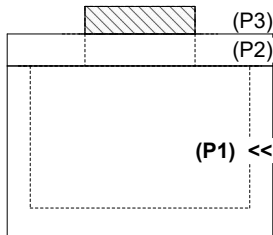

INSIDE WALL DIMENSIONS

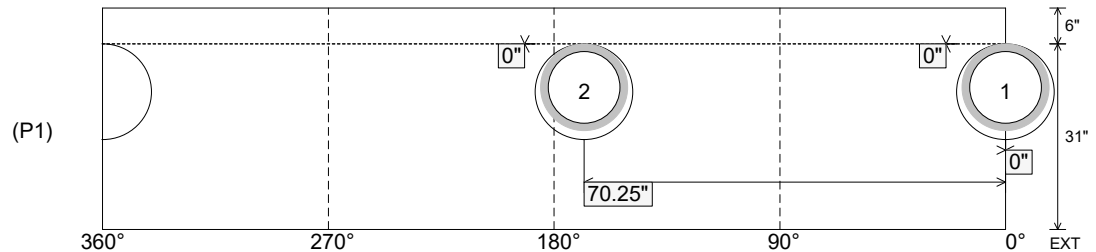

Coating (Int): Coating (Ext):	Seam Up: Flat Seam Dn: n/a	Wall Thickness: 5" Floor Height: 6"	Height (Int): 31" Height (Ext): 37"	Weight (Net): 3324 lb Volume (Net): 0.85cu.yd
----------------------------------	-------------------------------	--	--	--