

3 EA. M.A. INDUSTRIES PULLING IRONS WITH POCKETS (SUPPLIED BY ICAST) - INSTALLED IN FLOOR

PLAN VIEW

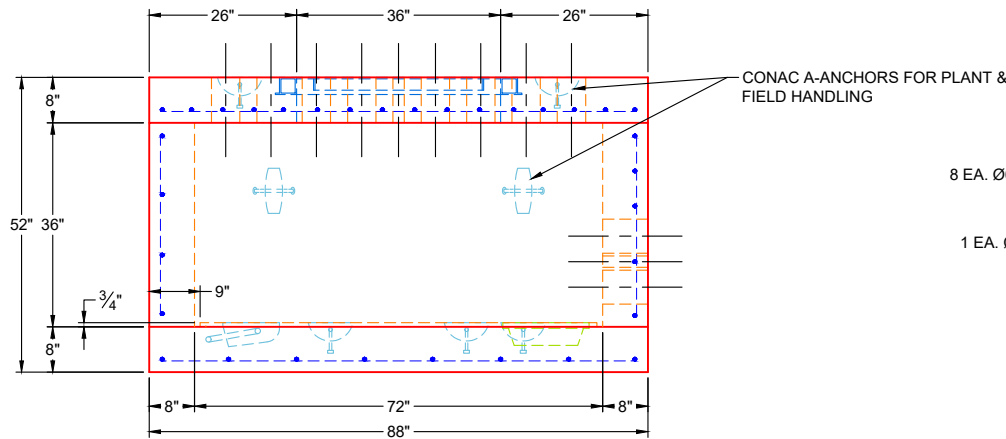

FRONT VIEW

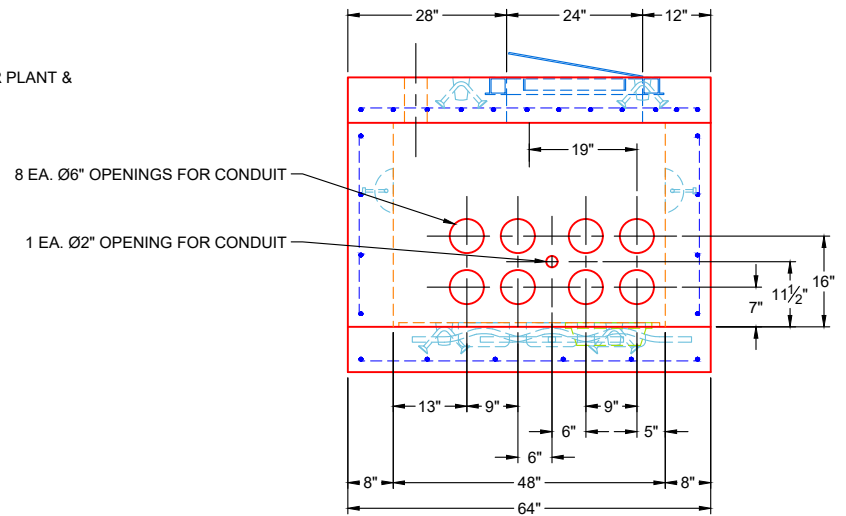

SIDE VIEW

GENERAL NOTES:

1. MANUFACTURED TO ASTM C-913 (LATEST REVISION)
2. CONCRETE: 5,000 PSI AT 28 DAYS
3. REINFORCEMENT:
 - FLAT LID: #5 BAR @ 6" C.C. E.W. (GRADE 60)
 - RISER: #5 BAR @ 12" C.C. E.W. (GRADE 60)
 - SEPARATE BASE SLAB: #5 BAR @ 12" C.C. E.W. (GRADE 60)
4. WEIGHTS:

8" FLAT LID	3,160 LBS
36" RISER	6,400 LBS
SEPARATE BASE SLAB	3,990 LBS
TOTAL WEIGHT	13,550 LBS
5. CONTRACTOR TO VERIFY ALL DIMENSIONS BEFORE MANUFACTURE
6. HALLIDAY W1S 24" X 36" HATCH SUPPLIED BY ICAST - HATCH TO BE CAST INTO FLAT LID
7. PA INSERT CO. SUMP PAN SUPPLIED BY ICAST - TO BE CAST INTO BASE FLOOR
8. JOINT SEALANT: CONSEAL CS-102 - 1" (PRIMARY & SECONDARY ROWS)
EXTERIOR WRAP: CONSEAL CS-212 - 6" WIDE

REVISION INFORMATION

REV. DATE:	NO REVISIONS TO DATE



SUBMITTAL DRAWING: 48" X 72" ELECTRICAL VAULT		
CUSTOMER: GARDNER ELECTRIC SERVICE		
PROJECT: CUSTOM ELECTRICAL VAULT		
STRUCTURE: ELECTRICAL VAULT		
QUOTE/SALES ORDER NO: 25-3432		
CHECKED BY: B. SMITH	DRAWN BY: K. CARDWELL	
DATE: 11/11/25	SCALE: NTS	PG. 1 OF 1