

Job Name: 25-3431 Plano Bridleton Farms Storm
 Job Location: Bowling Green, KY
 Contractor: J & J Concrete & Excavating, LLC

Plant: Beaver Dam
 10/30/2025 11:31:47 AM

Tech: C.Russ
 PC: E.Bradley



Structure ID: ST-B1

P1 BX30168-08AVF

BOX BASE 8inW, 8inF, Variable Ht

- P3) 24" x 36" - CASTING HEIGHT - 6.25"
- P2) 30" x 168" - BX FLAT LID 8inW w/24"x36" HOLE - 8"
- P1) 30" x 168" - BOX BASE 8inW, 8inF, Variable Ht - 66"
- 1) CASTING - EJ 4510 F/G
- 1) 24" x 36" - SGL 1"x14.5' Butyl
- 5) Hole - 48 x 34
- 1) Hole - 34

Structure Notes:
 1. PER ASTM C913 SPECIFICATIONS.
 2. CONCRETE = 4,000 PSI AT 28 DAYS.
 3. EJ 4510 F/G BY ICAST

REINFORCING PER ASTM A615 (GRADE 60).
 - TOP SLAB (As .62) #5 BARS AT 6" C.C.E.W..
 - RISER/WALLS (As .36) #5 BARS AT 8" C.C.E.W..
 - FLOOR (As .47) #5 BARS AT 8" C.C.E.W.

HANDLE W/ 4 EA. CONAC 5CA14 ANCHORS IN THE FLOOR

Structure Total: 25322 lb

FIRST POUR DRAWING

Rim: 603.4' Rim to Invert: 6.97' Slack: 3.39" Sump: 0" Step Position: 0°

Position	Elev	Angle	Ext. (cw)	Pipe	Pipe OD	Connector	Hole	Horz Size	Up ()	Offset
Invert 1	596.43'	90°	40"	38" x 24" ELL RCP	45.5" x 31.5"	Hole 48 x 34	48" x 34"	48"	-3.75"	-52"
Invert 2	596.43'	90°	92"	38" x 24" ELL RCP	45.5" x 31.5"	Hole 48 x 34	48" x 34"	48"	-3.75"	0"
Invert 3	596.43'	90°	144"	38" x 24" ELL RCP	45.5" x 31.5"	Hole 48 x 34	48" x 34"	48"	-3.75"	52"
Invert 4	596.73'	0°	23"	24" RCP B WALL	30"	Hole 34	34"	32"	0.6"	0"
Invert 5	596.43'	250°	55.96"	38" x 24" ELL RCP	45.5" x 31.5"	Hole 48 x 34	48" x 34"	51.081"	-3.75"	-26"
Invert 6	596.43'	250°	111.297"	38" x 24" ELL RCP	45.5" x 31.5"	Hole 48 x 34	48" x 34"	51.081"	-3.75"	26"
Invert 7										
Invert 8										

RIGHT-SIDE UP VIEW (int. dimensions)

UPSIDE-DOWN VIEW (int. dimensions)

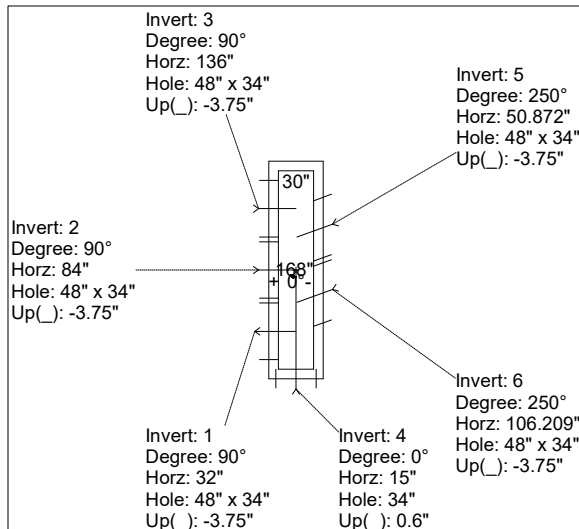

WEIGHTS

FIRST POUR: 5,681 LBS
SECOND POUR: 14,093 LBS
TOTAL: 19,775 LBS

INSIDE WALL DIMENSIONS

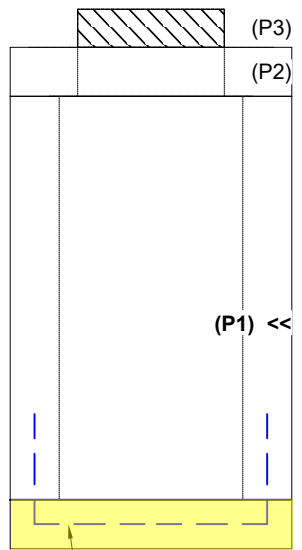
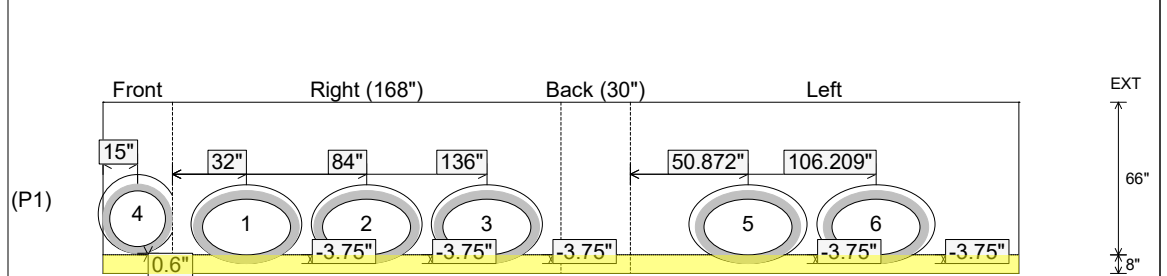

18" X 18" #5 BAR @ 12" ON CENTER TIED INTO THE MAT

Coating (Int): Coating (Ext):	Seam Up: Flat Seam Dn: n/a	Wall Thickness: 8" Floor Height: 8"	Height (Int): 66" Height (Ext): 74"	Weight (Net): 19775 lb Volume (Net): 5.05cu.yd
----------------------------------	-------------------------------	--	--	---

Job Name: 25-3431 Plano Bridleton Farms Storm
 Job Location: Bowling Green, KY
 Contractor: J & J Concrete & Excavating, LLC

Plant: Beaver Dam
 10/30/2025 11:31:47 AM

Tech: C.Russ
 PC: E.Bradley



Structure ID: ST-B1

P1 BX30168-08AVF

BOX BASE 8inW, 8inF, Variable Ht

- P3) 24" x 36" - CASTING HEIGHT - 6.25"
- P2) 30" x 168" - BX FLAT LID 8inW w/24"x36" HOLE - 8"
- P1) 30" x 168" - BOX BASE 8inW, 8inF, Variable Ht - 66"
- 1) CASTING - EJ 4510 F/G
- 1) 24" x 36" - SGL 1"x14.5' Butyl
- 5) Hole - 48 x 34
- 1) Hole - 34

Structure Notes:
 1. PER ASTM C913 SPECIFICATIONS.
 2. CONCRETE = 4,000 PSI AT 28 DAYS.
 3. EJ 4510 F/G BY ICAST

REINFORCING PER ASTM A615 (GRADE 60).
 - TOP SLAB (As .62) #5 BARS AT 6" C.C.E.W..
 - RISER/WALLS (As .36) #5 BARS AT 8" C.C.E.W..
 - FLOOR (As .47) #5 BARS AT 8" C.C.E.W.

HANDLE W/ 4 EA. CONAC 5CA14 ANCHORS IN THE FLOOR

Structure Total: 25322 lb

SECOND POUR DRAWING

Rim: 603.4' Rim to Invert: 6.97' Slack: 3.39" Sump: 0" Step Position: 0°

Position	Elev	Angle	Ext. (cw)	Pipe	Pipe OD	Connector	Hole	Horz Size	Up ()	Offset
Invert 1	596.43'	90°	40"	38" x 24" ELL RCP	45.5" x 31.5"	Hole 48 x 34	48" x 34"	48"	-3.75"	-52"
Invert 2	596.43'	90°	92"	38" x 24" ELL RCP	45.5" x 31.5"	Hole 48 x 34	48" x 34"	48"	-3.75"	0"
Invert 3	596.43'	90°	144"	38" x 24" ELL RCP	45.5" x 31.5"	Hole 48 x 34	48" x 34"	48"	-3.75"	52"
Invert 4	596.73'	0°	23"	24" RCP B WALL	30"	Hole 34	34"	32"	0.6"	0"
Invert 5	596.43'	250°	55.96"	38" x 24" ELL RCP	45.5" x 31.5"	Hole 48 x 34	48" x 34"	51.081"	-3.75"	-26"
Invert 6	596.43'	250°	111.297"	38" x 24" ELL RCP	45.5" x 31.5"	Hole 48 x 34	48" x 34"	51.081"	-3.75"	26"
Invert 7										
Invert 8										

RIGHT-SIDE UP VIEW (int. dimensions)

UPSIDE-DOWN VIEW (int. dimensions)

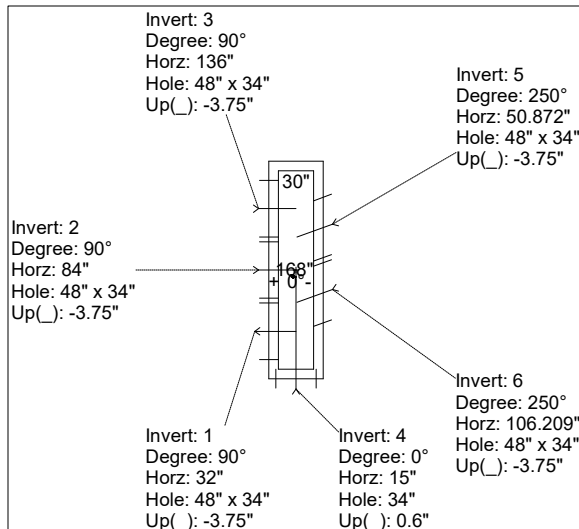
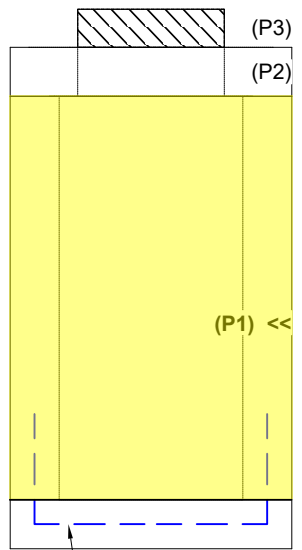

WEIGHTS
FIRST POUR: 5,681 LBS
SECOND POUR: 14,093 LBS
TOTAL: 19,775 LBS

INSIDE WALL DIMENSIONS

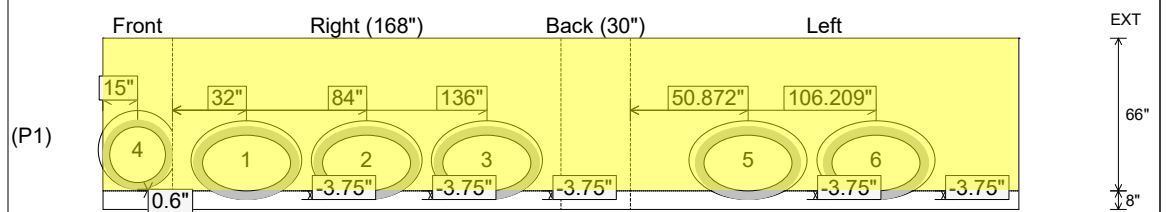

18" X 18" #5 BAR @ 12" ON CENTER TIED INTO THE MAT

Coating (Int): Coating (Ext):	Seam Up: Flat Seam Dn: n/a	Wall Thickness: 8" Floor Height: 8"	Height (Int): 66" Height (Ext): 74"	Weight (Net): 19775 lb Volume (Net): 5.05cu.yd
----------------------------------	-------------------------------	--	--	---