

Job Name: 25-3431 Plano Bridleton Farms Storm
 Job Location: Bowling Green, KY
 Contractor: J & J Concrete & Excavating, LLC

Plant: Beaver Dam
 10/30/2025 11:31:45 AM

Tech: C.Russ
 PC: E.Bradley



Structure ID: ST-A3

P1 BX30108-08BAVF

BOX BASE 8inW, 8inF, Variable Ht

- P3) 24" x 36" - CASTING HEIGHT - 6.25"
- P2) 30" x 108" - BX FLAT LID 8inW w/24"x36" HOLE - 6"
- P1) 30" x 108" - BOX BASE 8inW, 8inF, Variable Ht - 28"
- 1) CASTING - EJ 4510 F/G
- 1) 24" x 36" - SGL 1"x14.5' Butyl
- 4) DOGHOUSE INVRTD (ELLIP) - 48"x31"

Structure Notes:
 1. PER ASTM C913 SPECIFICATIONS.
 2. CONCRETE = 4,000 PSI AT 28 DAYS.
 3. EJ 4510 F/G BY ICAST

REINFORCING PER ASTM A615 (GRADE 60).
 - TOP SLAB (As .62) #5 BARS AT 6" C.C.E.W..
 - RISER/WALLS (As .36) #5 BARS AT 8" C.C.E.W..
 - FLOOR (As .47) #5 BARS AT 8" C.C.E.W.

0 lb
 2437 lb
 5955 lb
 445 lb
 0 lb
 0 lb

 Structure Total: 8837 lb

HANDLE W/ 4 EA. CONAC 5CA14 ANCHORS IN THE FLOOR

FIRST POUR DRAWING

Rim: 601.72' Rim to Invert: 3.36' Slack: 0.07" Sump: 0" Step Position: 0°

Position	Elev	Angle	Ext. (cw)	Pipe	Pipe OD	Connector	Hole	Horz Size	Up ()	Offset
Invert 1	598.36'	90°	88"	38" x 24" ELL RCP	45.5" x 31.5"	DOGHOUSE INVRTD (ELLIP) 48"x31"	48" x 31"	48"	-3.75"	26"
Invert 2	598.36'	90°	36"	38" x 24" ELL RCP	45.5" x 31.5"	DOGHOUSE INVRTD (ELLIP) 48"x31"	48" x 31"	48"	-3.75"	-26"
Invert 3	598.36'	270°	88"	38" x 24" ELL RCP	45.5" x 31.5"	DOGHOUSE INVRTD (ELLIP) 48"x31"	48" x 31"	48"	-3.75"	26"
Invert 4	598.36'	270°	36"	38" x 24" ELL RCP	45.5" x 31.5"	DOGHOUSE INVRTD (ELLIP) 48"x31"	48" x 31"	48"	-3.75"	-26"
Invert 5										
Invert 6										
Invert 7										
Invert 8										

RIGHT-SIDE UP VIEW (int. dimensions)

UPSIDE-DOWN VIEW (int. dimensions)

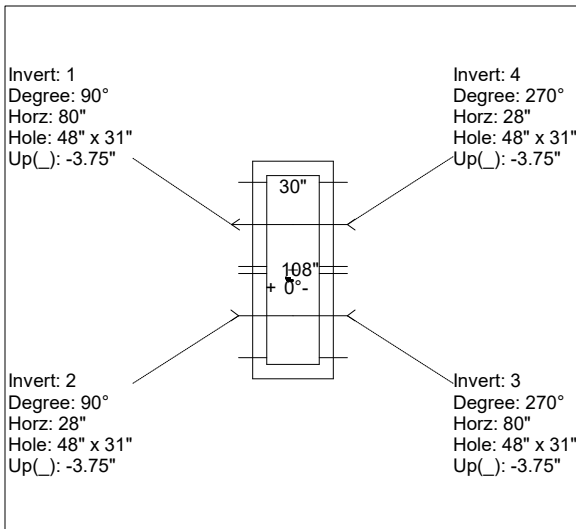

WEIGHTS

FIRST POUR: 3,829 LBS
SECOND POUR: 2,126 LBS
TOTAL: 5,955 LBS

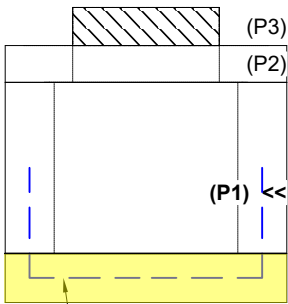

18" X 18" #5 BAR
 @ 12" ON CENTER
 TIED INTO THE MAT

INSIDE WALL DIMENSIONS

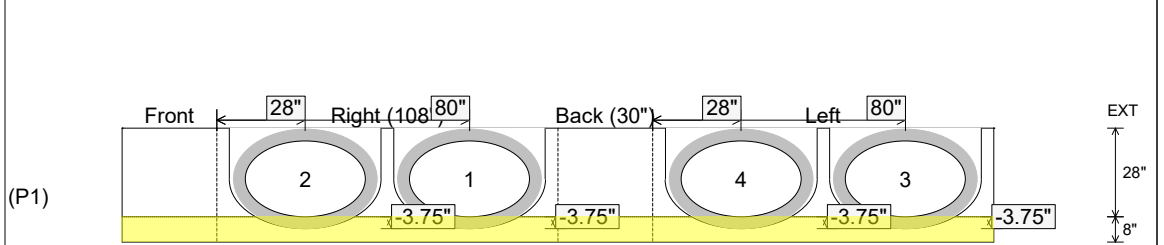

Coating (Int): Coating (Ext):	Seam Up: Flat Seam Dn: n/a	Wall Thickness: 8" Floor Height: 8"	Height (Int): 28" Height (Ext): 36"	Weight (Net): 5955 lb Volume (Net): 1.52cu.yd
----------------------------------	-------------------------------	--	--	--

Job Name: 25-3431 Plano Bridleton Farms Storm
 Job Location: Bowling Green, KY
 Contractor: J & J Concrete & Excavating, LLC

Plant: Beaver Dam
 10/30/2025 11:31:45 AM

Tech: C.Russ
 PC: E.Bradley



Structure ID: ST-A3

P1 BX30108-08BAVF

BOX BASE 8inW, 8inF, Variable Ht

- P3) 24" x 36" - CASTING HEIGHT - 6.25"
- P2) 30" x 108" - BX FLAT LID 8inW w/24"x36" HOLE - 6"
- P1) 30" x 108" - BOX BASE 8inW, 8inF, Variable Ht - 28"
- 1) CASTING - EJ 4510 F/G
- 1) 24" x 36" - SGL 1"x14.5' Butyl
- 4) DOGHOUSE INVRTD (ELLIP) - 48"x31"

Structure Notes:
 1. PER ASTM C913 SPECIFICATIONS.
 2. CONCRETE = 4,000 PSI AT 28 DAYS.
 3. EJ 4510 F/G BY ICAST

REINFORCING PER ASTM A615 (GRADE 60).
 - TOP SLAB (As .62) #5 BARS AT 6" C.C.E.W..
 - RISER/WALLS (As .36) #5 BARS AT 8" C.C.E.W..
 - FLOOR (As .47) #5 BARS AT 8" C.C.E.W.

0 lb
 2437 lb
 5955 lb
 445 lb
 0 lb
 0 lb

 Structure Total: 8837 lb

HANDLE W/ 4 EA. CONAC 5CA14 ANCHORS IN THE FLOOR

SECOND POUR DRAWING

Rim: 601.72' Rim to Invert: 3.36' Slack: 0.07" Sump: 0" Step Position: 0°

Position	Elev	Angle	Ext. (cw)	Pipe	Pipe OD	Connector	Hole	Horz Size	Up ()	Offset
Invert 1	598.36'	90°	88"	38" x 24" ELL RCP	45.5" x 31.5"	DOGHOUSE INVRTD (ELLIP) 48"x31"	48" x 31"	48"	-3.75"	26"
Invert 2	598.36'	90°	36"	38" x 24" ELL RCP	45.5" x 31.5"	DOGHOUSE INVRTD (ELLIP) 48"x31"	48" x 31"	48"	-3.75"	-26"
Invert 3	598.36'	270°	88"	38" x 24" ELL RCP	45.5" x 31.5"	DOGHOUSE INVRTD (ELLIP) 48"x31"	48" x 31"	48"	-3.75"	26"
Invert 4	598.36'	270°	36"	38" x 24" ELL RCP	45.5" x 31.5"	DOGHOUSE INVRTD (ELLIP) 48"x31"	48" x 31"	48"	-3.75"	-26"
Invert 5										
Invert 6										
Invert 7										
Invert 8										

RIGHT-SIDE UP VIEW (int. dimensions)

UPSIDE-DOWN VIEW (int. dimensions)

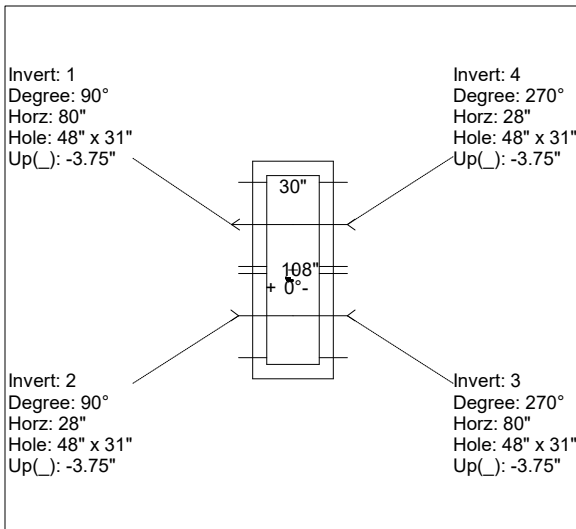

WEIGHTS
FIRST POUR: 3,829 LBS
SECOND POUR: 2,126 LBS
TOTAL: 5,955 LBS

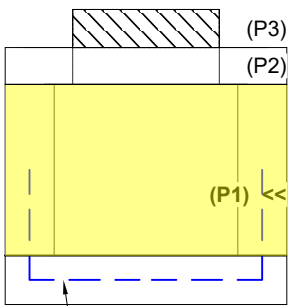

18" X 18" #5 BAR
 @ 12" ON CENTER
 TIED INTO THE MAT

INSIDE WALL DIMENSIONS

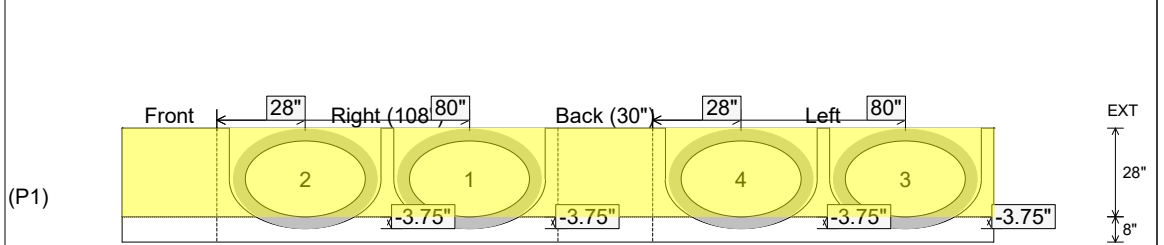

Coating (Int): Coating (Ext):	Seam Up: Flat Seam Dn: n/a	Wall Thickness: 8" Floor Height: 8"	Height (Int): 28" Height (Ext): 36"	Weight (Net): 5955 lb Volume (Net): 1.52cu.yd
----------------------------------	-------------------------------	--	--	--