

25-3415B - LEFT HAND
Fairbanks Softball & Baseball Dugouts
Product ID - CVW
Wall - WP-06
Weight - 1,520 LBS Each
1 Required

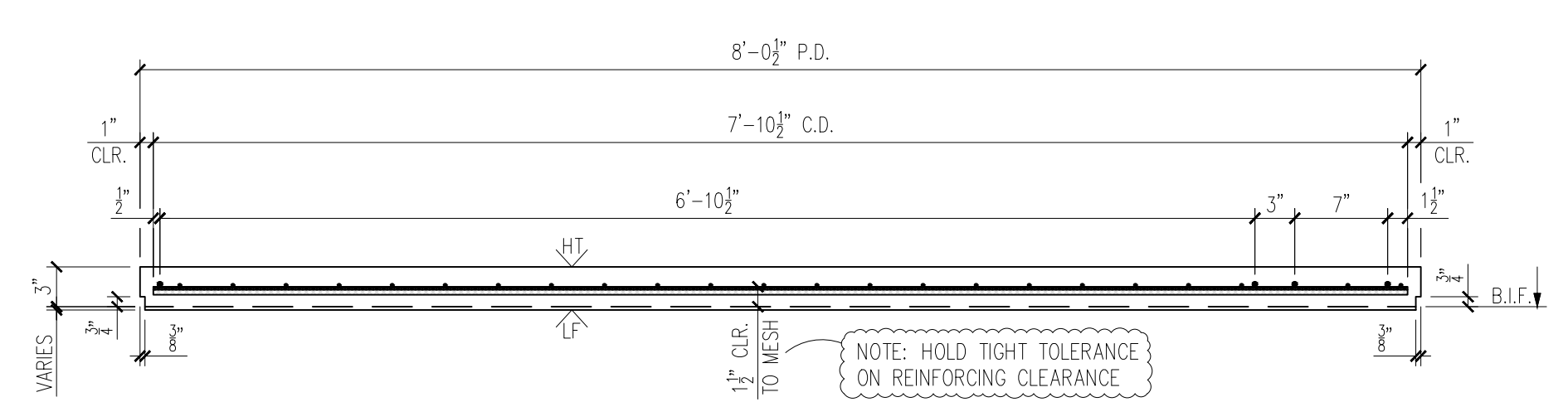

BILL OF MATERIALS		
MARK #	DESCRIPTION	QTY
P201G	A36 STEEL 4"x4"x1/4" W/(2) 3/8"Øx1 1/2" HAS W/ 1'-4" BENT REBAR (GALV.)	9
P103G	2 TON RL-4 TECH ERECTION ANCHOR (79527SP) (GALV.)	2
P9000P	3'-0" X 6'-8" LHR 3" DOOR FRAME	1

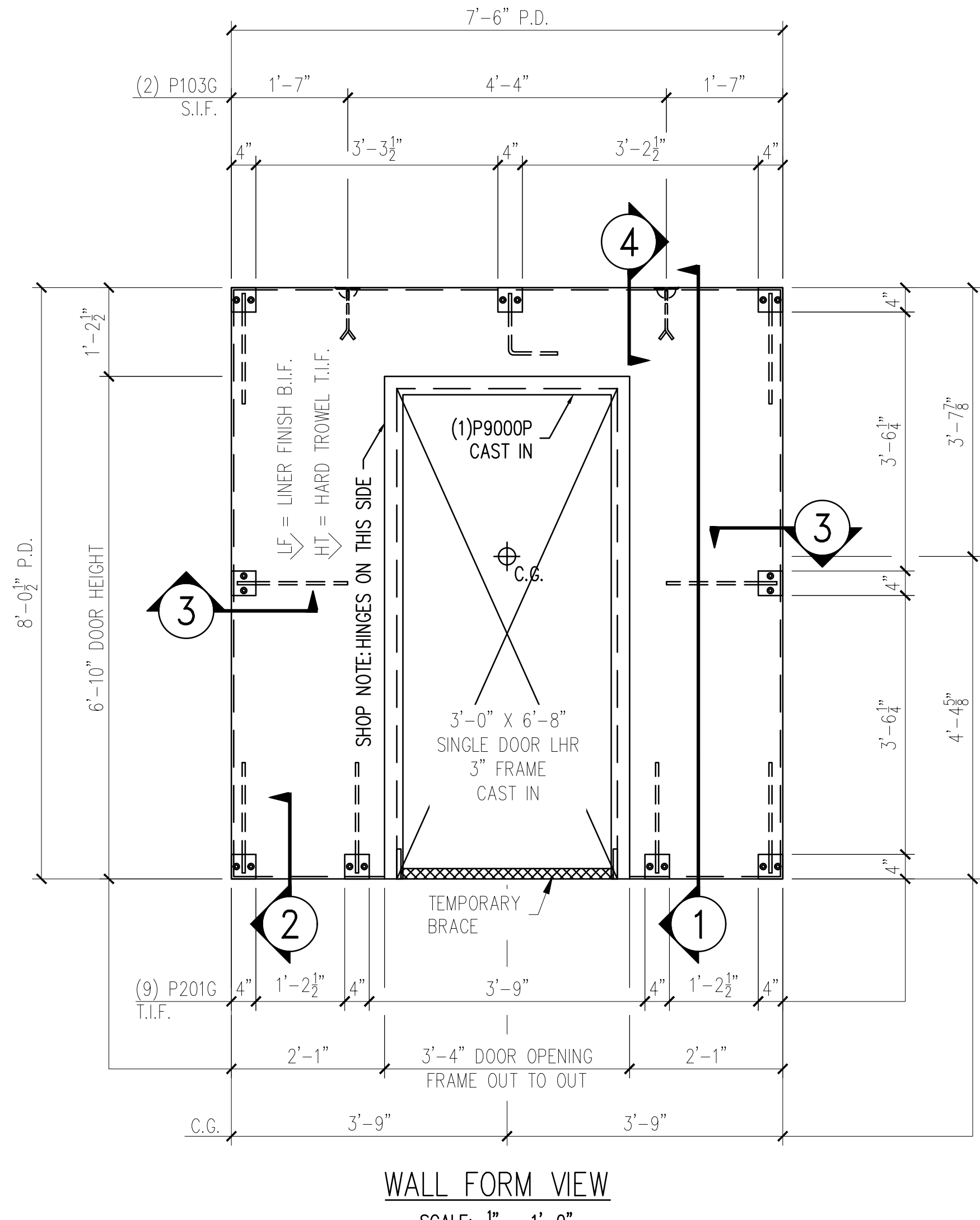
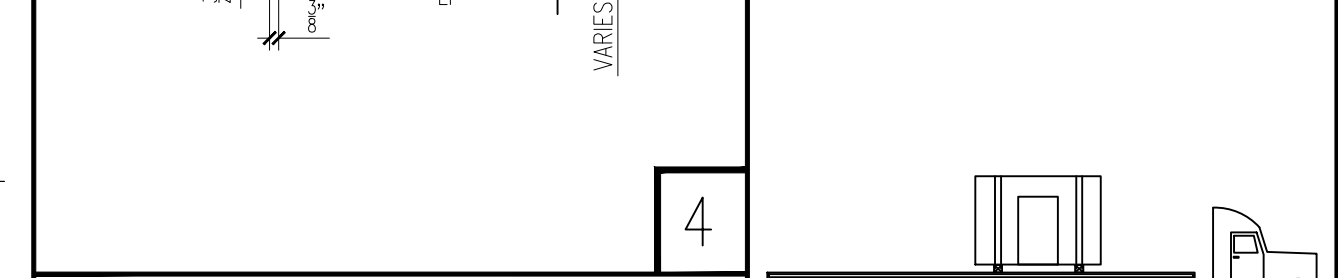
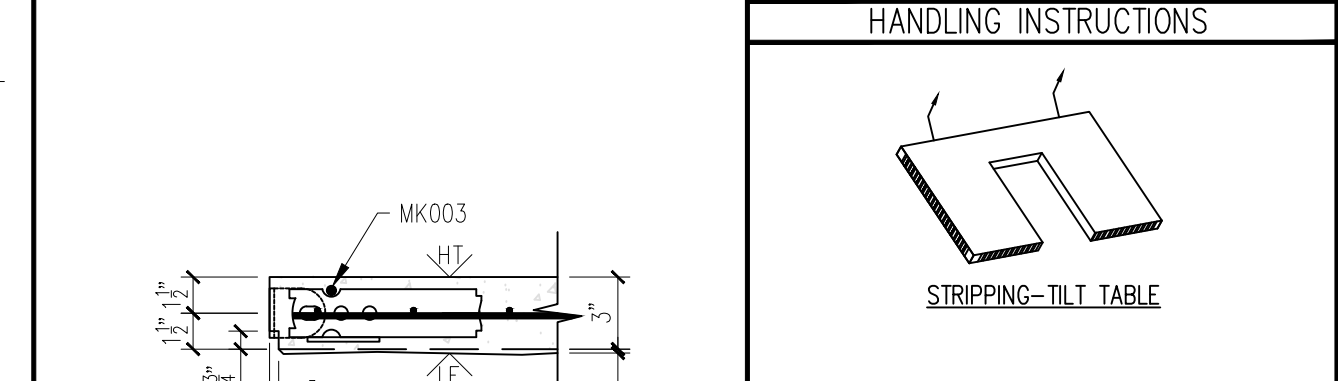

REV	INI.	DESCRIPTION	DATE
1	-	-	-
2	-	-	-
3	-	-	-
4	-	-	-
5	-	-	-

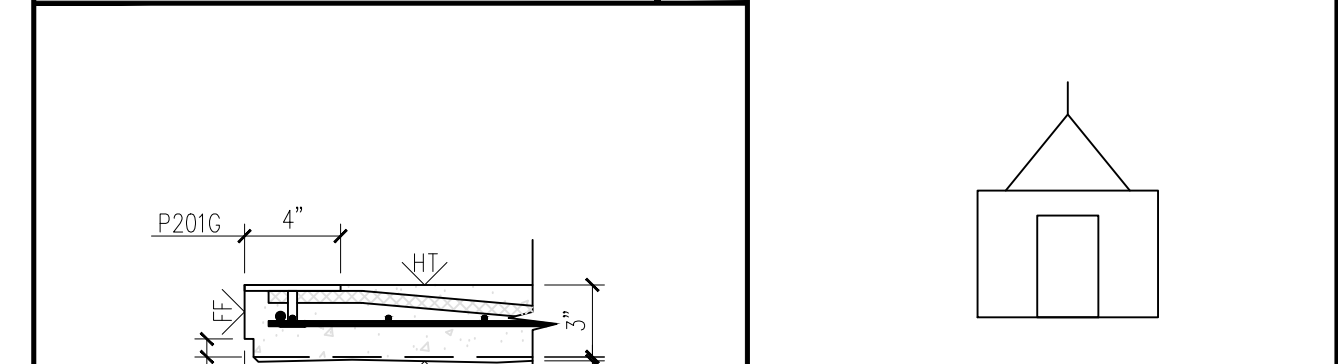

CONCRETE INSTRUCTIONS	
CONCRETE RELEASE @:	2,500 P.S.I.
CONCRETE @ 28 DAYS:	5,000 P.S.I.
POST-TENSION @:	3,500 P.S.I.
CONCRETE MIXES	
CONCRETE - GRAY	VOLUME = 0.37 C.Y.
CONCRETE - MIX 1	VOLUME = - C.Y.
CONCRETE - MIX 2	VOLUME = - C.Y.
SOFT SOUND	VOLUME = - C.Y.
TOTALS	VOLUME = 0.37 C.Y.
WEIGHT:	1,520 LBS.

FINISHING INSTRUCTIONS	
LF = LINER FINISH	
HT = HARD TROWEL FINISH	
FF = FORM FINISH	
L = 7'-6"	SQ.FT.(T.I.F.) = 37.33
W = 8'-0 1/2"	SQ.FT.(T.I.F.) = -
D = 3"	SQ.FT.(T.I.F.) = -
CONTROL NUMBERS:	
-	-
-	-

MESSAGE CENTER	
1. REFER TO DETAILS FOR REINFORCEMENT/CABLE PLACEMENT	
2. SHOP TICKET SHOWS EXTERIOR FACE OF PANEL CAST FACE DOWN	
CHECKED BY:	DATE:
APPROVED BY:	DATE:

EASI-SET® WORLDWIDE
 5119 Catlett Rd. • Midland, VA 22728 • info@EasiSet.com
 www.EasiSet.com • 800-547-4045 • Fax 540-439-2541

PROJECT: 38'x8' EASI-SET DUGOUT
 FAIRBANKS DUGOUTS
 MILFORD CENTER, OH
 CONTRACTOR: LEVAN'S EXCAVATING, INC.

SCALE: NTS
 DRAWN BY: FTL
 CHECK BY: WCR
 ISSUE DATE: 01.07.26
 PIECE MARK: WP-06

1

5

4

3

2

MESSAGE CENTER

- REFER TO DETAILS FOR REINFORCEMENT/CABLE PLACEMENT
- SHOP TICKET SHOWS EXTERIOR FACE OF PANEL CAST FACE DOWN

CHECKED BY: DATE:
 APPROVED BY: DATE:

PRODUCT	SALES ORDER NUMBER
ESW BUILDING	-
SHEET NUMBER	NUMBER REQUIRED
1 OF 2	1

25-3415B - LEFT HAND
Fairbanks Softball & Baseball Dugouts
Product ID - CVW
Wall - WP-06
Weight - 1,520 LBS Each
1 Required

SHOP NOTE:
 DIMENSIONS PROVIDED ARE PULLED FROM EDGE OF
 CAGE TO CENTERLINE OF REBAR AND TO CENTER
 OF REBAR TO CENTER OF REBAR

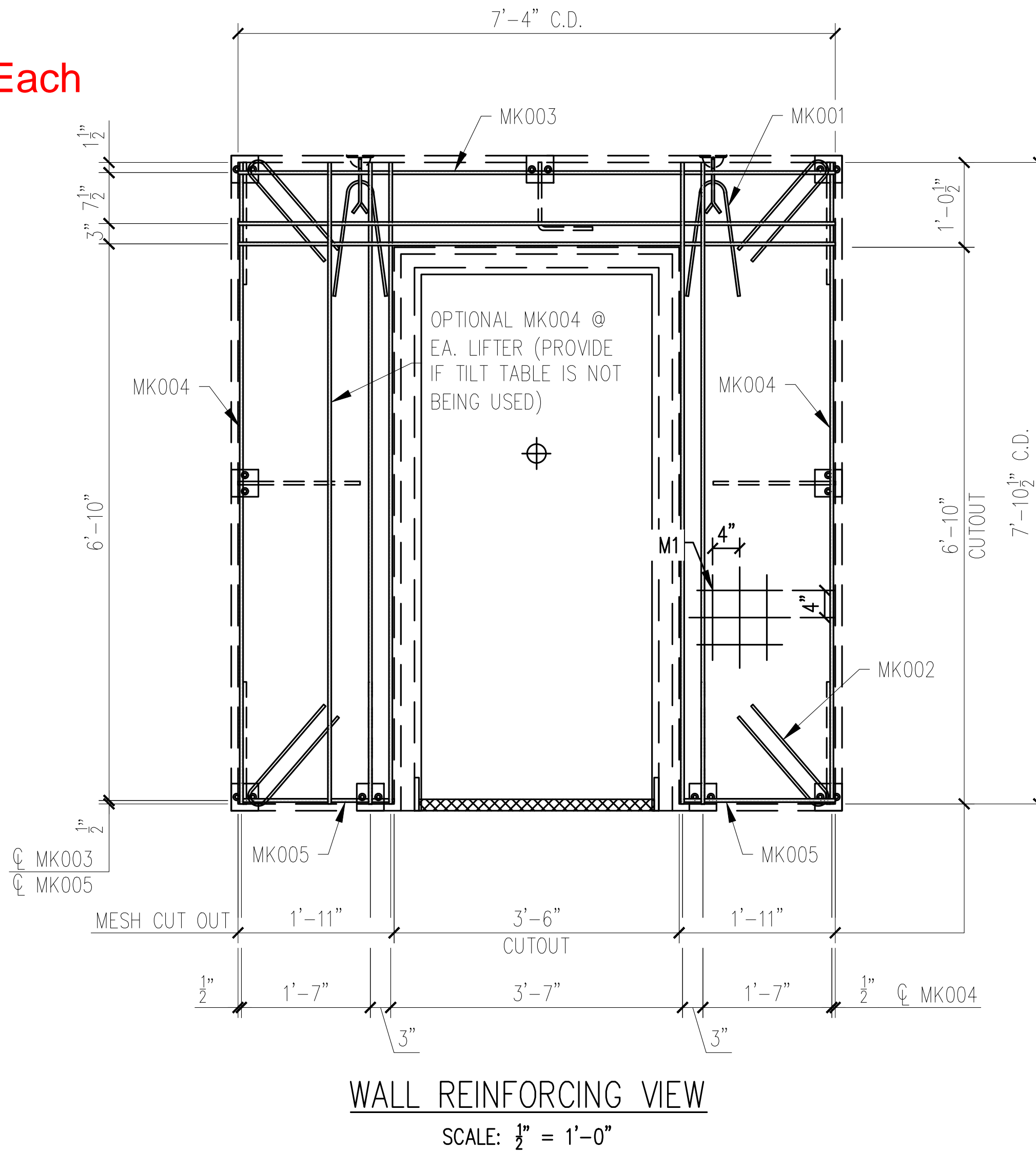

REINFORCING SCHEDULE		
MARK #	DESCRIPTION	QTY.
MK001	#3 X 3'-0"	2
MK002	#3 X 3'-1"	4
MK003	#3 X 7'-4"	3
MK004	#3 X 7'-10 1/2"	6
MK005	#3 X 1'-11"	2
MESH SCHEDULE		
MARK #	DESCRIPTION	QTY.
M1	W4XW4 4"x4" WWF 7'-10 1/2" x 7'-4"	1

EASI-SET® WORLDWIDE
SET®
 WORLDWIDE
 5119 Catlett Rd. • Midland, VA 22728 • info@EasiSet.com
 www.EasiSet.com • 800-547-4045 • Fax 540-439-2541

DATE	DESCRIPTION	REV	INI.
-	-	1	-
-	-	2	-
-	-	3	-
-	-	4	-

PROJECT: 38'x8' EASI-SET DUGOUT
 FAIRBANKS DUGOUTS
 MILFORD CENTER, OH
 CONTRACTOR: LEVAN'S EXCAVATING, INC.

SCALE	NTS
DRAWN BY	FTL
CHECK BY	WCR
ISSUE DATE	01.07.26
PIECE MARK	WP-06

MESSAGE CENTER

- REFER TO DETAILS FOR REINFORCEMENT/CABLE PLACEMENT
- SUPPLEMENTAL STEEL FOR STRIPPING AND HANDLING MAY BE ADDED AS REQUIRED.

CHECKED BY: DATE:
 APPROVED BY: DATE:

- NOTES:
- TRIM PLASTIC SHEATH AT BOTH ENDS OF THE PT CABLE TO FIT BETWEEN U-5 ANCHOR PLATES
 - CONSTRUCT REBAR-MESH CAGE ACCORDING TO THE DRAWINGS. SECURE LIFTING APPARATUS TO FORM AND ADD PROPER REINFORCEMENT. PLACE REBAR-MESH CAGE AND HAIRPINS AT INSERTS WITH PROPER CLEARANCES (PER DRAWINGS).
 - PLACE AND SECURE PT CABLE AS INDICATED ON THE DRAWINGS (REINFORCING VIEW)

PRODUCT	SALES ORDER NUMBER
ESW BUILDING	-
SHEET NUMBER	NUMBER REQUIRED
2 OF 2	1