

Job Name: 25-3283 - Whitley County Detention Center
Job Location: Williamsburg, KY
Contractor: Rising Sun Development Company

PC: E. Bradley
 TECH: J. Horsley - F
 Plant: 100



Structure ID: DB4

Spec: Storm
 Type: STM.MH (Recessed pipe)
 Size: 48"

Rim: 1084.45'
 Invert: 1076.04'
 Rim to Invert: 8.41'

Sump: 0"
 Floor (Top): 1076.04'
 Floor Height: 6"

Floor (Bot): 1075.54'
 Overall Height: 8.75'
 Slack: 1.92"

Structure Notes:

- PER ASTM C-478 SPECIFICATIONS
- CONCRETE: 4,000 PSI AT 28 DAYS
- REINFORCEMENT:
 - FLAT LID: #4 BAR @ 10" C.C. E.W. (GRADE 60)
 - BASE & RISER: PER ASTM A615
- STEPS AT 90 DEGREES
- NO INVERT CHANNEL
- CASTING SUPPLIED BY OTHERS (HOE 525 LV SET (FRAME / GRATE / CURB HOOD))

STRUCTURE SUMMARY:

P5) 24" x 36" - CASTING HEIGHT - 6"	0 lb
P4) 24" x 36" - GRADE RING F/F - 3"	306 lb
P3) 48" - MH FLAT TOP w/24"x36" Hole F/G - 12"	1300 lb
P2) 48" - MH RISER T/G - 36"	2515 lb
P1) 48" - MH BASE T/n - 42"	4131 lb
2) 48" - Conseal CS-102 1.00"	0 lb
2) 24" x 36" - Conseal CS-102 1.00"	0 lb
1) Hole - 16	0 lb
1) Hole - 12	0 lb
7) MH Step ML-10-TDS-NCR - 10"	0 lb
Structure Total:	8252 lb

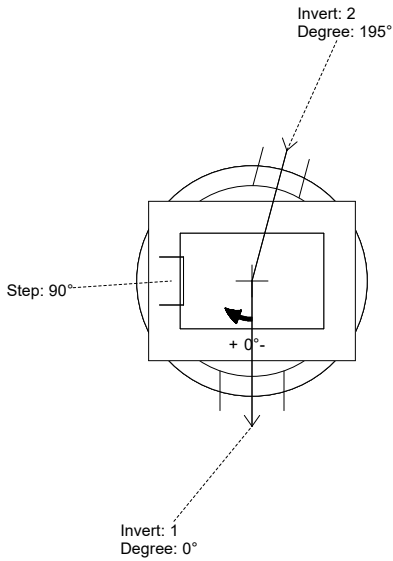

Position	Elev	Angle	Pipe	Pipe OD	Hole	Connector	Up (L)	Ref
Rim	1084.45'							
Reducer								
Invert 1	1076.04'	0°	12" HDPE	14.5"	16"	Hole 16	-1.25"	P1
Invert 2	1076.74'	195°	8" HDPE	9.1"	12"	Hole 12	7.85"	P1
Invert 3								
Invert 4								
Invert 5								
Invert 6								
Invert 7								
Invert 8								

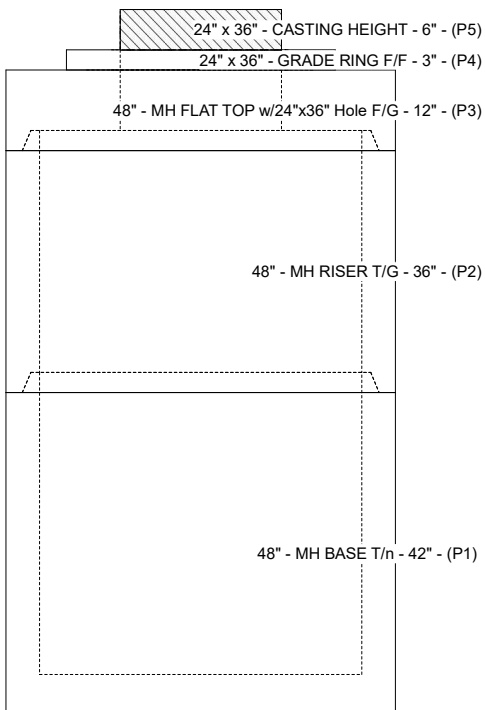

Cast (Int. Dim.) - Interior Dimensions

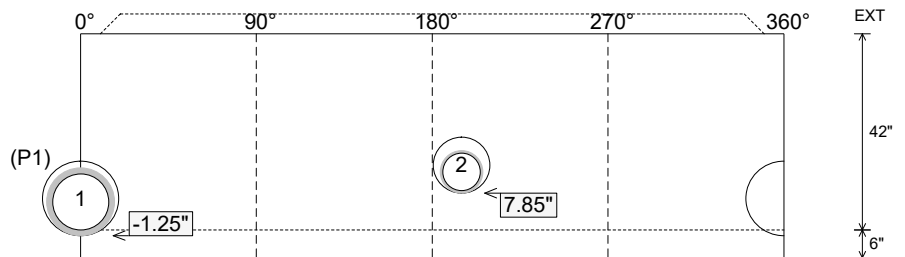

Submittal Drawing
 12/17/2025 7:50:04 AM

SUBMITTAL
 APPROVED BY: