

Job Name: 25-3175 - MSU MDAB  
 Job Location: Morehead, KY 40351  
 Contractor: Rising Sun Development Company

Plant: Beaver Dam, KY  
 10/28/2025 8:31:03 PM

Tech: K. Cardwell  
 PC: J. Jarvis



**Structure ID: MH3**

**P3 MH048CN42**

**ECC CONE w/ 24" HOLE F/G**

- P5) 24" - CASTING HEIGHT - 7"
- P4) 24" - GRADE RING F/F - 3"
- P3) 48" - ECC CONE w/ 24" HOLE F/G - 42"
- P2) 48" - MH RISER T/G - 36"
- P1) 48" - MH BASE T/n - 48"
- 2) 48" - Conseal CS-102 1.00"
- 1) Hole - 20
- 1) Hole - 16
- 11) MH Step ML-10-TDS-NCR - 10"

- 0 lb
- 202 lb
- 3200 lb
- 2515 lb
- 4462 lb
- 0 lb
- 0 lb
- 0 lb
- 0 lb
- 
- Structure Total: 10380 lb

Structure Notes:  
 PLAN LABEL: MH-3A  
 1. PER ASTM C-478 SPECS  
 2. CONCRETE: 4,000 PSI AT 28 DAYS  
 3. REINFORCEMENT: PER ASTM A615  
 4. STEPS AT 100 DEGREES  
 5. 7" CASTING SUPPLIED BY OTHERS

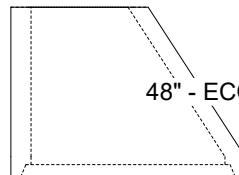
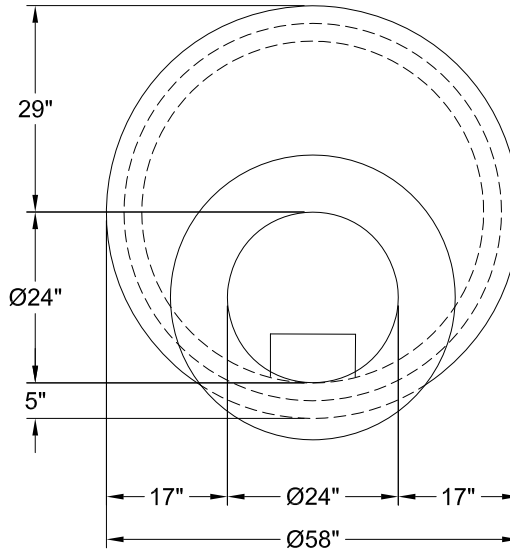

48" - ECC CONE w/ 24" HOLE F/G - 42" - (P3)

Coating (Int):  
 Coating (Ext):

Seam Up: Flat  
 Seam Dn: Groove

Wall Thickness: 5"

Height (Ext): 42"

Weight (Net): 3200 lb  
 Volume (Net): 0.5cu.yd