

Job Name: 25-3118 - W6 Ph 2-C Force Main Improvements  
 Job Location: Fort Mitchell, KY 41017  
 Contractor: Lykins Contracting

Plant: 100

Tech: J. Horsley - A

3/27/2026 11:41:37 AM

PC: Celina Goff



**Structure ID: 2301581**

**P5 MH048CCN36**

**CON CONE w/24" HOLE F/G**

- P6) 24" - CASTING HEIGHT - 7"
- P5) 48" - CON CONE w/24" HOLE F/G - 36"
- P4) 48" - MH RISER T/G - 48"
- P3) 48" - MH RISER T/G - 48"
- P2) 48" - MH RISER w/DROP Custom Ht T/G - 72"
- P1) 48" - MH BASE (10"F) w/DROP Custom Ht T/n - 28"
- 1) 60" - MH INVERT CHANNEL - FULL HEIGHT
- 4) 48" - Conseal CS-102 1.00" (Double)
- 1) PSX - 12-08 NYLO
- 1) Drop Tee - 8" PVC
- 1) Drop Elbow - 8" PVC
- 19) MH Step ML-10-TDS-NCR - 10"

0 lb  
 2252 lb  
 3353 lb  
 3353 lb  
 8102 lb  
 7371 lb  
 2692 lb  
 0 lb  
 8 lb  
 0 lb  
 0 lb  
 0 lb  
 0 lb

- Structure Notes:
1. PER ASTM C-478 SPECIFICATIONS
  2. CONCRETE: 4,000 PSI AT 28 DAYS
  3. REINFORCEMENT: PER ASTM A615
  4. STEPS REQUIRED
  5. 7" CASTING SUPPLIED BY OTHERS

Structure Total: 27131 lb

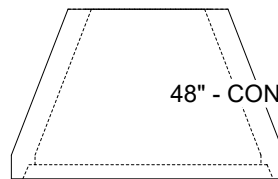
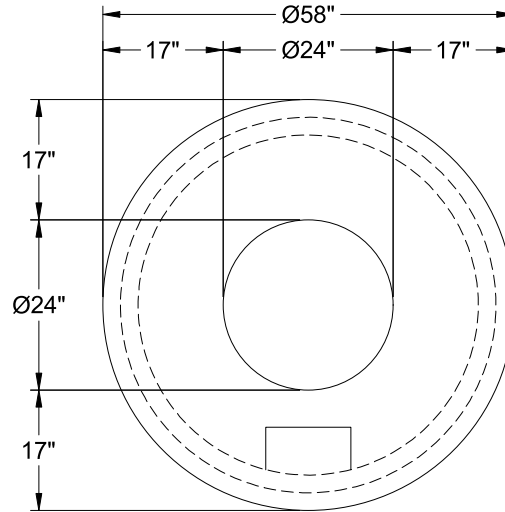

48" - CON CONE w/24" HOLE F/G - 36" - (P5)

Coating (Int):  
 Coating (Ext):

Seam Up: Flat  
 Seam Dn: Groove

Wall Thickness: 5"

Height (Ext): 36"

Weight (Net): 2252 lb  
 Volume (Net): 0.57cu.yd