

Job Name: 25-3118 - W6 Ph 2-C Force Main Improvements	Plant: 100	Tech: J. Horsley - A	
Job Location: Fort Mitchell, KY 41017	3/20/2026 1:22:17 PM	PC: Celina Goff	
Contractor: Lykins Contracting			

Structure ID: 2301574

P1 MH060BAVF

MH BASE Custom Ht T/n

P4) 24" - CASTING HEIGHT - 7"	0 lb
P3) 60" - MH FLAT TOP w/ 24" ECC Hole F/G - 13"	2869 lb
P2) 60" - MH RISER T/G - 72"	7516 lb
P1) 60" - MH BASE Custom Ht T/n - 40"	6649 lb
1) 60" - MH INVERT CHANNEL - FULL HEIGHT	2692 lb
2) 60" - Conseal CS-102 1.00" (Double)	0 lb
2) Kor-N-Seal2 - S206-18L	12 lb
9) MH Step ML-10-TDS-NCR - 10"	0 lb
Structure Total:	19739 lb

Structure Notes:

- PER ASTM C-478 SPECIFICATIONS
- CONCRETE: 4,000 PSI AT 28 DAYS
- REINFORCEMENT:
 - WALLS: PER ASTM A615 - DOUBLE MAT
 - FLOOR: #5 BAR @ 12" C.C. E.W. (GRADE 60) - 2" MIN. REBAR CLEARANCE (TYP)
- INVERT CHANNEL REQUIRED
- STEPS AT 90 DEGREES
- 7" CASTING SUPPLIED BY OTHERS

Rim: 739.51' Rim to Invert: 10.98' Slack: 1.76" Sump: 2" Step Position: 90°

Position	Elev	Angle	Ext. (cw)	Pipe	Pipe OD	Connector	Hole	Horz Size	Up ()	Offset
Invert 1	728.53'	0°	0"	15" PVC SDR35	15.3"	Kor-N-Seal2 S206-18L	18"	18.282"	0.5"	0"
Invert 2	728.63'	198°	124.375"	15" PVC SDR35	15.3"	Kor-N-Seal2 S206-18L	18"	18.282"	1.75"	0"
Invert 3										
Invert 4										
Invert 5										
Invert 6										
Invert 7										
Invert 8										

RIGHT-SIDE UP VIEW (int. dimensions)

UPSIDE-DOWN VIEW (int. dimenions)

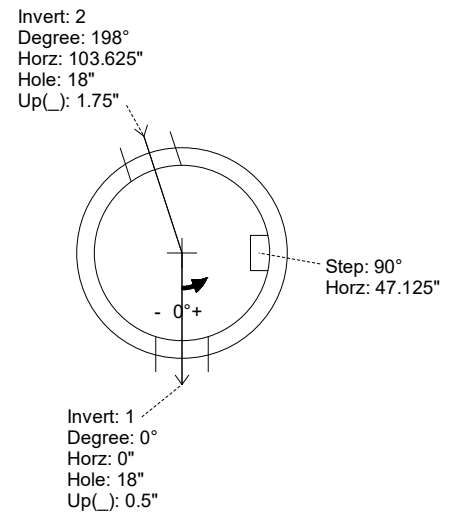
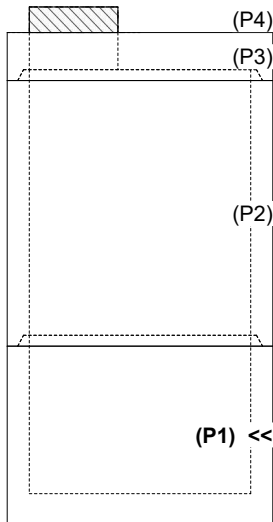

INSIDE WALL DIMENSIONS

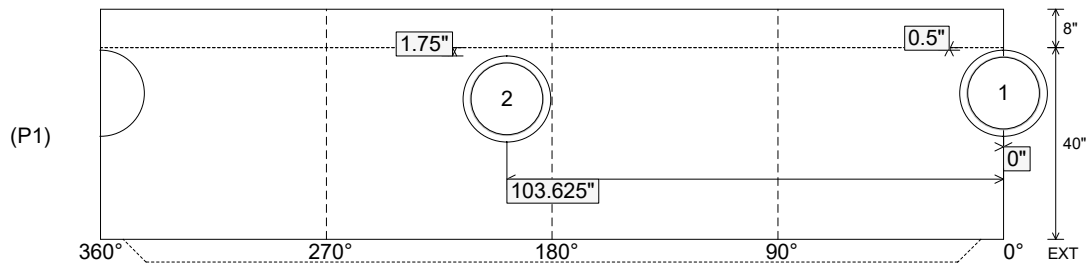

Coating (Int):	Seam Up: Tongue	Wall Thickness: 6"	Height (Int): 40"	Weight (Net): 6649 lb
Coating (Ext):	Seam Dn: n/a	Floor Height: 8"	Height (Ext): 48"	Volume (Net): 1.7cu.yd

Job Name: 25-3118 - W6 Ph 2-C Force Main Improvements
 Job Location: Fort Mitchell, KY 41017
 Contractor: Lykins Contracting

Plant: 100

3/20/2026 1:22:17 PM

Tech: J. Horsley - A

PC: Celina Goff



Structure ID: 2301574

P1 MH060BAVF

MH BASE Custom Ht T/n

- P4) 24" - CASTING HEIGHT - 7"
- P3) 60" - MH FLAT TOP w/ 24" ECC Hole F/G - 13"
- P2) 60" - MH RISER T/G - 72"
- P1) 60" - MH BASE Custom Ht T/n - 40"
- 1) 60" - MH INVERT CHANNEL - FULL HEIGHT
- 2) 60" - Conseal CS-102 1.00" (Double)
- 2) Kor-N-Seal2 - S206-18L
- 9) MH Step ML-10-TDS-NCR - 10"

0 lb
 2869 lb
 7516 lb
 6649 lb
 2692 lb
 0 lb
 12 lb
 0 lb

 Structure Total: 19739 lb

Structure Notes:

1. PER ASTM C-478 SPECIFICATIONS
2. CONCRETE: 4,000 PSI AT 28 DAYS
3. REINFORCEMENT:
 - WALLS: PER ASTM A615 - DOUBLE MAT
 - FLOOR: #5 BAR @ 12" C.C. E.W. (GRADE 60) - 2" MIN. REBAR CLEARANCE (TYP)
4. INVERT CHANNEL REQUIRED
5. STEPS AT 90 DEGREES
6. 7" CASTING SUPPLIED BY OTHERS

Rim: 739.51' Rim to Invert: 10.98' Slack: 1.76" Sump: 2" Step Position: 90°

Position	Elev	Angle	Ext. (cw)	Pipe	Pipe OD	Connector	Hole	Horz Size	Up ()	Offset
Invert 1	728.53'	0°	0"	15" PVC SDR35	15.3"	Kor-N-Seal2 S206-18L	18"	18.282"	0.5"	0"
Invert 2	728.63'	198°	124.375"	15" PVC SDR35	15.3"	Kor-N-Seal2 S206-18L	18"	18.282"	1.75"	0"
Invert 3										
Invert 4										
Invert 5										
Invert 6										
Invert 7										
Invert 8										

RIGHT-SIDE UP VIEW (int. dimensions)

UPSIDE-DOWN VIEW (int. dimenions)

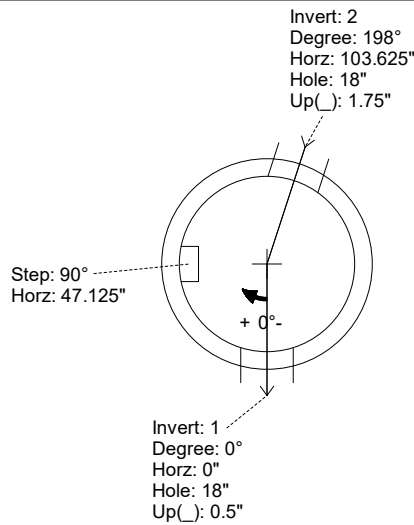
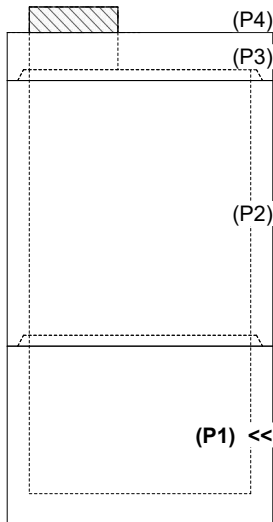

INVERT CHANNEL DRAWING

INSIDE WALL DIMENSIONS

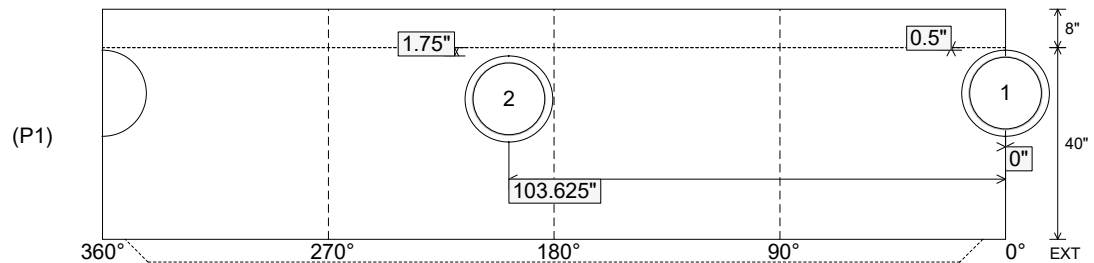

Coating (Int):
 Coating (Ext):

Seam Up: Tongue
 Seam Dn: n/a

Wall Thickness: 6"
 Floor Height: 8"

Height (Int): 40"
 Height (Ext): 48"

Weight (Net): 6649 lb
 Volume (Net): 1.7cu.yd