

Job Name: 25-3118 - W6 Ph 2-C Force Main Improvements
 Job Location: Fort Mitchell, KY 41017
 Contractor: Lykins Contracting

Plant: 100

Tech: J. Horsley - A

3/26/2026 2:14:32 PM

PC: Celina Goff



Structure ID: 2301540

P2 MH060R60

MH RISER w/DROP T/G

- P7) 24" - CASTING HEIGHT - 7" 0 lb
- P6) 24" - GRADE RING F/F - 6" 405 lb
- P5) 48" - CON CONE w/24" HOLE F/G - 24" 2252 lb
- P4) 48" - MH RISER T/G - 48" 3353 lb
- P3) 60" - MH Transition Slab 48" Hole T/G - 15" 2204 lb
- P2) 60" - MH RISER w/DROP T/G - 60" 6235 lb
- P1) 60" - MH BASE (10"F) w/DROP Custom Ht T/n - 60" 11306 lb
- 1) 60" - MH INVERT CHANNEL - FULL HEIGHT 2692 lb
- 1) SECONDARY POUR - Add Exterior Drop to Base (P1) 3010 lb
- 1) SECONDARY POUR - Add Exterior Drop to Riser (P2) 2580 lb
- 2) 60" - Conseal CS-102 1.00" (Double) 0 lb
- 2) 48" - Conseal CS-102 1.00" (Double) 0 lb
- 2) A-Lok - 1235 2 lb
- 1) Drop Tee - 8" PVC 0 lb
- 1) Drop Elbow - 8" PVC 0 lb
- 16) MH Step ML-10-TDS-NCR - 10" 0 lb

Structure Notes:

1. PER ASTM C-478 SPECIFICATIONS
2. CONCRETE: 4,000 PSI AT 28 DAYS
3. REINFORCEMENT: PER ASTM A615
4. STEPS AT 90 DEGREES
5. 7" CASTING SUPPLIED BY OTHERS
6. EXTERIOR DROP AT INVERTS 3 & 4 SUPPLIED BY ICAST

Structure Total: 34039 lb

FIRST POUR (RISER): 6,235 LBS
SECOND POUR (DROP): 2,580 LBS

Rim: 751.8' Rim to Invert: 18.21' Slack: 1.52" Sump: 3" Step Position: 90°

Position	Elev	Angle	Ext. (cw)	Pipe	Pipe OD	Connector	Hole	Horz Size	Up ()	Offset
Invert 1										
Invert 2										
Invert 3	741.41'	266°	167.125"	8" PVC SDR35	8.5"	Drop Tee 8" PVC	8.5"	8.529"	31.875"	0"
Invert 4										
Invert 5										
Invert 6										
Invert 7										
Invert 8										

RIGHT-SIDE UP VIEW (int. dimensions)

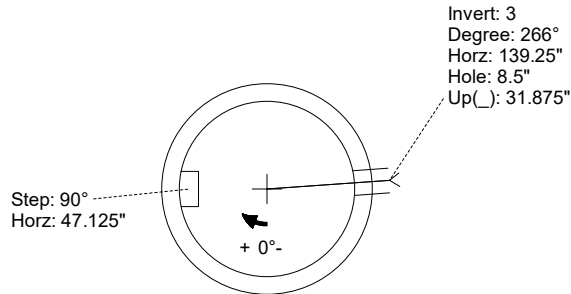
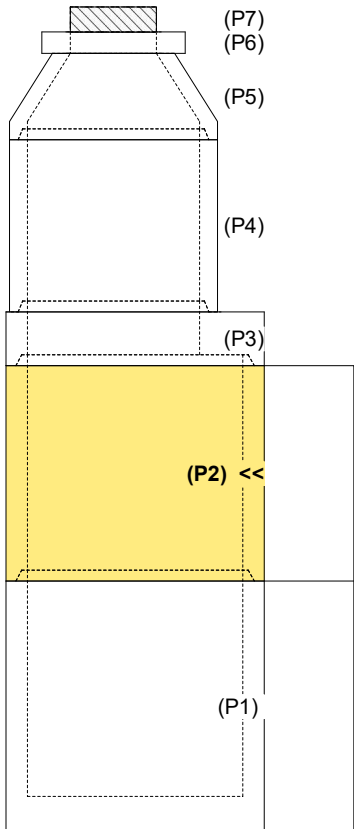

INSIDE WALL DIMENSIONS

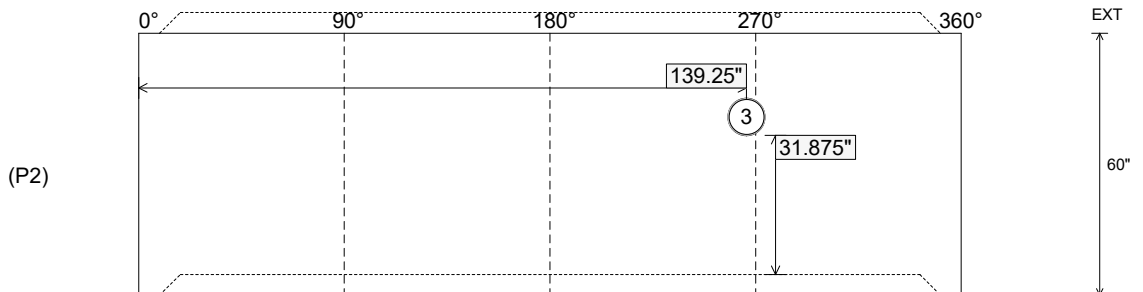

Coating (Int):
Coating (Ext):

Seam Up: Tongue
Seam Dn: Groove

Wall Thickness: 6"
Floor Height: 0"

Height (Int): 60"
Height (Ext): 60"

Weight (Net): 6235 lb
Volume (Net): 1.59cu.yd

Job Name: 25-3118 - W6 Ph 2-C Force Main Improvements
 Job Location: Fort Mitchell, KY 41017
 Contractor: Lykins Contracting

Plant: 100

Tech: J. Horsley - A

3/26/2026 2:14:32 PM

PC: Celina Goff



Structure ID: 2301540

P2 MH060R60

MH RISER w/DROP T/G

- P7) 24" - CASTING HEIGHT - 7"
- P6) 24" - GRADE RING F/F - 6"
- P5) 48" - CON CONE w/24" HOLE F/G - 24"
- P4) 48" - MH RISER T/G - 48"
- P3) 60" - MH Transition Slab 48" Hole T/G - 15"
- P2) 60" - MH RISER w/DROP T/G - 60"
- P1) 60" - MH BASE (10"F) w/DROP Custom Ht T/n - 60"
- 1) 60" - MH INVERT CHANNEL - FULL HEIGHT
- 1) SECONDARY POUR - Add Exterior Drop to Base (P1)
- 1) SECONDARY POUR - Add Exterior Drop to Riser (P2)
- 2) 60" - Conseal CS-102 1.00" (Double)
- 2) 48" - Conseal CS-102 1.00" (Double)
- 2) A-Lok - 1235
- 1) Drop Tee - 8" PVC
- 1) Drop Elbow - 8" PVC
- 16) MH Step ML-10-TDS-NCR - 10"

- 0 lb
- 405 lb
- 2252 lb
- 3353 lb
- 2204 lb
- 6235 lb
- 11306 lb
- 2692 lb
- 3010 lb
- 2580 lb
- 0 lb
- 0 lb
- 2 lb
- 0 lb
- 0 lb
- 0 lb
- 0 lb
- Structure Total: 34039 lb

Structure Notes:

1. PER ASTM C-478 SPECIFICATIONS
2. CONCRETE: 4,000 PSI AT 28 DAYS
3. EXTERIOR DROP REINFORCEMENT: DRILL & STUB #4 BAR @ 12" C.C. E.W. (GRADE 60) - 2" MIN. REBAR CLEARANCE (TYP)
4. STEPS AT 90 DEGREES
5. 7" CASTING SUPPLIED BY OTHERS
6. EXTERIOR DROP AT INVERTS 3 & 4 SUPPLIED BY ICAST
7. ADD 8" SDR 35 DROP & TEE AT INVERT 3 (266°)

FIRST POUR (RISER): 6,235 LBS

SECOND POUR (DROP): 2,580 LBS

Rim: 751.8' Rim to Invert: 18.21' Slack: 1.52" Sump: 3" Step Position: 90°

Position	Elev	Angle	Ext. (cw)	Pipe	Pipe OD	Connector	Hole	Horz Size	Up ()	Offset
Invert 1										
Invert 2										
Invert 3	741.41'	266°	167.125"	8" PVC SDR35	8.5"	Drop Tee 8" PVC	8.5"	8.529"	31.875"	0"
Invert 4										
Invert 5										
Invert 6										
Invert 7										
Invert 8										

RIGHT-SIDE UP VIEW (int. dimensions)

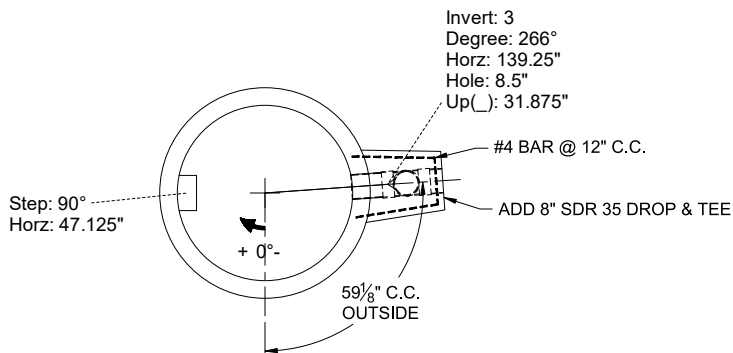
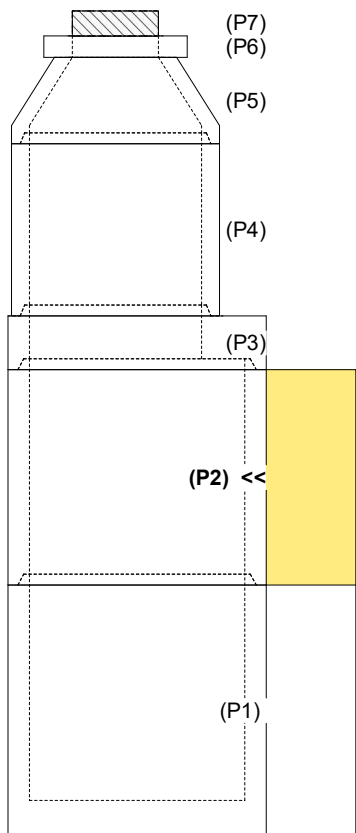

INSIDE WALL DIMENSIONS

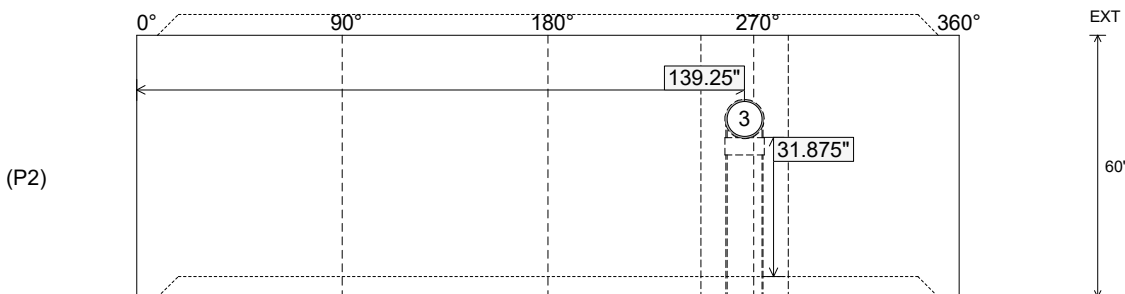

Coating (Int):
Coating (Ext):

Seam Up: Tongue
Seam Dn: Groove

Wall Thickness: 6"
Floor Height: 0"

Height (Int): 60"
Height (Ext): 60"

Weight (Net): 6235 lb
Volume (Net): 1.59cu.yd