

Job Name: 25-3118 - W6 Ph 2-C Force Main Improvements
 Job Location: Fort Mitchell, KY 41017
 Contractor: Lykins Contracting

Plant: 100

Tech: J. Horsley - A

3/26/2026 2:15:43 PM

PC: Celina Goff



Structure ID: 2280813

P2 MH048RS72S

MH RISER SPECIAL T/G

- P6) 24" - CASTING HEIGHT - 7"
- P5) 24" - GRADE RING F/F - 4"
- P4) 48" - CON CONE w/24" HOLE F/G - 24"
- P3) 48" - MH RISER T/G - 24"
- P2) 48" - MH RISER SPECIAL T/G - 72"
- P1) 48" - MH BASE T/n - 54"
- 1) 48" - MH INVERT CHANNEL - FULL HEIGHT
- 3) 48" - Conseal CS-102 1.00" (Double)
- 3) Kor-N-Seal2 - S206-28
- 12) MH Step ML-10-TDS-NCR - 10"

0 lb
 270 lb
 2252 lb
 1677 lb
 4757 lb
 4557 lb
 1440 lb
 0 lb
 20 lb
 0 lb

 Structure Total: 14972 lb

- Structure Notes:**
1. PER ASTM C-478 SPECIFICATIONS
 2. CONCRETE: 4,000 PSI AT 28 DAYS
 3. REINFORCEMENT: PER ASTM A615
 4. STEPS AT 90 DEGREES
 5. 7" CASTING SUPPLIED BY OTHERS

Rim: 762.91' Rim to Invert: 15.44' Slack: 2.59' Sump: 2.309' Step Position: 90°

Position	Elev	Angle	Ext. (cw)	Pipe	Pipe OD	Connector	Hole	Horz Size	Up ()	Offset
Invert 1										
Invert 2	753.66'	188°	95.125"	24" PVC SDR35/F679	24.803"	Kor-N-Seal2 S206-28	28"	29.896"	16"	0"
Invert 3										
Invert 4										
Invert 5										
Invert 6										
Invert 7										
Invert 8										

RIGHT-SIDE UP VIEW (int. dimensions)

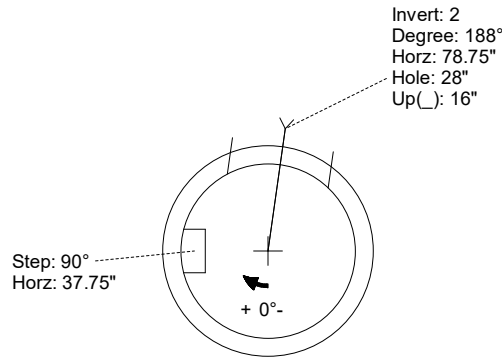
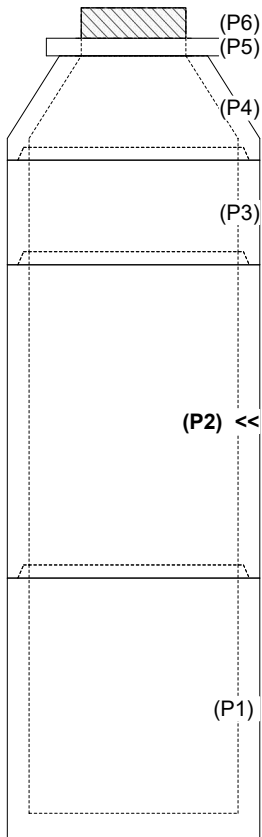

INSIDE WALL DIMENSIONS

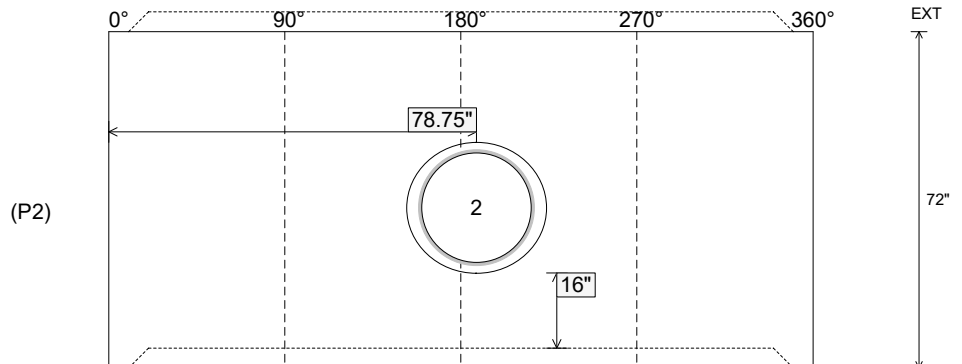

Coating (Int):
 Coating (Ext):

Seam Up: Tongue
 Seam Dn: Groove

Wall Thickness: 5"
 Floor Height: 0"

Height (Int): 72"
 Height (Ext): 72"

Weight (Net): 4757 lb
 Volume (Net): 1.22cu.yd